

Christine

ORDINANCE NO. G-350  
 AN ORDINANCE OF THE BOARD OF SUPERVISORS OF THE COUNTY OF KERN, CALIFORNIA, TO AMEND THE ZONING MAP OF SECTION 2, CHAPTER 1, DIVISION 1, PART 1 OF THE ORDINANCE RELATIVE TO ZONING MAP NO. 6.

13) days from the passage thereof shall be published once in the best general circulation published and printed in the County of Kern, State of California, together with the names of the members of the Board of Supervisors and their names and addresses in the Ordinance.

ZONING MAP NO. 6  
 OF KERN COUNTY, CALIFORNIA  
 AS AMENDED BY ORDINANCE NO. G-350

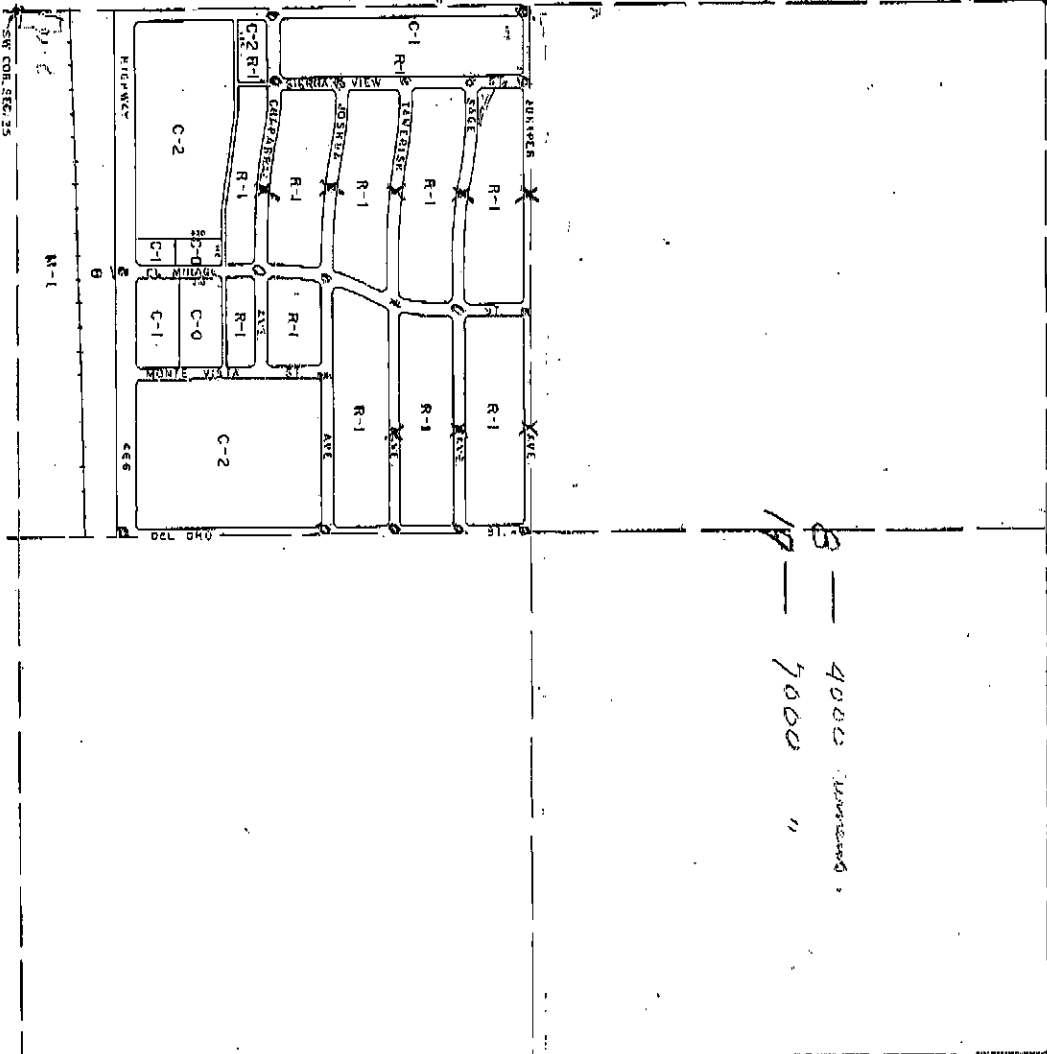

# ZONING MAP #6

(SEC. 72976 OF THE ORDINANCE CODE OF KERN COUNTY)  
 PDR. OF SEC. 35 T11N, R8W, S18, 8, M. (BOR)  
 KERN COUNTY CALIFORNIA

- LEGEND**
- R-1 ONE-FAMILY DWELLING ZONE
  - R-2 TWO-FAMILY DWELLING ZONE
  - R-3 LIMITED MULTIPLE-FAMILY DWELLING ZONE
  - R-4 MULTIPLE-FAMILY DWELLING ZONE
  - R-5 SUBURBAN RESIDENTIAL ZONE
  - E-1 ESTATE ZONE
  - E-2 ESTATE ZONE
  - E-3 ESTATE ZONE
  - C-0 PROFESSIONAL OFFICE ZONE
  - C-1 NEIGHBORHOOD COMMERCIAL ZONE
  - C-2 COMMERCIAL ZONE
  - M-1 LIMITED MANUFACTURING ZONE
  - M-2 LIGHT MANUFACTURING ZONE
  - M-3 GENERAL MANUFACTURING ZONE
  - A-1 LIGHT AGRICULTURAL ZONE
  - A-2 GENERAL AGRICULTURAL ZONE
  - R-F RECREATIONAL-FORESTRY ZONE
  - U UNCLASSIFIED ZONE
  - P AUTOMOBILE PARKING ZONE
  - D ARCHITECTURAL DESIGN ZONE
  - A APPROXIMATE APPROACH HEIGHT ZONE
  - B BUFFER ZONE

WE HEREBY CERTIFY THAT THIS OFFICIAL ZONING MAP WAS ADOPTED IN THIS FORM BY RESOLUTION OF THE BOARD OF SUPERVISORS OF THE COUNTY OF KERN, STATE OF CALIFORNIA, AT A REGULAR MEETING THEREOF HELD ON THE 7TH DAY OF APRIL, 1928.

*Richard D. Blagden*  
 SECRETARY

WE HEREBY CERTIFY THAT THIS OFFICIAL ZONING MAP WAS ADOPTED AS AN AMENDMENT TO THE OFFICIAL LAND USE ZONING ORDINANCE OF THE COUNTY OF KERN, BY THE BOARD OF SUPERVISORS OF THE COUNTY OF KERN, STATE OF CALIFORNIA, AT A REGULAR MEETING HELD ON THE 20th DAY OF MAY, 1959, BY AN ORDINANCE PASSED BY SAID BOARD.

*W. R. Woodlomas*  
 CHAIRMAN OF THE BOARD

*W. R. Woodlomas*  
 CLERK