

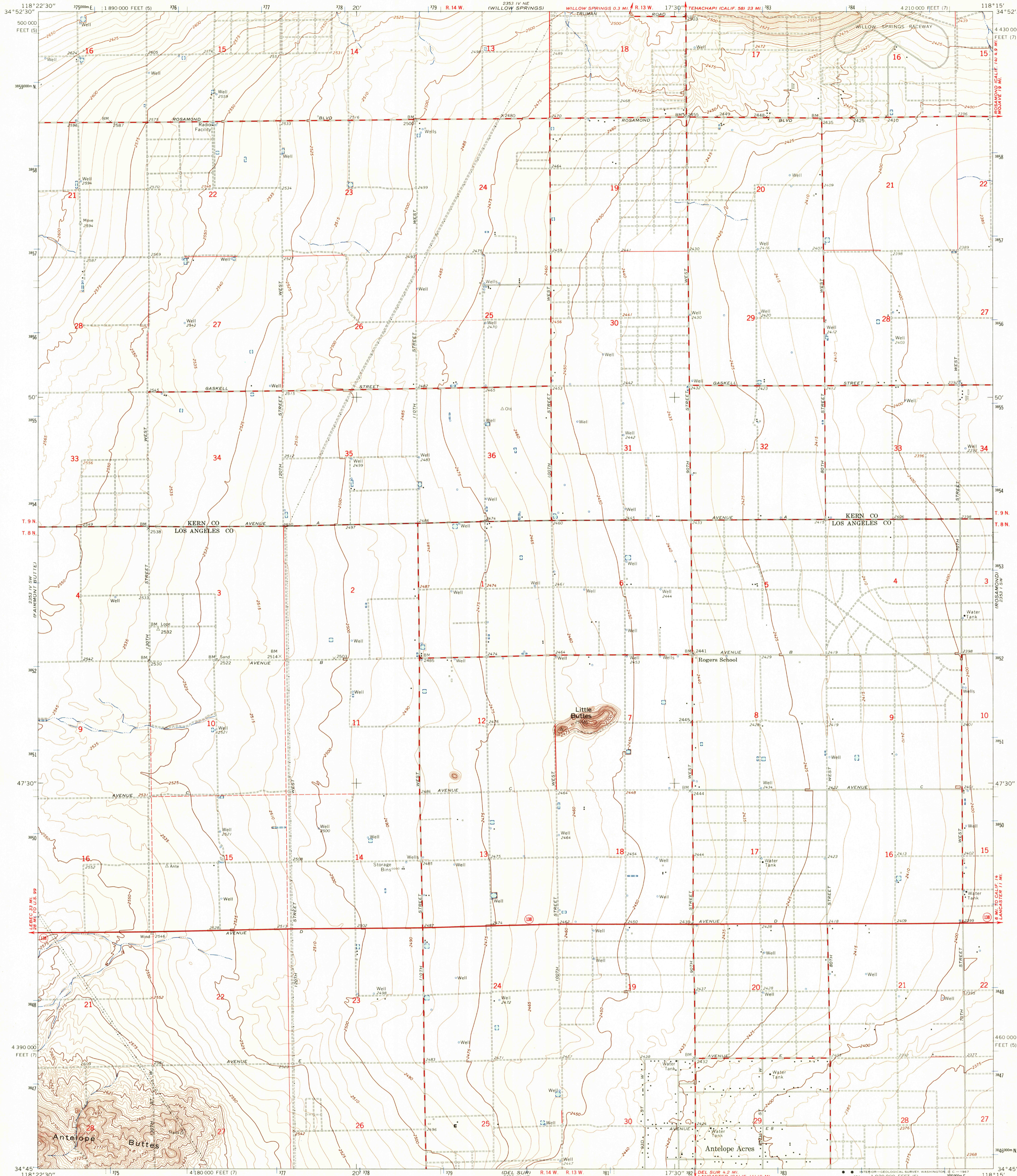

Attachment D

USGS Topographic Map of Little Buttes 7.5-minute Quadrangle



Mapped, edited, and published by the Geological Survey
Control by USGS and USC&GS
Topography by photogrammetric methods from aerial
photographs taken 1963. Field checked 1965
Polyconic projection. 1927 North American datum
10,000-foot grids based on California coordinate system,
zones 7 and 5
1,000-meter Universal Transverse Mercator grid ticks,
zone 11, shown in blue
Supersedes portions of Little Buttes and Esperanza School
6-minute maps dated 1950
Fine red dashed lines indicate selected fence lines

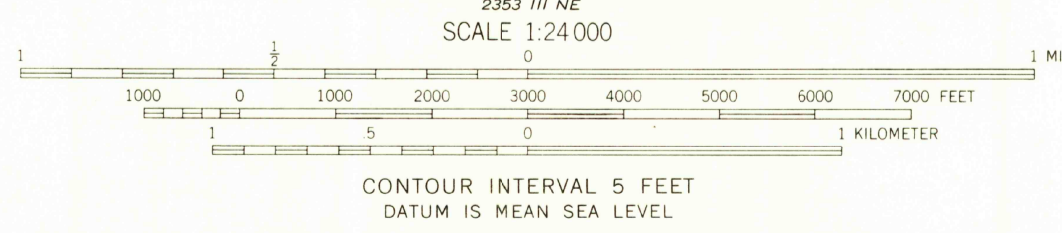
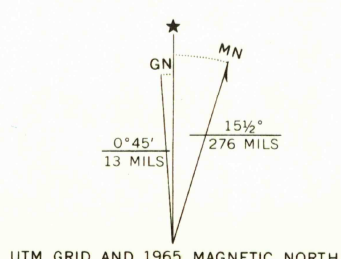

USGS
Historical File
Topographic Division

ROAD CLASSIFICATION

- Heavy duty
- Medium duty
- Light duty
- Unimproved dirt

State Route



U.S.G.S.
LITTLE BUTTES, CALIF.
SE/4 WILLOW SPRINGS 15' QUADRANGLE
N3445-W11815/7.5
1965
AMS 2353 IV SE-SERIES V895

THIS MAP COMPLIES WITH NATIONAL MAP ACCURACY STANDARDS
FOR SALE BY U. S. GEOLOGICAL SURVEY, DENVER, COLORADO 80225, OR WASHINGTON, D. C. 20242
A FOLDER DESCRIBING TOPOGRAPHIC MAPS AND SYMBOLS IS AVAILABLE ON REQUEST

3235
MAR 28 1967