

1  
2  
3  
4  
5  
6  
7  
8  
9  
10  
11  
12  
13  
14  
15  
16  
17  
18  
19  
20  
21  
22  
23  
24  
25  
26  
27

**ANTELOPE PARK MUTUAL WATER COMPANY**

**Attachment I.3.b.i.**

GRESHAM | SAVAGE  
ATTORNEYS AT LAW  
3750 UNIVERSITY AVE.  
STE. 250  
RIVERSIDE, CA 92501-3335  
(951) 684-2171

2010

## ANNUAL PROPERTY TAX BILL

2010

CITIES, COUNTY, SCHOOLS AND ALL OTHER TAXING AGENCIES IN LOS ANGELES COUNTY  
SECURED PROPERTY TAX FOR FISCAL YEAR JULY 1, 2010 TO JUNE 30, 2011

MARK J. SALADINO, TREASURER AND TAX COLLECTOR

FOR ASSISTANCE CALL 1 (213) 974-2111 OR 1 (888) 807-2111, ON THE WEB AT [www.lacountypropertytax.com](http://www.lacountypropertytax.com)

ASSESSOR'S ID. NO.

CK

DETAIL OF TAXES DUE FOR 3125 008 018 10 000 78

## PROPERTY IDENTIFICATION

ASSESSOR'S ID. NO.: 3125 008 018 10 000

OWNER OF RECORD AS OF JANUARY 1, 2010

SAME AS BELOW

## MAILING ADDRESS

ANTELOPE PARK MUTUAL WATER CO  
PO BOX 1712  
LANCASTER CA 93534-1712

AGENCY	AGENCY PHONE NO.	RATE	AMOUNT
GENERAL TAX LEVY			
ALL AGENCIES		1.000000 \$	77.40
VOTED INDEBTEDNESS			
SPECIAL WATER		.070490 \$	5.46
COMMNTY COLLEGE		.025386	1.96
HIGH SCHOOLS		.029017	2.24
ELEM SCHOOLS		.030613	2.37
DIRECT ASSESSMENTS			
ANTELOPE MOSQ AB	(888) 802-1805	\$	6.59
WATER STANDBY 40	(626) 300-3343		10.00
LIGHT MAINT DIST	(661) 723-6183		169.09
LNCSTR SWR SYSTM	(661) 723-6183		390.00
TRAUMA/EMERG SRV	(866) 587-2862		7.18
LA CO FIRE DEPT	(323) 881-6151		67.98

## ELECTRONIC FUND TRANSFER (EFT) NUMBER

For American Express, Mastercard and Visa payments call 1 (888) 473-0835  
and have available the EFT number listed above. Service fees will be charged.

## SPECIAL INFORMATION

Paid  
10/20/10  
Ch # 5452

## PROPERTY LOCATION AND/OR PROPERTY DESCRIPTION

1721 W AVENUE K8 LANCASTER  
TRACT NO 14728 W 100 FT EX OF ST OF  
LOT 152

TOTAL TAXES DUE	\$740.27
FIRST INSTALLMENT TAXES DUE NOV. 1, 2010	\$370.14
SECOND INSTALLMENT TAXES DUE FEB. 1, 2011	\$370.13

## VALUATION INFORMATION

ROLL YEAR 10-11	CURRENT ASSESSED VALUE	TAXABLE VALUE
LAND	6,054	6,054
IMPROVEMENTS	1,686	1,686

## ASSESSOR'S REGIONAL OFFICE

REGION #A1 INDEX: TRA:05438  
LANCASTER OFFICE  
251 E AVE K-6  
LANCASTER CA 93535  
(661)940-6700

ACCT. NO.: PRINT NO.:1480535 BILL ID.:

TOTAL	7,740
LESS EXEMPTION:	
NET TAXABLE VALUE	7,740

ANY RETURNED PAYMENT MAYBE SUBJECT TO A FEE UP TO \$50.00.  
KEEP THIS UPPER PORTION FOR YOUR RECORDS. YOUR CANCELLED CHECK IS YOUR RECEIPT.

2010

## ANNUAL PROPERTY TAX BILL

2010

CITIES, COUNTY, SCHOOLS AND ALL OTHER TAXING AGENCIES IN LOS ANGELES COUNTY  
SECURED PROPERTY TAX FOR FISCAL YEAR JULY 1, 2010 TO JUNE 30, 2011

MARK J. SALADINO, TREASURER AND TAX COLLECTOR

FOR ASSISTANCE CALL 1 (213) 974-2111 OR 1 (888) 807-2111, ON THE WEB AT [www.lacountypropertytax.com](http://www.lacountypropertytax.com)

ASSESSOR'S ID. NO.

CK

DETAIL OF TAXES DUE FOR 8920 851 061 10 000 28

## PROPERTY IDENTIFICATION

ASSESSOR'S ID. NO.: 8920 851 061 10 000

OWNER OF RECORD AS OF JANUARY 1, 2010

SAME AS BELOW

## MAILING ADDRESS

ANTELOPE PARK MUTUAL WATER CO  
P O BOX 1712  
LANCASTER CA 93534

AGENCY	AGENCY PHONE NO.	RATE	AMOUNT
GENERAL TAX LEVY			
ALL AGENCIES		1.000000 \$	1,347.90
VOTED INDEBTEDNESS			
SPECIAL WATER		.070490 \$	95.01
COMMUNITY COLLEGE		.025386	34.22
HIGH SCHOOLS		.029017	39.11
ELEM SCHOOLS		.030613	41.26

## ELECTRONIC FUND TRANSFER (EFT) NUMBER

For American Express, Mastercard and Visa payments call 1 (888) 473-0835  
and have available the EFT number listed above. Service fees will be charged.

## SPECIAL INFORMATION

Paid 10/20/10  
Cr # 5452

## PROPERTY LOCATION AND/OR PROPERTY DESCRIPTION

WATER DISTRIBUTION SYSTEM

IMPS NOT A LIEN ON LAND ON WHICH

SUCH IMPS ARE LOCATED

## ASSESSOR'S REGIONAL OFFICE

REGION #30 INDEX: TRA:05844  
NATURAL RESOURCES  
500 W TEMPLE STREET RM. 183  
LOS ANGELES CA 90012  
(213)974-3108

ACCT. NO.: PRINT NO.:1479835 BILL ID.:

## TOTAL TAXES DUE

\$1,557.50

FIRST INSTALLMENT TAXES DUE NOV. 1, 2010

\$778.75

SECOND INSTALLMENT TAXES DUE FEB. 1, 2011

\$778.75

## VALUATION INFORMATION

ROLL YEAR 10-11	CURRENT ASSESSED VALUE	TAXABLE VALUE
-----------------	------------------------	---------------

LAND

IMPROVEMENTS

134,790

134,790

TOTAL

134,790

LESS EXEMPTION:

NET TAXABLE VALUE

134,790

ANY RETURNED PAYMENT MAYBE SUBJECT TO A FEE UP TO \$50.00.  
KEEP THIS UPPER PORTION FOR YOUR RECORDS. YOUR CANCELLED CHECK IS YOUR RECEIPT.

CITIES, COUNTY, SCHOOLS AND ALL OTHER TAXING AGENCIES IN LOS ANGELES COUNTY  
**SECURED PROPERTY TAX FOR FISCAL YEAR JULY 1, 2010 TO JUNE 30, 2011**

MARK J. SALADINO, TREASURER AND TAX COLLECTOR

FOR ASSISTANCE CALL 1 (213) 974-2111 OR 1 (888) 807-2111, ON THE WEB AT [www.lacountypropertytax.com](http://www.lacountypropertytax.com)

ASSESSOR'S ID. NO.

CK

DETAIL OF TAXES DUE FOR **8920 851 062 10 000 18**

**PROPERTY IDENTIFICATION**

ASSESSOR'S ID. NO.: 8920 851 062 10 000

OWNER OF RECORD AS OF JANUARY 1, 2010

SAME AS BELOW

**MAILING ADDRESS**

ANTELOPE PARK MUTUAL WATER CO  
P O BOX 1712  
LANCASTER CA 93534

AGENCY	AGENCY PHONE NO.	RATE	AMOUNT
GENERAL TAX LEVY			
ALL AGENCIES		1.000000 \$	485.97
VOTED INDEBTEDNESS			
SPECIAL WATER		.070490 \$	34.25
COMMNTY COLLEGE		.025386	12.34
HIGH SCHOOLS		.029017	14.10
ELEM SCHOOLS		.030613	14.88

**ELECTRONIC FUND TRANSFER (EFT) NUMBER**

For American Express, Mastercard and Visa payments call 1 (888) 473-0835  
and have available the EFT number listed above. Service fees will be charged.

**SPECIAL INFORMATION**

*Paid 10/20/10  
Ch # 5452*

**PROPERTY LOCATION AND/OR PROPERTY DESCRIPTION**

WATER DISTRIBUTION SYSTEM

IMPS NOT A LIEN ON LAND ON WHICH

SUCH IMPS ARE LOCATED

<b>TOTAL TAXES DUE</b>	<b>\$561.54</b>
<b>FIRST INSTALLMENT TAXES DUE NOV. 1, 2010</b>	<b>\$280.77</b>
<b>SECOND INSTALLMENT TAXES DUE FEB. 1, 2011</b>	<b>\$280.77</b>

**VALUATION INFORMATION**

ROLL YEAR 10-11	CURRENT ASSESSED VALUE	TAXABLE VALUE
LAND		
IMPROVEMENTS	48,597	48,597

**ASSESSOR'S REGIONAL OFFICE**

REGION #30 INDEX: TRA:05838  
NATURAL RESOURCES  
500 W TEMPLE STREET RM. 183  
LOS ANGELES CA 90012  
(213)974-3108

TOTAL	48,597
LESS EXEMPTION:	

ACCT. NO.: PRINT NO.:1479836 BILL ID.:

NET TAXABLE VALUE	48,597
-------------------	--------

ANY RETURNED PAYMENT MAYBE SUBJECT TO A FEE UP TO \$50.00.  
KEEP THIS UPPER PORTION FOR YOUR RECORDS. YOUR CANCELLED CHECK IS YOUR RECEIPT.

2008

## ANNUAL PROPERTY TAX BILL

2008

CITIES, COUNTY, SCHOOLS AND ALL OTHER TAXING AGENCIES IN LOS ANGELES COUNTY  
SECURED PROPERTY TAX FOR FISCAL YEAR JULY 1, 2008 TO JUNE 30, 2009

MARK J. SALADINO, TREASURER AND TAX COLLECTOR

FOR ASSISTANCE CALL 1 (213) 974-2111 OR 1 (888) 807-2111, ON THE WEB AT [www.lacountypropertytax.com](http://www.lacountypropertytax.com)

ASSESSOR'S ID. NO.

CK

3125 008 018 08 000 72

## DETAIL OF TAXES DUE FOR

## PROPERTY IDENTIFICATION

ASSESSOR'S ID. NO.: 3125 008 018 08 000

OWNER OF RECORD AS OF JANUARY 1, 2008

SAME AS BELOW

## MAILING ADDRESS

ANTELOPE PARK MUTUAL WATER CO  
PO BOX 1712  
LANCASTER CA 93534-1712

AGENCY	AGENCY PHONE NO.	RATE	AMOUNT
GENERAL TAX LEVY			
ALL AGENCIES		1.000000 \$	76.08
VOTED INDEBTEDNESS			
SPECIAL WATER		.070490 \$	5.36
COMMUNITY COLLEGE		.016816	1.28
HIGH SCHOOLS		.020946	1.59
ELEM SCHOOLS		.018555	1.41
DIRECT ASSESSMENTS			
ANTELOPE MOSQ AB	(866) 807-6864	\$	6.59
WATER STANDBY 40	(626) 300-3343		10.00
TRAUMA/EMERG SRV	(866) 587-2862		6.69
LA CO FIRE DEPT	(323) 881-6151		60.43
LANCASTER SWR SYSTM	(661) 723-6183		310.00
06-07 LLMD ADD	(661) 723-6183		7.56
LIGHT MAINT DIST	(661) 723-6183		161.12

## ELECTRONIC FUND TRANSFER (EFT) NUMBER

or American Express, Mastercard and Visa payments call 1 (888) 473-0835  
and have available the EFT number listed above. Service fees will be charged.

## SPECIAL INFORMATION

Paid  
10/22/08  
chk #5623 3135.48

PROPERTY LOCATION AND/OR PROPERTY DESCRIPTION  
1721 W AVENUE K8 LANCASTER  
TRACT NO 14728 W 100 FT EX OF ST OF  
LOT 152

TOTAL TAXES DUE \$648.11  
FIRST INSTALLMENT TAXES DUE NOV. 1, 2008 \$324.06  
SECOND INSTALLMENT TAXES DUE FEB. 1, 2009 \$324.05

## VALUATION INFORMATION

ROLL YEAR 08-09	CURRENT ASSESSED VALUE	TAXABLE VALUE
LAND	5,950	5,950
IMPROVEMENTS	1,658	1,658

## ASSESSOR'S REGIONAL OFFICE

REGION #A1 INDEX: TRA:05438  
LANCASTER OFFICE  
251 E AVE K-6  
LANCASTER CA 93535  
(661)940-6700TOTAL 7,608  
LESS EXEMPTION:

ACCT. NO.: PRINT NO.:1603398 BILL ID.:

NET TAXABLE VALUE 7,608

THERE WILL BE A \$50.00 CHARGE FOR ANY CHECK RETURNED BY THE BANK.  
KEEP THIS UPPER PORTION FOR YOUR RECORDS. YOUR CANCELLED CHECK IS YOUR RECEIPT.

2008

## ANNUAL PROPERTY TAX BILL

2008

CITIES, COUNTY, SCHOOLS AND ALL OTHER TAXING AGENCIES IN LOS ANGELES COUNTY  
SECURED PROPERTY TAX FOR FISCAL YEAR JULY 1, 2008 TO JUNE 30, 2009

MARK J. SALADINO, TREASURER AND TAX COLLECTOR

FOR ASSISTANCE CALL 1 (213) 974-2111 OR 1 (888) 807-2111, ON THE WEB AT [www.lacountypropertytax.com](http://www.lacountypropertytax.com)

ASSESSOR'S ID. NO.

CK

DETAIL OF TAXES DUE FOR 8920 851 062 08 000 12

## PROPERTY IDENTIFICATION

ASSESSOR'S ID. NO.: 8920 851 062 08 000

OWNER OF RECORD AS OF JANUARY 1, 2008

SAME AS BELOW

## MAILING ADDRESS

ANTELOPE PARK MUTUAL WATER CO  
P O BOX 1712  
LANCASTER CA 93534

AGENCY	AGENCY PHONE NO.	RATE	AMOUNT
GENERAL TAX LEVY			
ALL AGENCIES		1.000000 \$	477.58
VOTED INDEBTEDNESS			
SPECIAL WATER		.070490 \$	33.67
COMMNTY COLLEGE		.016816	8.03
HIGH SCHDOLS		.020946	10.00
ELEM SCHOOLS		.018555	8.86

## ELECTRONIC FUND TRANSFER (EFT) NUMBER

For American Express, Mastercard and Visa payments call 1 (888) 473-0835  
and have available the EFT number listed above. Service fees will be charged.

## SPECIAL INFORMATION

Paid  
10/22/08  
Chk# 5623

## PROPERTY LOCATION AND/OR PROPERTY DESCRIPTION

WATER DISTRIBUTION SYSTEM

IMPS NOT A LIEN ON LAND ON WHICH

SUCH IMPS ARE LOCATED

TOTAL TAXES DUE	
FIRST INSTALLMENT TAXES DUE NOV. 1, 2008	\$538.14
SECOND INSTALLMENT TAXES DUE FEB. 1, 2009	\$269.07
	\$269.07

## VALUATION INFORMATION

ROLL YEAR 08-09	CURRENT ASSESSED VALUE	TAXABLE VALUE
LAND		
IMPROVEMENTS	47,758	47,758

## ASSESSOR'S REGIONAL OFFICE

REGION #30 INDEX: TRA:05838  
NATURAL RESOURCES  
500 W TEMPLE STREET RM. 183  
LOS ANGELES CA 90012  
(213)974-3108TOTAL  
LESS EXEMPTION: 47,758

NET TAXABLE VALUE 47,758

ACCT. NO.: PRINT NO.:1602508 BILL ID.:

THERE WILL BE A \$50.00 CHARGE FOR ANY CHECK RETURNED BY THE BANK.  
KEEP THIS UPPER PORTION FOR YOUR RECORDS. YOUR CANCELLED CHECK IS YOUR RECEIPT.

2006

## ANNUAL PROPERTY TAX BILL

2006

CITIES, COUNTY, SCHOOLS AND ALL OTHER TAXING AGENCIES IN LOS ANGELES COUNTY  
SECURED PROPERTY TAX FOR FISCAL YEAR JULY 1, 2006 TO JUNE 30, 2007MARK J. SALADINO, TREASURER AND TAX COLLECTOR  
FOR ASSISTANCE CALL (213) 974-2111 OR (888) 807-2111, ON THE WEB AT [www.lacountypropertytax.com](http://www.lacountypropertytax.com)

ASSESSOR'S ID. NO. CK

DETAIL OF TAXES DUE FOR 3125 008 020 06 000 34

## PROPERTY IDENTIFICATION

ASSESSOR'S ID. NO.: 3125 008 020 06 000

OWNER OF RECORD AS OF JANUARY 1, 2006

SAME AS BELOW

## MAILING ADDRESS

ANTELOPE PARK MUTUAL WATER CO  
PO BOX 1712  
LANCASTER CA 93539-1712

AGENCY	AGENCY PHONE NO.	RATE	AMOUNT
GENERAL TAX LEVY		1.000000	\$ 261.14
ALL AGENCIES			

VOTED INDEBTEDNESS			
COUNTY		.000663	\$ .17
SPECIAL WATER		.070490	18.41
COMMUNITY COLLEGE		.029049	7.58
HIGH SCHOOLS		.019959	5.21
ELEM SCHOOLS		.015150	3.96

DIRECT ASSESSMENTS			
WATER STANDBY 40	(626) 300-3343	\$	10.00
COUNTY PARK DIST	(213) 738-2983		5.10
CONSOLIDATED SEWER	(626) 300-3381		17.75
ANTELOPE MOSQ AB	(866) 807-6864		7.11
LA CO FIRE DEPT	(323) 881-6151		12.48
LIGHT MAINT DIST	(661) 723-6239		74.06

## ELECTRONIC FUND TRANSFER (EFT) NUMBER

For American Express, Mastercard and Visa payments call (888) 473-0835  
and have available the EFT number listed above. Service fees will be charged.

## SPECIAL INFORMATION

Paid  
10/22/06PROPERTY LOCATION AND/OR PROPERTY DESCRIPTION  
VAC/VIC 17TH STW/AVE K8 LANCASTER  
TR=14728 W 100 FT MEASURED ON N LINE OF  
LOT 151

TOTAL TAXES DUE	\$422.97
FIRST INSTALLMENT TAXES DUE NOV. 1, 2006	\$211.49
SECOND INSTALLMENT TAXES DUE FEB. 1, 2007	\$211.48

## ASSESSOR'S REGIONAL OFFICE

REGION #A1 INDEX: TRA:05438  
LANCASTER OFFICE  
251 E AVE K-6  
LANCASTER CA 93535  
(661)940-6700

ROLL YEAR 06-07	CURRENT ASSESSED VALUE	TAXABLE VALUE
LAND	26,114	26,114
IMPROVEMENTS		

TOTAL 26,114  
LESS EXEMPTION:

ACCT. NO.: PRINT NO.:1624165 BILL ID.:

NET TAXABLE VALUE 26,114

THERE WILL BE A \$50.00 CHARGE FOR ANY CHECK RETURNED BY THE BANK.  
KEEP THIS UPPER PORTION FOR YOUR RECORDS. YOUR CANCELLED CHECK IS YOUR RECEIPT.

2000

## ANNUAL PROPERTY TAX BILL

2000

CITIES, COUNTY, SCHOOLS AND ALL OTHER TAXING AGENCIES IN LOS ANGELES COUNTY  
SECURED PROPERTY TAX FOR FISCAL YEAR JULY 1, 2006 TO JUNE 30, 2007

MARK J. SALADINO, TREASURER AND TAX COLLECTOR

FOR ASSISTANCE CALL (213) 974-2111 OR (888) 807-2111, ON THE WEB AT [www.lacountypropertytax.com](http://www.lacountypropertytax.com)

ASSESSOR'S ID. NO. CK

DETAIL OF TAXES DUE FOR 3125 008 018 06 000 74

## PROPERTY IDENTIFICATION

ASSESSOR'S ID. NO.: 3125 008 018 06 000

OWNER OF RECORD AS OF JANUARY 1, 2006

SAME AS BELOW

## MAILING ADDRESS

ANTELOPE PARK MUTUAL WATER CO  
PO BOX 1712  
LANCASTER CA 93534-1712

AGENCY	AGENCY PHONE NO.	RATE	AMOUNT
GENERAL TAX LEVY			
ALL AGENCIES		1.000000 \$	73.15
VOTED INDEBTEDNESS			
COUNTY		.000663 \$	.05
SPECIAL WATER		.070490	5.15
COMMNTY COLLEGE		.029049	2.12
HIGH SCHOOLS		.019959	1.46
ELEM. SCHOOLS		.015150	1.11
DIRECT ASSESSMENTS			
WATER STANDBY 40	(626) 300-3343	\$	10.00
TRAUMA/EMERG SRV	(866) 587-2862		5.40
CONSLDATED SEWER	(626) 300-3381		177.50
ANTELOPE MOSQ AB	(866) 807-6864		6.18
LA CO FIRE DEPT	(323) 881-6151		60.43
LIGHT MAINT DIST	(661) 723-6239		148.12

## ELECTRONIC FUND TRANSFER (EFT) NUMBER

For American Express, Mastercard and Visa payments call (888) 473-0835  
and have available the EFT number listed above. Service fees will be charged.

## SPECIAL INFORMATION

Paid  
10/22/06PROPERTY LOCATION AND/OR PROPERTY DESCRIPTION  
1721 W AVENUE K8 LANCASTER  
TRACT NO 14728 W 100 FT EX OF ST OF  
LOT 152TOTAL TAXES DUE \$490.67  
FIRST INSTALLMENT TAXES DUE NOV. 1, 2006 \$245.34  
SECOND INSTALLMENT TAXES DUE FEB. 1, 2007 \$245.33

## ASSESSOR'S REGIONAL OFFICE

REGION #A1 INDEX: TRA:05438  
LANCASTER OFFICE  
251 E AVE K-6  
LANCASTER CA 93535  
(661)940-6700

ROLL YEAR 06-07	CURRENT ASSESSED VALUE	TAXABLE VALUE
LAND	5,720	5,720
IMPROVEMENTS	1,595	1,595

TOTAL 7,315  
LESS EXEMPTION:

ACCT. NO.: PRINT NO.:1601890 BILL ID.:

NET TAXABLE VALUE 7,315

THERE WILL BE A \$50.00 CHARGE FOR ANY CHECK RETURNED BY THE BANK.  
KEEP THIS UPPER PORTION FOR YOUR RECORDS. YOUR CANCELLED CHECK IS YOUR RECEIPT.



2006

## ANNUAL PROPERTY TAX BILL

2006

CITIES, COUNTY, SCHOOLS AND ALL OTHER TAXING AGENCIES IN LOS ANGELES COUNTY

## SECURED PROPERTY TAX FOR FISCAL YEAR JULY 1, 2006 TO JUNE 30, 2007

MARK J. SALADINO, TREASURER AND TAX COLLECTOR

FOR ASSISTANCE CALL (213) 974-2111 OR (888) 807-2111, ON THE WEB AT [www.lacountypropertytax.com](http://www.lacountypropertytax.com)

ASSESSOR'S ID. NO. CK

DETAIL OF TAXES DUE FOR 8920 851 062 06 000 14

## PROPERTY IDENTIFICATION

ASSESSOR'S ID. NO.: 8920 851 062 06 000

OWNER OF RECORD AS OF JANUARY 1, 2006

SAME AS BELOW

## MAILING ADDRESS

ANTELOPE PARK MUTUAL WATER CO  
P O BOX 1712  
LANCASTER CA 93534

AGENCY	AGENCY PHONE NO.	RATE	AMOUNT
GENERAL TAX LEVY			
ALL AGENCIES		1.000000 \$	459.03
VOTED INDEBTEDNESS			
COUNTY		.000663 \$	.30
SPECIAL WATER		.070490	32.36
COMMNTY COLLEGE		.029049	13.34
HIGH SCHOOLS		.019959	9.16
ELEM SCHOOLS		.015150	6.95

## ELECTRONIC FUND TRANSFER (EFT) NUMBER

or American Express, Mastercard and Visa payments call (888) 473-0835  
and have available the EFT number listed above. Service fees will be charged.

## SPECIAL INFORMATION

*Paid*  
*10/22/06*

## PROPERTY LOCATION AND/OR PROPERTY DESCRIPTION

WATER DISTRIBUTION SYSTEM

IMPS NOT A LIEN ON LAND ON WHICH SUCH

IMPS ARE LOCATED

<b>TOTAL TAXES DUE</b>	<b>\$521.14</b>
<b>FIRST INSTALLMENT TAXES DUE NOV. 1, 2006</b>	<b>\$260.57</b>
<b>SECOND INSTALLMENT TAXES DUE FEB. 1, 2007</b>	<b>\$260.57</b>

## VALUATION INFORMATION

ROLL YEAR 06-07	CURRENT ASSESSED VALUE	TAXABLE VALUE
LAND		
IMPROVEMENTS	45,903	45,903

## ASSESSOR'S REGIONAL OFFICE

REGION #30 INDEX: TRA:05838

NATURAL RESOURCES

500 W TEMPLE STREET RM. 183

LOS ANGELES CA 90012

(213)974-3108

TOTAL	45,903
LESS EXEMPTION:	

ACCT. NO.: PRINT NO.:1600850 BILL ID.:

NET TAXABLE VALUE	45,903
-------------------	--------

THERE WILL BE A \$50.00 CHARGE FOR ANY CHECK RETURNED BY THE BANK.  
KEEP THIS UPPER PORTION FOR YOUR RECORDS. YOUR CANCELLED CHECK IS YOUR RECEIPT.

2000

## ANNUAL PROPERTY TAX BILL

2000

CITIES, COUNTY, SCHOOLS AND ALL OTHER TAXING AGENCIES IN LOS ANGELES COUNTY  
SECURED PROPERTY TAX FOR FISCAL YEAR JULY 1, 2006 TO JUNE 30, 2007

MARK J. SALADINO, TREASURER AND TAX COLLECTOR

FOR ASSISTANCE CALL (213) 974-2111 OR (888) 807-2111, ON THE WEB AT [www.lacountypropertytax.com](http://www.lacountypropertytax.com)

ASSESSOR'S ID. NO. CK

DETAIL OF TAXES DUE FOR 8920 851 061 06 000 24

## PROPERTY IDENTIFICATION

ASSESSOR'S ID. NO.: 8920 851 061 06 000

OWNER OF RECORD AS OF JANUARY 1, 2006

SAME AS BELOW

## MAILING ADDRESS

ANTELOPE PARK MUTUAL WATER CO  
P O BOX 1712  
LANCASTER CA 93534

AGENCY	AGENCY PHONE NO.	RATE	AMOUNT
GENERAL TAX LEVY			
ALL AGENCIES		1.000000 \$	1,273.18
VOTED INDEBTEDNESS			
COUNTY		.000663 \$	.84
SPECIAL WATER		.070490	89.75
COMMUNITY COLLEGE		.029049	36.98
HIGH SCHOOLS		.019959	25.41
ELEM SCHOOLS		.015150	19.29

## ELECTRONIC FUND TRANSFER (EFT) NUMBER

or American Express, Mastercard and Visa payments call (888) 473-0835  
and have available the EFT number listed above. Service fees will be charged.

## SPECIAL INFORMATION

Paid  
10/22/06PROPERTY LOCATION AND/OR PROPERTY DESCRIPTION  
WATER DISTRIBUTION SYSTEM  
IMPS NOT A LIEN ON LAND ON WHICH SUCH  
IMPS ARE LOCATED

TOTAL TAXES DUE	
FIRST INSTALLMENT TAXES DUE NOV. 1, 2006	\$1,445.45
SECOND INSTALLMENT TAXES DUE FEB. 1, 2007	\$722.73
	\$722.72

## VALUATION INFORMATION

ROLL YEAR 06-07	CURRENT ASSESSED VALUE	TAXABLE VALUE
LAND		
IMPROVEMENTS	127,318	127,318

## ASSESSOR'S REGIONAL OFFICE

REGION #30 INDEX: TRA:05844  
NATURAL RESOURCES  
500 W TEMPLE STREET RM. 183  
LOS ANGELES CA 90012  
(213)974-3108TOTAL  
LESS EXEMPTION: 127,318

ACCT. NO.: PRINT NO.:1600849 BILL ID.:

NET TAXABLE VALUE 127,318

THERE WILL BE A \$50.00 CHARGE FOR ANY CHECK RETURNED BY THE BANK.  
KEEP THIS UPPER PORTION FOR YOUR RECORDS. YOUR CANCELLED CHECK IS YOUR RECEIPT.

2009

## ANNUAL PROPERTY TAX BILL

2009

CITIES, COUNTY, SCHOOLS AND ALL OTHER TAXING AGENCIES IN LOS ANGELES COUNTY  
SECURED PROPERTY TAX FOR FISCAL YEAR JULY 1, 2009 TO JUNE 30, 2010

MARK J. SALADINO, TREASURER AND TAX COLLECTOR

FOR ASSISTANCE CALL 1 (213) 974-2111 OR 1 (888) 807-2111, ON THE WEB AT [www.lacountypropertytax.com](http://www.lacountypropertytax.com)

ASSESSOR'S ID. NO.

CK

DETAIL OF TAXES DUE FOR 8920 851 061 09 000 21

## PROPERTY IDENTIFICATION

ASSESSOR'S ID. NO.: 8920 851 061 09 000

OWNER OF RECORD AS OF JANUARY 1, 2009

SAME AS BELOW

## MAILING ADDRESS

ANTELOPE PARK MUTUAL WATER CO  
P O BOX 1712  
LANCASTER CA 93534

AGENCY	AGENCY PHONE NO.	RATE	AMOUNT
GENERAL TAX LEVY			
ALL AGENCIES		1.000000 \$	1,351.11
VOTED INDEBTEDNESS			
SPECIAL WATER		.070490 \$	95.24
COMMNTY COLLEGE		.024595	33.23
HIGH SCHOOLS		.024211	32.71
ELEM SCHOOLS		.022823	30.83

## ELECTRONIC FUND TRANSFER (EFT) NUMBER

For American Express, Mastercard and Visa payments call 1 (888) 473-0835  
and have available the EFT number listed above. Service fees will be charged.

## SPECIAL INFORMATION

## PROPERTY LOCATION AND/OR PROPERTY DESCRIPTION

WATER DISTRIBUTION SYSTEM

IMPS NOT A LIEN ON LAND ON WHICH

SUCH IMPS ARE LOCATED

## ASSESSOR'S REGIONAL OFFICE

REGION #30 INDEX: TRA:05844  
NATURAL RESOURCES  
500 W TEMPLE STREET RM. 183  
LOS ANGELES CA 90012  
(213)974-3108

ACCT. NO.: PRINT NO.:1539873 BILL ID.:

<b>TOTAL TAXES DUE</b>	<b>\$1,543.12</b>
FIRST INSTALLMENT TAXES DUE NOV. 1, 2009	\$771.56
SECOND INSTALLMENT TAXES DUE FEB. 1, 2010	\$771.56

## VALUATION INFORMATION

ROLL YEAR 09-10	CURRENT ASSESSED VALUE	TAXABLE VALUE
LAND		
IMPROVEMENTS	135,111	135,111

TOTAL	135,111
LESS EXEMPTION:	
NET TAXABLE VALUE	135,111

Paid 10/28/09

2009

## ANNUAL PROPERTY TAX BILL

2009

CITIES, COUNTY, SCHOOLS AND ALL OTHER TAXING AGENCIES IN LOS ANGELES COUNTY  
SECURED PROPERTY TAX FOR FISCAL YEAR JULY 1, 2009 TO JUNE 30, 2010

MARK J. SALADINO, TREASURER AND TAX COLLECTOR

FOR ASSISTANCE CALL 1 (213) 974-2111 OR 1 (888) 807-2111, ON THE WEB AT [www.lacountypropertytax.com](http://www.lacountypropertytax.com)

ASSESSOR'S ID. NO.

CK

DETAIL OF TAXES DUE FOR 3125 008 020 09 000 31

## PROPERTY IDENTIFICATION

ASSESSOR'S ID. NO.: 3125 008 020 09 000

OWNER OF RECORD AS OF JANUARY 1, 2009

SAME AS BELOW

## MAILING ADDRESS

ANTELOPE PARK MUTUAL WATER CO  
PO BOX 1712  
LANCASTER CA 93539-1712

AGENCY	AGENCY PHONE NO.	RATE	AMOUNT
GENERAL TAX LEVY			
ALL AGENCIES		1.000000 \$	277.11
VOTED INDEBTEDNESS			
SPECIAL WATER		.070490 \$	19.53
COMMNTY COLLEGE		.024595	6.82
HIGH SCHOOLS		.024211	6.71
ELEM SCHOOLS		.022823	6.32
DIRECT ASSESSMENTS			
WATER STANDBY 40	(626) 300-3343	\$	10.00
COUNTY PARK DIST	(213) 738-2983		5.10
LA CO FIRE DEPT	(323) 881-6151		14.04
ANTELOPE MOSQ AB	(866) 807-6864		7.59
LIGHT MAINT DIST	(661) 723-6183		85.97
LNCSTR SWR SYSTM	(661) 723-6183		39.00

## ELECTRONIC FUND TRANSFER (EFT) NUMBER

For American Express, Mastercard and Visa payments call 1 (888) 473-0835  
and have available the EFT number listed above. Service fees will be charged  
SPECIAL INFORMATION

## PROPERTY LOCATION AND/OR PROPERTY DESCRIPTION

VAC/VIC 17TH STW/AVE K8 LANCASTER  
TR=14728 W 100 FT MEASURED ON N LINE OF  
LOT 151

TOTAL TAXES DUE	\$478.19
FIRST INSTALLMENT TAXES DUE NOV. 1, 2009	\$239.10
SECOND INSTALLMENT TAXES DUE FEB. 1, 2010	\$239.09

## VALUATION INFORMATION

ROLL YEAR 09-10	CURRENT ASSESSED VALUE	TAXABLE VALUE
LAND	27,711	27,711
IMPROVEMENTS		

## ASSESSOR'S REGIONAL OFFICE

REGION #A1 INDEX: TRA:05438  
LANCASTER OFFICE  
251 E AVE K-6  
LANCASTER CA 93535  
(661)940-6700

TOTAL	27,711
LESS EXEMPTION:	
NET TAXABLE VALUE	27,711

ACCT. NO.: PRINT NO.:1559650 BILL ID.:

ANY RETURNED PAYMENT MAYBE SUBJECT TO A FEE UP TO \$50.00.  
KEEP THIS UPPER PORTION FOR YOUR RECORDS. YOUR CANCELLED CHECK IS YOUR RECEIPT.

2009

## ANNUAL PROPERTY TAX BILL

2009

CITIES, COUNTY, SCHOOLS AND ALL OTHER TAXING AGENCIES IN LOS ANGELES COUNTY  
SECURED PROPERTY TAX FOR FISCAL YEAR JULY 1, 2009 TO JUNE 30, 2010

MARK J. SALADINO, TREASURER AND TAX COLLECTOR

FOR ASSISTANCE CALL 1 (213) 974-2111 OR 1 (888) 807-2111, ON THE WEB AT [www.lacountypropertytax.com](http://www.lacountypropertytax.com)

ASSESSOR'S ID. NO.

CK

DETAIL OF TAXES DUE FOR 8920 851 062 09 000 11

## PROPERTY IDENTIFICATION

ASSESSOR'S ID. NO.: 8920 851 062 09 000

OWNER OF RECORD AS OF JANUARY 1, 2009

SAME AS BELOW

## MAILING ADDRESS

ANTELOPE PARK MUTUAL WATER CO  
P O BOX 1712  
LANCASTER CA 93534

AGENCY	AGENCY PHONE NO.	RATE	AMOUNT
GENERAL TAX LEVY			
ALL AGENCIES		1.000000 \$	487.13
VOTED INDEBTEDNESS			
SPECIAL WATER		.070490 \$	34.34
COMMNTY COLLEGE		.024595	11.98
HIGH SCHOOLS		.024211	11.79
ELEM SCHOOLS		.022823	11.12

## ELECTRONIC FUND TRANSFER (EFT) NUMBER

For American Express, Mastercard and Visa payments call 1 (888) 473-0835  
and have available the EFT number listed above. Service fees will be charged.

## SPECIAL INFORMATION

## PROPERTY LOCATION AND/OR PROPERTY DESCRIPTION

WATER DISTRIBUTION SYSTEM

IMPS NOT A LIEN ON LAND ON WHICH

SUCH IMPS ARE LOCATED

## ASSESSOR'S REGIONAL OFFICE

REGION #30 INDEX: TRA:05838  
NATURAL RESOURCES  
500 W TEMPLE STREET RM. 183  
LOS ANGELES CA 90012  
(213)974-3108

ACCT. NO.: PRINT NO.:1539874 BILL ID.:

*Paid*  
*10/28/09*

TOTAL TAXES DUE	
FIRST INSTALLMENT TAXES DUE NOV. 1, 2009	\$278.18
SECOND INSTALLMENT TAXES DUE FEB. 1, 2010	\$278.18

## VALUATION INFORMATION

ROLL YEAR 09-10	CURRENT ASSESSED VALUE	TAXABLE VALUE
-----------------	------------------------	---------------

LAND		
IMPROVEMENTS	48,713	48,713

TOTAL	48,713
LESS EXEMPTION:	

NET TAXABLE VALUE	48,713
-------------------	--------

ANY RETURNED PAYMENT MAYBE SUBJECT TO A FEE UP TO \$50.00.  
FOR YOUR RECORDS. YOUR CANCELLED CHECK IS YOUR RECEIPT.

**ANNUAL PROPERTY TAX BILL**

CITIES, COUNTY, SCHOOLS AND ALL OTHER TAXING AGENCIES IN LOS ANGELES COUNTY  
**SECURED PROPERTY TAX FOR FISCAL YEAR JULY 1, 2011 TO JUNE 30, 2012**

MARK J. SALADINO, TREASURER AND TAX COLLECTOR  
 FOR ASSISTANCE CALL 1(213) 974-2111 OR 1(888) 807-2111, ON THE WEB AT [www.lacountypropertytax.com](http://www.lacountypropertytax.com)

ASSESSOR'S ID. NO.

CK

DETAIL OF TAXES DUE FOR **3125 008 020 11 000 37**

**PROPERTY IDENTIFICATION**

ASSESSOR'S ID. NO.: 3125 008 020 11 000  
 OWNER OF RECORD AS OF JANUARY 1, 2011  
 SAME AS BELOW

**MAILING ADDRESS**

ANTELOPE PARK MUTUAL WATER CO  
 PO BOX 1712  
 LANCASTER CA 93539-1712

**ELECTRONIC FUND TRANSFER (EFT) NUMBER**

For American Express, Mastercard and Visa payments call 1(888) 473-0835  
 and have available the EFT number listed above. Service fees will be charged.  
**SPECIAL INFORMATION**

AGENCY	AGENCY PHONE NO.	RATE	AMOUNT
GENERAL TAX LEVY			
ALL AGENCIES		1.000000 \$	278.53
VOTED INDEBTEDNESS			
SPECIAL WATER		.070490 \$	19.63
COMMUNITY COLLEGE		.025988	7.24
HIGH SCHOOLS		.029130	8.11
ELEM SCHOOLS		.030738	8.56
DIRECT ASSESSMENTS			
ANTELOPE MOSQ AB	(661) 236-9550	\$	7.59
WATER STANDBY 40	(626) 300-3343		10.00
LIGHT MAINT DIST	(661) 945-6809		89.17
LANCSTR SWR SYSTM	(661) 945-6809		39.00
COUNTY PARK DIST	(213) 738-2983		5.10
LA CO FIRE DEPT	(323) 881-6151		15.26

*Paid*  
*10/17/11*  
*Chk# 5644*

**PROPERTY LOCATION AND/OR PROPERTY DESCRIPTION**

VAC/VIC 17TH STW/AVE K8 LANCASTER  
 TR=14728 W 100 FT MEASURED ON N LINE OF  
 LOT 151

**TOTAL TAXES DUE** **\$488.19**  
**FIRST INSTALLMENT TAXES DUE NOV. 1, 2011** **\$244.10**  
**SECOND INSTALLMENT TAXES DUE FEB. 1, 2012** **\$244.09**

**VALUATION INFORMATION**

ROLL YEAR 11-12	CURRENT ASSESSED VALUE	TAXABLE VALUE
LAND	27,853	27,853
IMPROVEMENTS		

**ASSESSOR'S REGIONAL OFFICE**

REGION #A1 INDEX: TRA:05438  
 LANCASTER OFFICE  
 251 E AVE K-6  
 LANCASTER CA 93535  
 (661)940-6700

TOTAL 27,853  
 LESS EXEMPTION:

ACCT. NO.: PRINT NO.:1457719 BILL ID.:

NET TAXABLE VALUE 27,853

ANY RETURNED PAYMENT MAY BE SUBJECT TO A FEE UP TO \$50.00.

2011

## ANNUAL PROPERTY TAX BILL

2011

CITIES, COUNTY, SCHOOLS AND ALL OTHER TAXING AGENCIES IN LOS ANGELES COUNTY  
SECURED PROPERTY TAX FOR FISCAL YEAR JULY 1, 2011 TO JUNE 30, 2012

MARK J. SALADINO, TREASURER AND TAX COLLECTOR

FOR ASSISTANCE CALL 1(213) 974-2111 OR 1(888) 807-2111, ON THE WEB AT [www.lacountypropertytax.com](http://www.lacountypropertytax.com)

ASSESSOR'S ID. NO.

CK

DETAIL OF TAXES DUE FOR 8920 851 062 11 000 17

## PROPERTY IDENTIFICATION

ASSESSOR'S ID. NO.: 8920 851 062 11 000

OWNER OF RECORD AS OF JANUARY 1, 2011

SAME AS BELOW

## MAILING ADDRESS

ANTELOPE PARK MUTUAL WATER CO  
P O BOX 1712  
LANCASTER CA 93534

AGENCY	AGENCY PHONE NO.	RATE	AMOUNT
GENERAL TAX LEVY			
ALL AGENCIES		1.000000 \$	489.62
VOTED INDEBTEDNESS			
SPECIAL WATER		.070490 \$	34.51
COMMNTY COLLEGE		.025988	12.73
HIGH SCHOOLS		.029130	14.26
ELEM SCHOOLS		.030738	15.05

## ELECTRONIC FUND TRANSFER (EFT) NUMBER

For American Express, Mastercard and Visa payments call 1(888) 473-0835  
and have available the EFT number listed above. Service fees will be charged.

## SPECIAL INFORMATION

Paid 10/17/11  
Ch# 5644

## PROPERTY LOCATION AND/OR PROPERTY DESCRIPTION

WATER DISTRIBUTION SYSTEM

IMPS NOT A LIEN ON LAND ON WHICH

SUCH IMPS ARE LOCATED

TOTAL TAXES DUE	\$566.17
FIRST INSTALLMENT TAXES DUE NOV. 1, 2011	\$283.09
SECOND INSTALLMENT TAXES DUE FEB. 1, 2012	\$283.08

## VALUATION INFORMATION

ROLL YEAR 11-12	CURRENT ASSESSED VALUE	TAXABLE VALUE
LAND		
IMPROVEMENTS	48,962	48,962

## ASSESSOR'S REGIONAL OFFICE

REGION #30 INDEX: TRA:05838  
NATURAL RESOURCES  
500 W TEMPLE STREET RM. 183  
LOS ANGELES CA 90012  
(213)974-3108

TOTAL	48,962
LESS EXEMPTION:	
NET TAXABLE VALUE	48,962

ACCT. NO.: PRINT NO.:1440286 BILL ID.:

ANY RETURNED PAYMENT MAY BE SUBJECT TO A FEE UP TO \$50.00.

CITIES, COUNTY, SCHOOLS AND ALL OTHER TAXING AGENCIES IN LOS ANGELES COUNTY  
**SECURED PROPERTY TAX FOR FISCAL YEAR JULY 1, 2011 TO JUNE 30, 2012**

MARK J. SALADINO, TREASURER AND TAX COLLECTOR

FOR ASSISTANCE CALL 1(213) 974-2111 OR 1(888) 807-2111, ON THE WEB AT [www.lacountypropertytax.com](http://www.lacountypropertytax.com)

ASSESSOR'S ID. NO.

CK

DETAIL OF TAXES DUE FOR **8920 851 061 11 000 27**

**PROPERTY IDENTIFICATION**

ASSESSOR'S ID. NO.: 8920 851 061 11 000

OWNER OF RECORD AS OF JANUARY 1, 2011

SAME AS BELOW

**MAILING ADDRESS**

ANTELOPE PARK MUTUAL WATER CO  
P O BOX 1712  
LANCASTER CA 93534

AGENCY	AGENCY PHONE NO.	RATE	AMOUNT
GENERAL TAX LEVY			
ALL AGENCIES		1.000000 \$	1,358.04
VOTED INDEBTEDNESS			
SPECIAL WATER		.070490 \$	95.73
COMMNTY COLLEGE		.025988	35.29
HIGH SCHOOLS		.029130	39.56
ELEM SCHOOLS		.030738	41.74

**ELECTRONIC FUND TRANSFER (EFT) NUMBER**

For American Express, Mastercard and Visa payments call 1(888) 473-0835  
and have available the EFT number listed above. Service fees will be charged.

**SPECIAL INFORMATION**

**PROPERTY LOCATION AND/OR PROPERTY DESCRIPTION**

WATER DISTRIBUTION SYSTEM

IMPS NOT A LIEN ON LAND ON WHICH

SUCH IMPS ARE LOCATED

**ASSESSOR'S REGIONAL OFFICE**

REGION #30 INDEX: TRA:05844

NATURAL RESOURCES

500 W TEMPLE STREET RM. 183

LOS ANGELES CA 90012

(213)974-3108

ACCT. NO.: PRINT NO.: 1440285 BILL ID.:

**TOTAL TAXES DUE \$1,570.36**

**FIRST INSTALLMENT TAXES DUE NOV. 1, 2011 \$785.18**

**SECOND INSTALLMENT TAXES DUE FEB. 1, 2012 \$785.18**

**VALUATION INFORMATION**

**ROLL YEAR 11-12 CURRENT ASSESSED VALUE TAXABLE VALUE**

LAND		
IMPROVEMENTS	135,804	135,804

**TOTAL 135,804**

**LESS EXEMPTION:**

**NET TAXABLE VALUE 135,804**

ANY RETURNED PAYMENT MAY BE SUBJECT TO A FEE UP TO \$50.00.

*Paid 10/17/11  
ck# 5644*



CITIES, COUNTY, SCHOOLS AND ALL OTHER TAXING AGENCIES IN LOS ANGELES COUNTY  
**SECURED PROPERTY TAX FOR FISCAL YEAR JULY 1, 2011 TO JUNE 30, 2012**

MARK J. SALADINO, TREASURER AND TAX COLLECTOR

FOR ASSISTANCE CALL 1(213) 974-2111 OR 1(888) 807-2111, ON THE WEB AT [www.lacountypropertytax.com](http://www.lacountypropertytax.com)

ASSESSOR'S ID. NO.

CK

DETAIL OF TAXES DUE FOR **3125 008 018 11 000 77**

**PROPERTY IDENTIFICATION**

ASSESSOR'S ID. NO.: 3125 008 018 11 000

OWNER OF RECORD AS OF JANUARY 1, 2011

SAME AS BELOW

**MAILING ADDRESS**

ANTELOPE PARK MUTUAL WATER CO  
 PO BOX 1712  
 LANCASTER CA 93534-1712

**ELECTRONIC FUND TRANSFER (EFT) NUMBER**

or American Express, Mastercard and Visa payments call 1(888) 473-0835  
 and have available the EFT number listed above. Service fees will be charged.

**SPECIAL INFORMATION**

AGENCY	AGENCY PHONE NO.	RATE	AMOUNT
GENERAL TAX LEVY			
ALL AGENCIES		1.000000 \$	77.97
VOTED INDEBTEDNESS			
SPECIAL WATER		.070490 \$	5.49
COMMUNITY COLLEGE		.025988	2.03
HIGH SCHOOLS		.029130	2.27
ELEM SCHOOLS		.030738	2.40
DIRECT ASSESSMENTS			
ANTELOPE MOSQ AB	(661) 236-9550	\$	6.59
WATER STANDBY 40	(626) 300-3343		10.00
LIGHT MAINT DIST	(661) 945-6809		172.98
LANCSTR SWR SYSTM	(661) 945-6809		390.00
TRAUMA/EMERG SRV	(866) 587-2862		7.18
LA CD FIRE DEPT	(323) 881-6151		73.87

*Paid 10/17/11  
 CK # 5644*

**PROPERTY LOCATION AND/OR PROPERTY DESCRIPTION**

1721 W AVENUE K8 LANCASTER  
 TRACT NO 14728 W 100 FT EX OF ST OF  
 LOT 152

**TOTAL TAXES DUE \$750.78**  
**FIRST INSTALLMENT TAXES DUE NOV. 1, 2011 \$375.39**  
**SECOND INSTALLMENT TAXES DUE FEB. 1, 2012 \$375.39**

**VALUATION INFORMATION**

ROLL YEAR 11-12	CURRENT ASSESSED VALUE	TAXABLE VALUE
LAND	6,099	6,099
IMPROVEMENTS	1,698	1,698

**ASSESSOR'S REGIONAL OFFICE**

REGION #A1 INDEX: TRA:05438  
 LANCASTER OFFICE  
 251 E AVE K-6  
 LANCASTER CA 93535  
 (661)940-6700

TOTAL 7,797  
 LESS EXEMPTION:  
 NET TAXABLE VALUE 7,797

ACCT. NO.: PRINT NO.:1440942 BILL ID.:

ANY RETURNED PAYMENT MAY BE SUBJECT TO A FEE UP TO \$50.00.

**CITIES, COUNTY, SCHOOLS AND ALL OTHER TAXING AGENCIES IN LOS ANGELES COUNTY  
SECURED PROPERTY TAX FOR FISCAL YEAR JULY 1, 2010 TO JUNE 30, 2011**

MARK J. SALADINO, TREASURER AND TAX COLLECTOR

FOR ASSISTANCE CALL 1 (213) 974-2111 OR 1 (888) 807-2111, ON THE WEB AT [www.lacountypropertytax.com](http://www.lacountypropertytax.com)

ASSESSOR'S ID. NO.

CK

**DETAIL OF TAXES DUE FOR 3125 008 020 10 000 38**

**PROPERTY IDENTIFICATION**

ASSESSOR'S ID. NO.: 3125 008 020 10 000  
OWNER OF RECORD AS OF JANUARY 1, 2010  
SAME AS BELOW

**MAILING ADDRESS**

ANTELOPE PARK MUTUAL WATER CO  
PO BOX 1712  
LANCASTER CA 93539-1712

AGENCY	AGENCY PHONE NO.	RATE	AMOUNT
GENERAL TAX LEVY			
ALL AGENCIES		1.000000 \$	276.45
VOTED INDEBTEDNESS			
SPECIAL WATER		.070490 \$	19.48
COMMNTY COLLEGE		.025386	7.02
HIGH SCHOOLS		.029017	8.02
ELEM SCHOOLS		.030613	8.46
DIRECT ASSESSMENTS			
ANTELOPE MOSQ AB	(888) 802-1805	\$	7.59
WATER STANDBY 40	(626) 300-3343		10.00
LIGHT MAINT DIST	(661) 723-6183		87.17
LNCSTR SWR SYSTM	(661) 723-6183		39.00
COUNTY PARK DIST	(213) 738-2983		5.10
LA CO FIRE DEPT	(323) 881-6151		14.04

**ELECTRONIC FUND TRANSFER (EFT) NUMBER**

For American Express, Mastercard and Visa payments call 1 (888) 473-0835 and have available the EFT number listed above. Service fees will be charged.

**SPECIAL INFORMATION**

*Paid 10/23/10' Ch #5479*

**PROPERTY LOCATION AND/OR PROPERTY DESCRIPTION**

VAC/VIC 17TH STW/AVE K8 LANCASTER  
TR=14728 W 100 FT MEASURED ON N LINE OF  
LOT 151

**TOTAL TAXES DUE \$482.33**  
**FIRST INSTALLMENT TAXES DUE NOV. 1, 2010 \$241.17**  
**SECOND INSTALLMENT TAXES DUE FEB. 1, 2011 \$241.16**

**VALUATION INFORMATION**

ROLL YEAR 10-11	CURRENT ASSESSED VALUE	TAXABLE VALUE
LAND	27,645	27,645
IMPROVEMENTS		

**ASSESSOR'S REGIONAL OFFICE**

REGION #A1 INDEX: TRA:05438  
LANCASTER OFFICE  
251 E AVE K-6  
LANCASTER CA 93535  
(661)940-6700

ACCT. NO.: PRINT NO.:1498097 BILL ID.:

TOTAL 27,645  
LESS EXEMPTION:  
NET TAXABLE VALUE 27,645

ANY RETURNED PAYMENT MAYBE SUBJECT TO A FEE UP TO \$50.00.  
KEEP THIS UPPER PORTION FOR YOUR RECORDS. YOUR CANCELLED CHECK IS YOUR RECEIPT.

20th street West

Ave. K

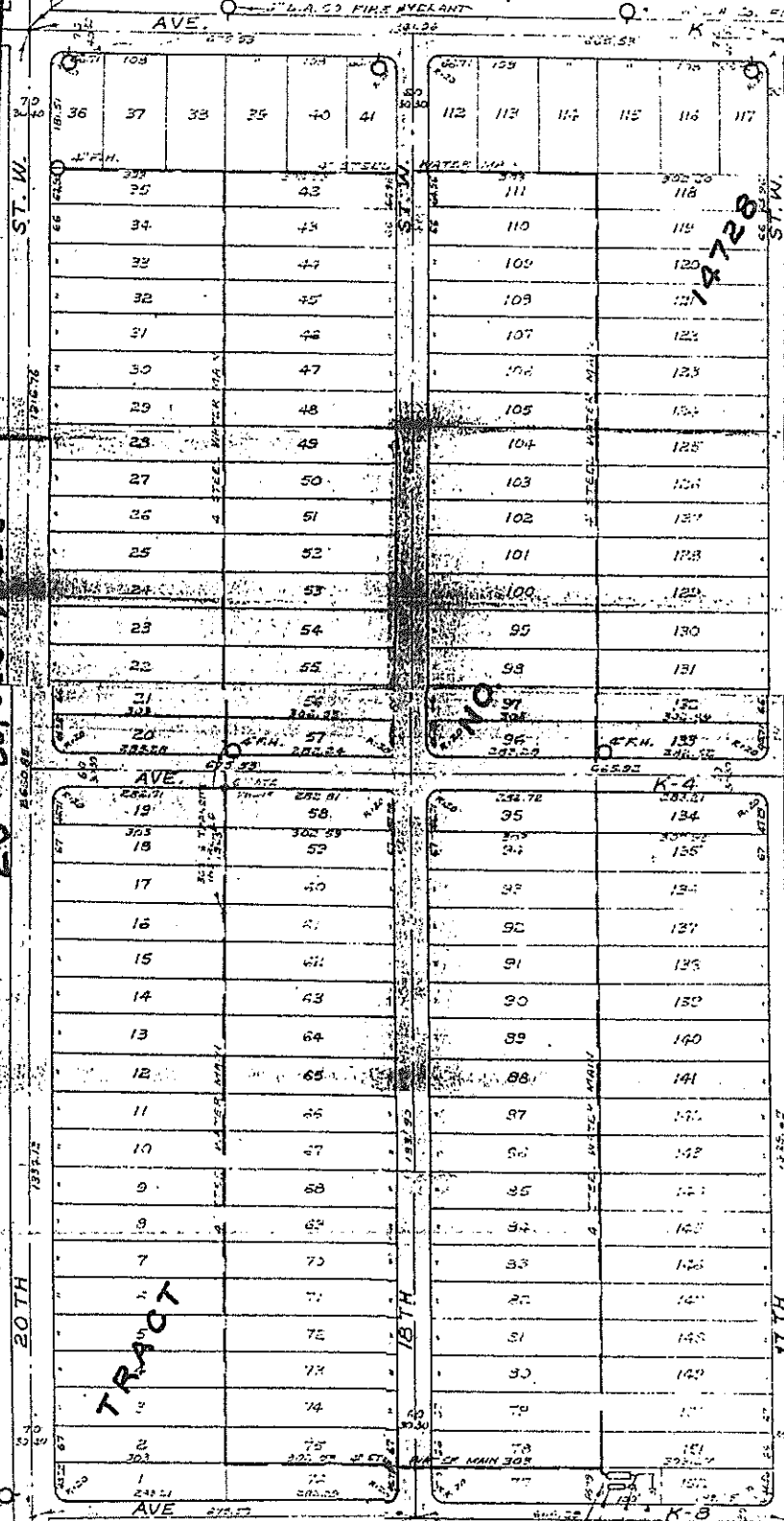

Ave. K-8  
Antelope Park Mutual Water  
Boundaries

- WATER SYSTEM -  
ANTELOPE PARK MUTUAL  
COMPANY

43337 18 TH ST. W.  
LANCASTER, CALIF.

DRAWN BY H. W. SMITH DATE 1-24-66  
APPROVED BY H. W. SMITH DATE 1-24-66

1  
2  
3  
4  
5  
6  
7  
8  
9  
10  
11  
12  
13  
14  
15  
16  
17  
18  
19  
20  
21  
22  
23  
24  
25  
26  
27

ANTELOPE PARK MUTUAL WATER COMPANY

Attachment I.3.c.i.

GRESHAM | SAVAGE  
ATTORNEYS AT LAW  
3750 UNIVERSITY AVE.  
STE. 250  
RIVERSIDE, CA 92501-3335  
(951) 684-2171

CROSS-DEFENDANT/CROSS-COMPLAINANT, ANTELOPE VALLEY UNITED MUTUAL GROUP, SPECIFICALLY  
ANTELOPE PARK MUTUAL WATER COMPANY'S, FIRST SUPPLEMENTAL RESPONSE TO DECEMBER 12, 2012  
DISCOVERY ORDER FOR PHASE 4 TRIAL

NUMBER \_\_\_\_\_

SHARES \_\_\_\_\_

Incorporated Under the Laws of the State of California, April 25, 1947

# Antelope Park Mutual Water Company

CAPITAL STOCK \$3,200.00

320 SHARES PAR VALUE \$10.00 EACH

This certifies that \_\_\_\_\_  
is the record holder of one share of the capital stock of

## Antelope Park Mutual Water Company

Transferable only on the books of the corporation by the holder hereof in person, or by attorney upon the surrender of the certificate properly endorsed and upon the following conditions to-wit:  
This certificate is issued to the holder hereof and accepted by him on the condition that the share of stock represented hereby is attached to and made appurtenant to that property situated in the County of Los Angeles, State of California, being Lot No. \_\_\_\_\_ Block No. \_\_\_\_\_ Tract No. \_\_\_\_\_

as per map recorded in the office of the County Recorder of Los Angeles County in Book No. \_\_\_\_\_ Page No. \_\_\_\_\_ of Maps. Title of said shares of stock shall and does automatically pass with the transfer of said land, and the corporation shall not be required to transfer the said stock upon its books unless due proof is submitted of the transfer of said land.

The shares represented by this certificate may be sold in the manner provided by law to pay installments of water rates or by reason of other defaults. The holder hereof is entitled to receive his pro-rata share of the water capable of being delivered by this corporation. The holder hereof must pay his pro-rata share of the costs and expense of delivering water, as well as maintaining the water plant, and any other charges that may be fixed in accordance with the articles of incorporation and by-laws of this corporation.

The holder hereof represents that he is the owner of the above described lands, and hereby gives and grants to the Antelope Park Mutual Water Company, its successors or assigns, a perpetual right-of-way over, under and through said lands for the purpose of laying and maintaining pipes or pipe-lines to convey water to its stockholders.

The holder of this certificate expressly represents and states that he is the owner of the land herein described and that he has read and knows provisions of the By-Laws of this corporation, and hereby expressly agrees to be bound thereby to the same effect as if the same were personally subscribed by the holder of this certificate.

By accepting this certificate the acceptor hereby expressly consents and agrees to each and every matter and thing hereinabove stated or mentioned, and all the provisions and conditions set forth in the Articles of Incorporation and in the By-Laws of the Company.

IN WITNESS WHEREOF the Corporation has caused this certificate to be signed and its corporate seal to be affixed by its duly authorized officers this \_\_\_\_\_ day of \_\_\_\_\_ 19\_\_\_\_

SECRETARY

PRESIDENT

B Y - L A W S  
OF

ANTELOPE PARK MUTUAL WATER COMPANY  
A California Corporation.

Article I.  
OFFICES

Section 1. PRINCIPAL OFFICE. The principal office for the transaction of business of the corporation is hereby fixed and located at 1725 West Ave. K-8, City of Lancaster, State of California. The Board of Directors is hereby granted full power and authority to change said principal office from one location to another in said county.

Section 2. OTHER OFFICES. Branch or subordinate offices may at any time be established by the Board of Directors at any place or places where the corporation is qualified to do business.

Article II.  
MEETINGS OF STOCKHOLDERS

Section 1. PLACE OF MEETINGS. All annual meetings of shareholders shall be held at the principal office of the corporation, and all other meetings of shareholders shall be held either at the principal office or at any other place within or without the State of California which may be designated either by the Board of Directors pursuant to authority hereinafter granted to said board, or by written consent of all shareholders entitled to vote thereat, given either before or after the meeting and filed with the secretary of the corporation.

Section 2. ANNUAL MEETINGS. The annual meetings of shareholders shall be held on the 1st day of March, of each year, at 2 o'clock P. M.; provided, however, that should said day fall upon a legal holiday, then such annual meeting of shareholders shall be held at the same time and place on the next day thereafter ensuing which is not a legal holiday.

Written notice of each annual meeting shall be given to each shareholder entitled to vote thereat, either personally or by mail or other means of written communication, charges prepaid, addressed to such shareholder at his or her address appearing on the books of the corporation or given by him or her to the corporation for the purpose of notice. If a shareholder give no address, notice shall be deemed to have been given him or her if sent by mail or other means of written communication addressed to the place where the principal office of the corporation is situated, or if published at least once in some newspaper of general circulation in the county in which said office is located. All such notices shall be sent to such shareholder entitled thereto, not less than 3 days before such annual meeting, and shall specify the place, day and hour of such meeting, and shall also state the general nature of the business or proposal to be considered or acted upon at such meeting before action may be taken at such meeting on:

directors to be elected, and he or she may cast all of such votes for a single director or may distribute them, as he or she may see fit.

Section 7. QUORUM: The presence in person or by proxy of the holders of 50 per cent of the shares entitled to vote at any meeting shall constitute a quorum for the transaction of business. The shareholders present at a duly called or held meeting at which a quorum is present may continue to do business until adjournment, notwithstanding the withdrawal of enough shareholders to leave less than a quorum.

Section 8. CONSENT OF ABSENTEES: The proceedings and transactions of any meeting of shareholders, either annual or special, however called and noticed, shall be as valid as though had at a meeting duly held after regular call and notice, if a quorum be present either in person or by proxy, and if, either before or after the meeting, each of the shareholders entitled to vote, not present in person or by proxy, sign a written waiver of notice, or a consent to the holding of such meeting, or an approval of the minutes thereof. All such waivers, consents or approvals shall be filed with the corporate records or made a part of the minutes of the meeting.

Section 9. ACTION WITHOUT MEETING: Any action, which under the provisions of title one of part four of division first of the California Civil Code may be taken at a meeting of the shareholders, may be taken without a meeting if authorized by a writing signed by all of the holders of shares who would be entitled to vote at a meeting for such purpose, and filed with the secretary of the corporation.

Section 10. PROXIES: Every person entitled to vote or execute consents shall have the right to do so either in person or by an agent or agents authorized by a written proxy executed by such person or his or her duly authorized agent and filed with the secretary of the corporation; provided, that no such proxy shall be valid after the expiration of eleven (11) months from the date of its execution, unless the shareholder executing it specifies therein the length of time for which such proxy is to continue in force, which in no case shall exceed seven (7) years from the date of its execution.

### Article III. DIRECTORS

Section 1. POWERS: Subject to limitations of the Articles of Incorporation, of the by-laws and particularly Article II, section 6 of these by-laws, and of title one of part four of division first of the California Civil Code as to action to be authorized or approved by the shareholders, and subject to the duties of directors as prescribed by the by-laws, all corporate power shall be exercised by or under the authority of, and the business and affairs of the corporation shall be controlled by, the Board of Directors. Without prejudice to such general powers, but subject to the same limitations, it is hereby expressly declared that the directors shall have the following powers, to wit:

First: To select and remove all other officers, agents and employees of the corporation, prescribe such powers and duties for them as may not be inconsistent with law, with the Articles of Incorporation or

(5)

Section 4. VACANCIES: Vacancies in the Board of Directors may be filled by a majority of the remaining directors, though less than a quorum, or by a sole remaining director, and each director so elected shall hold office until his or her successor is elected at an annual or special meeting of the shareholders.

A vacancy or vacancies in the Board of Directors shall be deemed to exist in case of the death, resignation or removal of any director, or if the authorized number of directors be increased, or if the shareholders fail at any annual or special meeting of shareholders at which any director or directors are elected, to elect the full authorized number of directors to be voted for at that meeting.

The shareholders may elect a director or directors at any time to fill any vacancy or vacancies not filled by the directors. If the Board of Directors accept the resignation of a director tendered to take effect at a future time, the board or the shareholders shall have power to elect a successor to take office when the resignation is to become effective.

No reduction of the authorized number of directors shall have the effect of removing any director prior to the expiration of his or her term of office.

Section 5. PLACE OF MEETING: Regular meetings of the board of directors shall be held at any place within or without the State which has been designated from time to time by resolution of the board or by written consent of all members of the board. In the absence of such designation, regular meetings shall be held at the principal office of the corporation. Special meetings of the board may be held either at a place so designated or at the principal office.

Section 6. ORGANIZATION MEETING: Immediately following each annual meeting of shareholders, the Board of Directors shall hold a regular meeting for the purpose of organization, election of officers, and the transaction of other business. Notice of such meetings is hereby dispensed with.

Section 7. OTHER REGULAR MEETINGS: Other regular meetings of the Board of Directors shall be held without call on the ~~1st~~ day of each month, at 2 o'clock P.M.; provided, however, that should said day fall upon a legal holiday, then said meeting shall be held at the same time and place on the next day thereafter ensuing which is not a legal holiday. Notice of all such regular meetings of the Board of Directors is hereby dispensed with.

Section 8. SPECIAL MEETINGS: Special meetings of the Board of Directors for any purpose or purposes shall be called at any time by the president, or, if he is absent or unable or refuses to act, by any vice-president, or, if he is absent or unable or refuses to act, by any director.

Written notice of the time and place of special meetings shall be delivered personally to the directors or sent to each director by mail or other form of written communication, charges prepaid, addressed to him or her at his or her address as it is shown upon the records of the corporation, or if it is not so shown on such records or is not readily



1. President
2. Vice-President
3. Secretary
4. Treasurer
- 5.
- 6.

The corporation may also have, at the discretion of the Board of Directors, a Chairman of the Board, one or more additional vice-presidents, one or more assistant-secretaries, one or more assistant-treasurers, and such other officers as may be appointed in accordance with the provisions of Section 3 of this Article. Officers other than the president and chairman of the board, need not be directors. One person may hold two or more offices, except those of president and secretary.

Section 2. ELECTIONS: The officers of the corporation, except such officers as may be appointed in accordance with the provisions of Sections 3 or 5 of this Article, shall be chosen annually by the Board of Directors, and each shall hold his or her office at the pleasure of the Board of Directors, who may, either at a regular or special meeting, remove any such officer and appoint his or her successor.

Section 3. SUBORDINATE OFFICERS, ETC.: The Board of Directors may appoint such other officers as the business of the corporation may require, each of whom shall hold office for such period, have such authority and perform such duties as are provided in the by-laws or as the Board of Directors may from time to time determine.

Section 4. REMOVAL AND RESIGNATION: Any officer may be removed, either with or without cause, by a majority of the directors at the time in office, at a regular or special meeting of the board, or, except in case of an officer chosen by the Board of Directors, by any officer upon whom such power of removal may be conferred by the Board of Directors.

Any officer may resign at any time by giving written notice to the Board of Directors or to the president, or to the secretary of the corporation. Any such resignation shall take effect at the date of the receipt of such notice or at any later time specified therein; and unless otherwise specified therein, the acceptance of such resignation shall not be necessary to make it effective.

Section 5. VACANCIES: A vacancy in any office because of death, resignation, removal, disqualification or any other cause shall be filled in the manner prescribed in the by-laws for regular appointments to such office.

Section 6. CHAIRMAN OF THE BOARD: The Chairman of the Board, if there shall be such an officer, shall, if present, preside at all meetings of the Board of Directors, and exercise and perform such other powers and duties as may be from time to time assigned to him or her by the Board of Directors as prescribed by the by-laws.

Section 7. PRESIDENT: Subject to such supervisory powers, if any, as may be given by the Board of Directors to the Chairman of the Board, if there be such an officer, the president shall be the chief executive officer of the corporation and shall, subject to the control of the Board of

of all of his or her transactions as treasurer and of the financial condition of the corporation, and shall have such other powers and perform such other duties as may be prescribed by the Board of Directors or the by-laws.

## Article V. MISCELLANEOUS

Section 1. RECORD DATE AND CLOSING STOCK BOOKS: The Board of Directors may fix a time, in the future, not exceeding 30 days preceding the date of any meeting of shareholders, and not exceeding 30 days preceding the date fixed for the payment of any dividend or distribution, or for the allotment of rights, or when any change or conversion or exchange of shares shall go into effect, as a record date for the determination of the shareholders entitled to notice of and to vote at any such meeting, or entitled to receive any such dividend or distribution, or any such allotment of rights, or to exercise the rights in respect to any such change, conversion or exchange of shares, and in such case only shareholders of record on the date so fixed shall be entitled to notice of and to vote at such meeting, or to receive such dividend, distribution or allotment of rights, or to exercise such rights, as the case may be, notwithstanding any transfer of any shares on the books of the corporation after any record date fixed as aforesaid. The Board of Directors may close the books of the corporation against transfers of shares during the whole, or any part of any such period.

Section 2. INSPECTION OF CORPORATE RECORDS: The share register or duplicate share register, the books of account, and minutes of proceedings of the shareholders and directors shall be open to inspection upon the written demand of any shareholder or the holder of a voting trust certificate, at any reasonable time, and for a purpose reasonably related to his or her interests as a shareholder, and shall be exhibited at any time when required by the demand of 50 per cent of the shares represented at any shareholders' meeting. Such inspection may be made in person or by an agent or attorney, and shall include the right to make extracts. Demand of inspection other than at a shareholders' meeting shall be made in writing upon the president, secretary or assistant-secretary of the corporation.

Section 3. CHECKS, DRAFTS, ETC.: All checks, drafts or other orders for payment of money, notes or other evidences of indebtedness issued in the name of or payable to the corporation, shall be signed or endorsed by such person or persons and in such manner as, from time to time, shall be determined by resolution of the Board of Directors.

Section 4. ANNUAL REPORT: The Board of Directors of the corporation shall cause to be sent to the shareholders not later than 30 days after the close of the fiscal or calendar year an annual report in compliance with the provisions of Section 358 of the California Civil Code.

Section 5. CONTRACTS, ETC.: HOW EXECUTED: The Board of Directors, except as the by-laws or Articles of Incorporation otherwise provide, may authorize any officer or officers, agent or agents, to enter into any contract or execute any instrument in the name of and on behalf of the corporation, and such authority may be general or confined to specific instances; and unless so authorized by the Board of Directors, no officer,

11

Article VI.  
AMENDMENTS

Section 1. POWER OF SHAREHOLDERS: New by-laws may be adopted or these by-laws may be amended or repealed by the vote of shareholders entitled to exercise 51 per cent of the voting power of the corporation or by the written assent of such shareholders.

Section 2. POWER OF DIRECTORS: Subject to the right of shareholders as provided in Section 1 of this Article VI to adopt, amend or repeal by-laws, by-laws other than a by-law or amendment thereof changing the authorized number of directors may be adopted, amended or repealed by the Board of Directors.

Article VII.  
SEAL

The corporation shall have a common seal consisting of the following words: Antelope Park Mutual Water Company

KNOW ALL MEN BY THESE PRESENTS:

That we, the undersigned, being all of the directors of the foregoing corporation, do hereby assent to the foregoing by-laws and adopt the same as the by-laws of this corporation.

IN WITNESS WHEREOF, we have hereunto subscribed our names  
this 6th day of May, 1947.

_____	_____
_____	_____
_____	_____
_____	_____
_____	_____

Resolutions & Amendments

Addition to By-laws: Article 5, addition to be section 6A  
Owner of each numbered parcel, tract 14728 shall be entitled  
to purchase and own one (1) share of stock in the Antelope Park  
Mutual Water Company and said share shall be transferred only  
with said parcel and is appurtenant thereto. Adopted Dec. 11, 1958 (10)

Section 10 Article 5 amended to read:

Each shareholder shall be charged a monthly fee in an amount to  
be determined upon by the board of directors. Said fee shall be  
based on an estimate of the amount of money necessary to maintain  
the purposes of the corporation, namely providing water for the  
shareholders. Such fees shall be equal for each residence and or  
commercial building owned by a shareholder of the corporation.  
Commercial building rates shall be determined by the board of  
directors in event that water usage exceeds normal requirements. (10)

From the minutes of the Annual Meeting of 1953

Mr. Dornbush made a motion that Article 3, Sec 2 of  
the by-laws of the Corporation be amended to read that  
the authorized number of directors of the corporation  
shall be five instead of three. Motion was seconded,  
vote taken, motion carried unanimously. (4)

Article 2 Section 7 amended to read:

The presence in person or by proxy of the holders of  
25 percent of the shares, etc. (3)

From the minutes of the Annual Meeting of 1953

Motion was made by Otis Fairchild that Article 2, Sec 2  
of the by-laws of the corporation be amended to read  
that the annual meeting of the shareholders be held  
on the first day of March, other than a Sunday or legal  
holiday at a time and place selected by the directors. (1)  
Motion was seconded by Mr. Perkey and carried unanimously.

FROM THE MINUTES OF ANNUAL MEETING OF MARCH 5, 1957

A motion was made by Mr. Schwabacher that Article 2 Section 6 of the  
By-Laws now reading "it shall require at least 51 per cent of the shares  
of the issued and outstanding stock of the said corporation to vote  
affirmatively before any resolution may be passed;" be changed so as to  
read "it shall require at least 51 percent of the members attending any  
duly called meeting of the said corporation to vote affirmatively before  
any resolution may be passed." (2)