

*****PLEASE COMPLETE. SUBMIT THE ORIGINAL AND MAKE A COPY FOR YOUR RECORDS*****
State of California

State Water Resources Control Board, Division of Water Rights
P.O. BOX 2000, SACRAMENTO, CA 95812-2000
Info: (916) 341-5300, FAX: (916) 341-5400, Web: <http://www.waterrights.ca.gov>

ANNUAL NOTICE OF GROUNDWATER EXTRACTION AND DIVERSION FOR 2000

PLEASE READ THE GENERAL INFORMATION ON THE REVERSE SIDE BEFORE COMPLETING THIS NOTICE
REQUIRED FEES: A filing fee of \$5.00 is required for each Annual Notice of Groundwater Extraction and Diversion. Check or money order should indicate your recordation number(s) and be made payable to: State Water Resources Control Board. Do not send cash.
DEADLINE: Notices must be postmarked no later than June 30, 2001 in order to be recorded.

Owner of Record: L A CITY DEPT OF AIRPORTS ; PROPERTY MANAGER, PALMDALE REGIONAL AIRPORT

PALMDALE REGIONAL AIRPORT
ATTENTION: PROPERTY MANAGER
39516 NORTH 25TH ST EAST
PALMDALE, CA 93550-2158

Recordation No.: 6193390
Password: _____
Phone Number: (661) 266-7602

Owner's Designation of Well

60th STREET EAST AND AVENUE N

State Well Number

06N/11W

Parcel Number

001 JUL -3 11 4:22

STATE WATER RESOURCES
CONTROL BOARD
SACRAMENTO

STATE WATER RESOURCES
CONTROL BOARD

If the above information is inaccurate, please line it out in red and provide current information. Notify this office if ownership or address changes occur during the coming year.

1. TYPE OF DIVERSION

☒ Groundwater extraction or ☐ Surface diversion

2. OWNERSHIP. Person listed below is:

- ☐ Owner of land on which well or point of diversion is located, and is extracting/diverting water.
☐ Lessee of land on which well or point of diversion is located, and is extracting/diverting water.
☒ Owner of land, but lessee is extracting/diverting water.
☐ Other. Please explain: _____

3. AMOUNT OF GROUNDWATER EXTRACTED DURING CALENDAR YEAR

4. AMOUNT OF SURFACE WATER DIVERTED DURING CALENDAR YEAR

5. METHOD OF MEASUREMENT ☐ Water Meter ☐ Power Meter ☒ Nonmetered or Estimated
6. TYPE OF WATER USE ☒ Agricultural ☐ Domestic or Municipal ☐ Other: _____

7. ACTION REQUESTED:

- ☐ Close this file. (Files may be reopened at any time - fee required.)
☒ Record my water use. (Fee required)
☐ Do not record my water use but keep my name on mailing list. (No fee required)

☐ Transfer this file to:

(NEW OWNER'S FIRST NAME)

(M. NAME)

(LAST NAME)

Company Name: _____

Address: _____

(MAILING ADDRESS)

(CITY)

(STATE)

(ZIP CODE)

Telephone: () _____

Effective Date: _____

8. SUPPLEMENTAL INFORMATION. Please list any changes in your project since last year (new pump, new land irrigation, new method of irrigation, etc.) or any other comments.
VEGETABLE PRODUCTION - THIS WELL HAS BEEN OPERATING FOR AT LEAST FIVE (5)
YEARS, BUT WAS OMITTED FROM THE 1999 REPORT IN ERROR.

9. CERTIFICATION AND SIGNATURE: I certify that the foregoing statements are true and correct, to the best of my knowledge.

Signature: Lewis W. Trost

Today's Date 6/29/2001

Printed Name LEWIS

(FIRST NAME)

(M. NAME)

(LAST NAME)

Company Name: PALMDALE REGIONAL AIRPORT

THIS SPACE FOR OFFICE USE ONLY

R. 2454 AMT: 5

EXHIBIT E- TO CITY OF LOS ANGELES' RESPONSE TO DISCOVERY ORDER

[FINAL SUBMITTED VERSION]

ANNUAL NOTICE OF GROUNDWATER EXTRACTION AND DIVERSION FOR 2011

Primary Owner: L A WORLD AIRPORT

Recordation Number: G193391

Date Submitted: 2012-03-23

1. Reporting to a Local Agency	
Local Agency	Submitter does not report to a local agency.

2. Type(s) of Diversion	
a. Groundwater Extraction	> 25 acre-feet
b. Surface Diversion	None

3. Ownership Type of Owner(s) on Record	
Ownership Type	Owner of land, but lessee is extracting/diverting water

4. Amount of Groundwater Extracted During Calendar Year	
Amount Extracted	463.209 Acre-Feet

5. Amount of Surface Water Diverted or Used	
Not applicable; Surface Diversion was not chosen as a type of diversion.	

5d. Maximum Rate of Surface Water Diversion	
Not applicable; Surface Diversion was not chosen as a type of diversion.	

6. Method of Measurement	
Method of Measurement	Water Meter

7. Type(s) of Use	
Irrigation	203.5 Acres Mixed Crop Types

8. Action Requested	
Action Requested	Record my water use

9. Supplemental Information	
Supplemental Information	

Attachments		
File Name	Descripton	Size
No Attachments		

Contact Information of the Person Submitting the Form	
First Name	Howard
Last Name	Alger
Relation to Water Right	Authorized Official 
I read the above and agree	Yes

[FINAL SUBMITTED VERSION]**ANNUAL NOTICE OF GROUNDWATER EXTRACTION AND DIVERSION FOR 2010**

Primary Owner: L A WORLD AIRPORT

Recordation Number: G193391

Date Submitted: 2011-04-05

Reporting to a Local Agency	
Local Agency	Submitter does not report to a local agency.

Type(s) of Diversion	
Groundwater Extraction	> 25 acre-feet
Surface Diversion	None

Ownership Type of Owner(s) on Record	
Ownership Type	Owner of land, but lessee is extracting/diverting water

Amount of Groundwater Extracted During Calendar Year	
Amount Extracted	598.161 Acre-Feet

Amount of Surface Water Diverted or Used	
Not applicable; Surface Diversion was not chosen as a type of diversion.	

Maximum Rate of Surface Water Diversion	
Not applicable; Surface Diversion was not chosen as a type of diversion.	

Method of Measurement	
Method of Measurement	Power Meter

Purpose(s) of Use	
Irrigation	203.5 Acres Mixed Crop Types

Action Requested	
Action Requested	Record my water use

Supplemental Information	
Supplemental Information	

Attachments	
File Name	Size
No Attachments	

Contact Information of the Person Submitting the Form	
First Name	Howard
Last Name	Alger
I read the above and agree	Yes



PLEASE COMPLETE. SUBMIT THE ORIGINAL AND MAKE A COPY FOR YOUR RECORDS
State of California, State Water Resources Control Board, Division of Water Rights
P.O. BOX 2000, SACRAMENTO, CA 95812-2000
Info: (916) 341-5300, FAX: (916) 341-5400, Web: http://www.waterrights.ca.gov
ANNUAL NOTICE OF EXTRACTION AND DIVERSION OF WATER
(GROUNDWATER RECORDATION PROGRAM)

G193391

2009

If the owner information below is wrong or missing, please correct.
PRIMARY OWNER OF RECORD PALMDALE REGIONAL AIRPORT

PRIMARY CONTACT OR AGENT FOR MAIL & REPORTING:
~~PALMDALE REGIONAL AIRPORT~~ *Los Angeles World Airports*
~~PROPERTY MANAGER~~ *Environmental Manager*
~~30546 NORTH 125TH ST EAST~~ *7301 World Way West 3rd Floor*
~~PALMDALE, CA 93550-2150~~ *Los Angeles, CA 90045*
Owner's Designation of Well State Well Number Parcel Number
50TH ST E & AVE 0-10 06N/11W-16J S 3244-030-028

RECORDATION NO: G193391
CONTACT PHONE NO: ~~(804) 200-7502~~ *424 646 6500*

DEADLINE: Notices must be received no later than June 30, 2010 in order to be recorded.
REQUIRED FEES: A filing fee of \$50.00 is required for each Annual Notice of Groundwater Extraction and Diversion. Check or money order should indicate your recordation number(s) and be made payable to: State Water Resources Control Board. Do not send cash.

PLEASE READ THE GENERAL INFORMATION ON THE REVERSE SIDE BEFORE COMPLETING THIS NOTICE

If the above information is inaccurate, please line it out in red and provide current information. Notify this office if ownership or address changes occur during the coming year.

1. TYPE OF DIVERSION ☒ Groundwater extraction or ☐ Surface diversion
2. OWNERSHIP. Person listed below is:
☐ Owner of land on which well or point of diversion is located, and is extracting/diverting water.
☐ Lessee of land on which well or point of diversion is located, and is extracting/diverting water.
☒ Owner of land, but lessee is extracting/diverting water.
☐ Other: Please explain: _____
3. AMOUNT OF GROUNDWATER EXTRACTED DURING CALENDAR YEAR →
4. AMOUNT OF SURFACE WATER DIVERTED DURING CALENDAR YEAR →
5. METHOD OF MEASUREMENT ☒ Water Meter ☐ Power Meter ☐ Non-metered or Estimated
6. TYPE OF WATER USE ☒ Agricultural ☐ Domestic or Municipal ☐ Other: _____
7. ACTION REQUESTED (Check one):
☐ Reopen file. (Fee required)
☐ Close this file. (No fee required)
☒ Record my water use. (Fee required)
☐ Do not record my water use but keep my name on mailing list. (No fee required)

646.096 ☒ acre-feet
(Must be a specific number) ☐ cubic-feet
☐ gallons

☐ acre-feet
☐ cubic-feet
☐ gallons
Annual quantity _____
Season of diversion
Begin _____
End _____
Maximum rate of diversion _____

Transfer this file to: *Environmental Services Division*
Company Name: *Los Angeles World Airports* (NEW OWNER'S FIRST NAME) (M. NAME) (LAST NAME)
Address: *7301 World Way West 3rd Floor Los Angeles CA 90045*
Telephone: *424 646 6500* (MAILING ADDRESS) (CITY) (STATE) (ZIP CODE)
Effective Date: *January 1, 2010*

8. SUPPLEMENTAL INFORMATION. Please list any changes in your project since last year (new pump, new land irrigation, new method of irrigation, etc.) or any other comments.

9. CERTIFICATION AND SIGNATURE: I certify that the foregoing statements are true and correct to the best of my knowledge.

Signature: _____ Date: _____

Printed Name: *Robert Freeman*
(FIRST NAME) (M. NAME) (LAST NAME)

Company Name: *Los Angeles World Airports*

THIS SPACE FOR OFFICE USE ONLY R. _____ AMT: _____

(Continues on reverse)

GENERAL INFORMATION

The dependence on groundwater in the Counties of Riverside, San Bernardino, Los Angeles, and Ventura has resulted in diminishing water supplies. As water becomes more scarce, determination of your water rights by the courts may become necessary. Your Annual Notice of Groundwater Extraction and Diversion is required to establish a record of water use which can assist the court in determining your rights.

The California Water Code requires you to record your annual surface and groundwater use if your total groundwater extractions from all wells exceed 25 acre-feet. Extractions of less than 10 acre-feet from a single well need not be reported. Although there is no penalty for failure to file the annual notice, failure to file is considered nonuse of water. Therefore, persons who do not file notices may have difficulty in supporting a claim of water use during a lawsuit to establish ownership of groundwater rights.

Exceptions: (1) If you are currently reporting your pumpage to a watermaster, your water use is already on record, and you are exempt from the requirement of filing a notice, or (2) if annual water use is less than the required amounts, filing is optional because these minimal amounts would probably not be affected by a water right dispute. All optional notices that are accompanied by appropriate fees will be recorded.

Should you require additional information about the Water Code requirements or assistance in completing this form, please write to the address on the top of this form, or telephone (916) 341-5300.

TABLE 1: AGRICULTURAL WATER USE WORKSHEET (Optional)

To estimate your use of water, indicate below the crop type and number of acres. Then find the average irrigation requirement for each crop using Table II. Multiply acres (column 1) to applied water depth (column 2) to determine the amount pumped (column 3). Then total all amounts in column 3 to determine total irrigation use.

CROP	COLUMN 1	COLUMN 2	COLUMN 3
	ACRES	AVERAGE APPLIED WATER DEPTH (acre-feet per acre)	AMOUNT PUMPED (acre-feet) (column 1 X column 2)
CONVERSION FACTORS One acre-foot (af) = 43,560 cubic feet = 325,900 gallons One miner's inch is approximately 9 gallons per minute. An acre-foot covers one acre of land, one foot deep			TOTAL IRRIGATION USE

TABLE II: AVERAGE DEPTH OF WATER APPLIED TO IRRIGATE EACH CROP (acre-feet per acre)¹

LOCALITY ²	ALFALFA	AVOCADOS	BEANS	DATES	LEMONS	LETTUCE	PERMANENT PASTURE	TOMATOES
1. Los Angeles County								
a. Coastal Basin		2.0 - 2.5			2.0 - 2.5	2.0 - 2.5		
b. Antelope Valley	7.6						7.4	
2. Eastern Riverside County								
a. Coachella & Blythe Area	9.0 - 10.0			7.9 - 9.0	5.5 - 6.0	3.6 - 4.2	9.0 - 10.0	4.3 - 6.4
3. Western Riverside County	4.0 - 4.5	2.5 - 3.0			2.5 - 3.0	2.0 - 2.5	4.5 - 5.0	
4. San Bernardino County								
a. Chino Area	4.0 - 4.5	2.5 - 3.0			2.5 - 3.0	2.0 - 2.5	4.5 - 5.0	2.3 - 2.5
b. San Bernardino Area	4.0 - 4.5	2.5 - 3.0			2.5 - 3.0	2.0 - 2.5	4.0 - 5.0	2.3 - 2.5
c. Barstow-Apple Valley	6.0 - 6.5						6.0 - 6.5	
d. Ontario	4.0 - 4.5	2.5 - 3.0			2.5 - 3.0		4.0 - 5.0	2.3 - 2.5
e. Highlands-Redlands	4.0 - 4.5	2.5 - 3.0			2.5 - 3.0		4.0 - 5.0	2.3 - 2.5
5. Ventura County	4.0 - 4.5	2.3 - 2.5	1.3 - 1.5		2.3 - 2.5	2.0 - 2.5	4.0 - 4.5	2.0 - 2.5

¹ Based on information provided by Agricultural Extension Service of the University of California.

Updated: Department of Water Resources, Southern District // Backup data for the California Water Plan, Bulletin 160-98. Date August 21, 2000

² Unit use values for crops grown in each region.

GW-ANN-EXTRT (1-06)

G193391

G193391



G193391

A

PLEASE COMPLETE. SUBMIT THE ORIGINAL AND MAKE A COPY FOR YOUR RECORDS

State of California, State Water Resources Control Board, Division of Water Rights

P.O. BOX 2000, SACRAMENTO, CA 95812-2000

Info: (916) 341-5300, FAX: (916) 341-5400, Web: <http://www.waterrights.ca.gov>

ANNUAL NOTICE OF GROUNDWATER EXTRACTION AND DIVERSION
(GROUNDWATER RECORDATION PROGRAM)

G193391

2007

CN

If the owner information below is wrong or missing, please correct.

OWNER(S) OF RECORD PALMDALE REGIONAL AIRPORT

PRIMARY CONTACT OR AGENT FOR MAIL & REPORTING:

PALMDALE REGIONAL AIRPORT
PROPERTY MANAGER
39516 NORTH 25TH ST EAST
PALMDALE, CA 93550-2158

RECORDATION NO: G193391
CONTACT PHONE NO: (661) 266-7602

Owner's Designation of Well
50TH ST E & AVE 0-10

State Well Number
06N/11W-16J S

Parcel Number
3244-030-028

DEADLINE: Notices must be received no later than **June 30, 2007** in order to be recorded.

REQUIRED FEES: A filing fee of \$115.00 is required for each Annual Notice of Groundwater Extraction and Diversion. Check or money order should indicate your recordation number(s) and be made payable to: State Water Resources Control Board. Do not send cash.

PLEASE READ THE GENERAL INFORMATION ON THE REVERSE SIDE BEFORE COMPLETING THIS NOTICE

If the above information is inaccurate, please line it out in red and provide current information. Notify this office if ownership or address changes occur during the coming year.

1. **TYPE OF DIVERSION** ☒ Groundwater extraction or ☐ Surface diversion

2. **OWNERSHIP. Person listed below is:**

☐ Owner of land on which well or point of diversion is located, and is extracting/diverting water.

☐ Lessee of land on which well or point of diversion is located, and is extracting/diverting water.

☒ Owner of land, but lessee is extracting/diverting water.

☐ Other: Please explain: _____

3. **AMOUNT OF GROUNDWATER EXTRACTED DURING CALENDAR YEAR** →

4. **AMOUNT OF SURFACE WATER DIVERTED DURING CALENDAR YEAR** →

5. **METHOD OF MEASUREMENT** ☐ Water Meter ☐ Power Meter ☒ Non-metered or Estimated

6. **TYPE OF WATER USE** ☒ Agricultural ☐ Domestic or Municipal ☐ Other: _____

7. **ACTION REQUESTED (Check one):**

☐ Reopen file. (Fee required)

☐ Close this file. (No fee required)

☐ Record my water use. (Fee required)

☐ Do not record my water use but keep my name on mailing list. (No fee required)

767.907 ☒ acre-feet
☐ cubic-feet
☐ gallons
(Must be a specific number)

Annual quantity _____ ☐ acre-feet
Season of diversion _____ ☐ cubic-feet
Begin _____ ☐ gallons
End _____
Maximum rate of diversion _____

Transfer this file to: _____

(NEW OWNER'S FIRST NAME) (M. NAME) (LAST NAME)

Company Name: _____

Address: _____

(MAILING ADDRESS) (CITY) (STATE) (ZIP CODE)

Telephone: () _____ Effective Date: _____

8. **SUPPLEMENTAL INFORMATION.** Please list any changes in your project since last year (new pump, new land irrigation, new method of irrigation, etc.) or any other comments.

VEGETABLE PRODUCTION

9. **CERTIFICATION AND SIGNATURE:** I certify that the forgoing statements are true and correct to the best of my knowledge.

Signature: _____ Date: 5/29/08

Printed Name: Ron (FIRST NAME) Domosh (LAST NAME)

Company Name: _____ THIS SPACE FOR OFFICE USE ONLY R. 2727 AMT: \$115.00

EXHIBIT E- TO CITY OF LOS ANGELES' RESPONSE TO DISCOVERY ORDER

GENERAL INFORMATION

The dependence on groundwater in the Counties of Riverside, San Bernardino, Los Angeles, and Ventura has resulted in diminishing water supplies. As water becomes more scarce, determination of your water rights by the courts may become necessary. Your Annual Notice of Groundwater Extraction and Diversion is required to establish a record of water use which can assist the court in determining your rights.

The California Water Code requires you to record your annual surface and groundwater use if your total groundwater extractions from all wells exceed 25 acre-feet. Extractions of less than 10 acre-feet from a single well need not be reported. Although there is no penalty for failure to file the annual notice, failure to file is considered nonuse of water. Therefore, persons who do not file notices may have difficulty in supporting a claim of water use during a lawsuit to establish ownership of groundwater rights.

Exceptions: (1) If you are currently reporting your pumpage to a watermaster, your water use is already on record, and you are exempt from the requirement of filing a notice, or (2) if annual water use is less than the required amounts, filing is optional because these minimal amounts would probably not be affected by a water right dispute. All optional notices that are accompanied by appropriate fees will be recorded.

Should you require additional information about the Water Code requirements or assistance in completing this form, please write to the address on the top of this form, or telephone (916) 341-5300.

TABLE 1: AGRICULTURAL WATER USE WORKSHEET (Optional)

To estimate your use of water, indicate below the crop type and number of acres. Then find the average irrigation requirement for each crop using Table II. Multiply acres (column 1) to applied water depth (column 2) to determine the amount pumped (column 3). Then total all amounts in column 3 to determine total irrigation use.

CROP	COLUMN 1	COLUMN 2	COLUMN 3
	ACRES	AVERAGE APPLIED WATER DEPTH (acre-feet per acre)	AMOUNT PUMPED (acre-feet) (column 1 X column 2)
CONVERSION FACTORS One acre-foot (af) = 43,560 cubic feet = 325,900 gallons One miner's inch is approximately 9 gallons per minute. An acre-foot covers one acre of land, one foot deep			TOTAL IRRIGATION USE

TABLE II: AVERAGE DEPTH OF WATER APPLIED TO IRRIGATE EACH CROP (acre-feet per acre)¹

LOCALITY ²	ALFALFA	AVOCADOS	BEANS	DATES	LEMONS	LETTUCE	PERMANENT PASTURE	TOMATOES
1. Los Angeles County								
a. Coastal Basin		2.0 - 2.5			2.0 - 2.5	2.0 - 2.5		
b. Antelope Valley	5.5 - 6.0						5.5 - 6.0	
2. Eastern Riverside County								
a. Coachella & Blythe Area	9.0 - 10.0			7.9 - 9.0	5.5 - 6.0	3.6 - 4.2	9.0 - 10.0	4.3 - 6.4
3. Western Riverside County	4.0 - 4.5	2.5 - 3.0			2.5 - 3.0	2.0 - 2.5	4.5 - 5.0	
4. San Bernardino County								
a. Chino Area	4.0 - 4.5	2.5 - 3.0			2.5 - 3.0	2.0 - 2.5	4.5 - 5.0	2.3 - 2.5
b. San Bernardino Area	4.0 - 4.5	2.5 - 3.0			2.5 - 3.0	2.0 - 2.5	4.0 - 5.0	2.3 - 2.5
c. Barstow-Apple Valley	6.0 - 6.5						6.0 - 6.5	
d. Ontario	4.0 - 4.5	2.5 - 3.0			2.5 - 3.0		4.0 - 5.0	2.3 - 2.5
e. Highlands-Redlands	4.0 - 4.5	2.5 - 3.0			2.5 - 3.0		4.0 - 5.0	2.3 - 2.5
5. Ventura County	4.0 - 4.5	2.3 - 2.5	1.3 - 1.5		2.3 - 2.5	2.0 - 2.5	4.0 - 4.5	2.0 - 2.5

¹ Based on information provided by Agricultural Extension Service of the University of California.

Updated: Department of Water Resources, Southern District // Backup data for the California Water Plan, Bulletin 160-98. Date August 21, 2000

² Unit use values for crops grown in each region.

PLEASE COMPLETE. SUBMIT THE ORIGINAL AND MAKE A COPY FOR YOUR RECORDS***

State of California, State Water Resources Control Board, Division of Water Rights

P.O. BOX 2000, SACRAMENTO, CA 95812-2000

Info: (916) 341-5300, FAX: (916) 341-5400, Web: <http://www.waterrights.ca.gov>

ANNUAL NOTICE OF GROUNDWATER EXTRACTION AND DIVERSION

G193391

2006

If the owner information below is wrong or missing, please correct.
PRIMARY OWNER OF RECORD PALMDALE REGIONAL AIRPORT

RECORDATION NO: G193391
CONTACT PHONE NO: (661) 266-7602

PRIMARY CONTACT OR AGENT FOR MAIL & REPORTING
PALMDALE REGIONAL AIRPORT
PROPERTY MANAGER
39516 NORTH 25TH ST EAST
PALMDALE, CA 93550-2158

Owner's Designation of Well
50TH ST E & AVE 0-10

State Well Number
06N11W-16J S

Parcel Number
3244-030-028

DEADLINE: Notices must be received no later than June 30, 2007 in order to be recorded.

REQUIRED FEES: A filing fee of \$115.00 is required for each Annual Notice of Groundwater Extraction and Diversion. Check or money order should indicate your recordation number(s) and be made payable to: State Water Resources Control Board. Do not send cash.

PLEASE READ THE GENERAL INFORMATION ON THE REVERSE SIDE BEFORE COMPLETING THIS NOTICE

If the above information is inaccurate, please line it out in red and provide current information. Notify this office if ownership or address changes occur during the coming year.

1. TYPE OF DIVERSION ☒ Groundwater extraction or ☐ Surface diversion

2. OWNERSHIP. Person listed below is:

- ☐ Owner of land on which well or point of diversion is located, and is extracting/diverting water.
☐ Lessee of land on which well or point of diversion is located, and is extracting/diverting water.
☒ Owner of land, but lessee is extracting/diverting water.
☐ Other: Please explain: _____

3. AMOUNT OF GROUNDWATER EXTRACTED DURING CALENDAR YEAR

4. AMOUNT OF SURFACE WATER DIVERTED DURING CALENDAR YEAR

5. METHOD OF MEASUREMENT ☐ Water Meter ☐ Power Meter ☒ Non-metered or Estimated

6. TYPE OF WATER USE ☒ Agricultural ☐ Domestic or Municipal ☐ Other: _____

7. ACTION REQUESTED (Check one):

- ☐ Reopen file. (Fee required)
☐ Close this file. (No fee required)
☒ Record my water use. (Fee required)
☐ Do not record my water use but keep my name on mailing list. (No fee required)

600	<input checked="" type="checkbox"/> acre-feet
(Must be a specific number)	<input type="checkbox"/> cubic-feet
	<input type="checkbox"/> gallons

Annual quantity _____	<input type="checkbox"/> acre-feet
Season of diversion	<input type="checkbox"/> cubic-feet
Begin _____	<input type="checkbox"/> gallons
End _____	
Maximum rate of diversion _____	

Transfer this file to: _____

Company Name: _____ (NEW OWNER'S FIRST NAME) (M. NAME) (LAST NAME)

Address: _____

Telephone: () _____ Effective Date: _____

8. SUPPLEMENTAL INFORMATION. Please list any changes in your project since last year (new pump, new land irrigation, new method of irrigation, etc.) or any other comments.

VEGETABLE PRODUCTION

9. CERTIFICATION AND SIGNATURE: I certify that the forgoing statements are true and correct to the best of my knowledge.

Signature: _____ Date: 6/24/2007

Printed Name: Ron Domash (FIRST NAME) (M. NAME) (LAST NAME)

Company Name: CITY OF LOS ANGELES, DEPT OF AIRPORTS, VAN NUYS AIRPORT

THIS SPACE FOR OFFICE USE ONLY

R. 2678 AMT: 115.00

GENERAL INFORMATION

The dependence on groundwater in the Counties of Riverside, San Bernardino, Los Angeles, and Ventura has resulted in diminishing water supplies. As water becomes more scarce, determination of your water rights by the courts may become necessary. Your Annual Notice of Groundwater Extraction and Diversion is required to establish a record of water use which can assist the court in determining your rights.

The California Water Code requires you to record your annual surface and groundwater use if your total groundwater extractions from all wells exceed 25 acre-feet. Extractions of less than 10 acre-feet from a single well need not be reported. Although there is no penalty for failure to file the annual notice, failure to file is considered nonuse of water. Therefore, persons who do not file notices may have difficulty in supporting a claim of water use during a lawsuit to establish ownership of groundwater rights.

Exceptions: (1) If you are currently reporting your pumpage to a watermaster, your water use is already on record, and you are exempt from the requirement of filing a notice, or (2) if annual water use is less than the required amounts, filing is optional because these minimal amounts would probably not be affected by a water right dispute. All optional notices that are accompanied by appropriate fees will be recorded.

Should you require additional information about the Water Code requirements or assistance in completing this form, please write to the address on the top of this form, or telephone (916) 341-5300.

TABLE 1: AGRICULTURAL WATER USE WORKSHEET (Optional)

To estimate your use of water, indicate below the crop type and number of acres. Then find the average irrigation requirement for each crop using Table II. Multiply acres (column 1) to applied water depth (column 2) to determine the amount pumped (column 3). Then total all amounts in column 3 to determine total irrigation use.

CROP	COLUMN 1 ACRES	COLUMN 2 AVERAGE APPLIED WATER DEPTH (acre-feet per acre)	COLUMN 3 AMOUNT PUMPED (acre-feet) (column 1 X column 2)
VEGETABLES	100	6.0	600
CONVERSION FACTORS One acre-foot (af) = 43,560 cubic feet = 325,900 gallons One miner's inch is approximately 9 gallons per minute. An acre-foot covers one acre of land, one foot deep			TOTAL IRRIGATION USE <div style="font-size: 1.5em; text-align: center;">600</div>

TABLE II: AVERAGE DEPTH OF WATER APPLIED TO IRRIGATE EACH CROP (acre-feet per acre)¹

LOCALITY ²	ALFALFA	AVOCADOS	BEANS	DATES	LEMONS	LETTUCE	PERMANENT PASTURE	TOMATOES
1. Los Angeles County								
a. Coastal Basin		2.0 - 2.5			2.0 - 2.5	2.0 - 2.5		
b. Antelope Valley	5.5 - 6.0						5.5 - 6.0	
2. Eastern Riverside County								
a. Coachella & Blythe Area	9.0 - 10.0			7.9 - 9.0	5.5 - 6.0	3.6 - 4.2	9.0 - 10.0	4.3 - 6.4
3. Western Riverside County	4.0 - 4.5	2.5 - 3.0			2.5 - 3.0	2.0 - 2.5	4.5 - 5.0	
4. San Bernardino County								
a. Chino Area	4.0 - 4.5	2.5 - 3.0			2.5 - 3.0	2.0 - 2.5	4.5 - 5.0	2.3 - 2.5
b. San Bernardino Area	4.0 - 4.5	2.5 - 3.0			2.5 - 3.0	2.0 - 2.5	4.0 - 5.0	2.3 - 2.5
c. Barstow-Apple Valley	6.0 - 6.5						6.0 - 6.5	
d. Ontario	4.0 - 4.5	2.5 - 3.0			2.5 - 3.0		4.0 - 5.0	2.3 - 2.5
e. Highlands-Redlands	4.0 - 4.5	2.5 - 3.0			2.5 - 3.0		4.0 - 5.0	2.3 - 2.5
5. Ventura County	4.0 - 4.5	2.3 - 2.5	1.3 - 1.5		2.3 - 2.5	2.0 - 2.5	4.0 - 4.5	2.0 - 2.5

¹ Based on information provided by Agricultural Extension Service of the University of California.

Updated: Department of Water Resources, Southern District // Backup data for the California Water Plan, Bulletin 160-98. Date August 21, 2000

² Unit use values for crops grown in each region.

****PLEASE COMPLETE. SUBMIT THE ORIGINAL AND MAKE A COPY FOR YOUR RECORDS*****

State of California, State Water Resources Control Board, Division of Water Rights

P.O. BOX 2000, SACRAMENTO, CA 95812-2000

Info: (916) 341-5300, FAX: (916) 341-5400, Web: <http://www.waterrights.ca.gov>

ANNUAL NOTICE OF GROUNDWATER EXTRACTION AND DIVERSION

~~0300050~~
G193391 ✓

If the owner information below is wrong or missing, please correct.

OWNER(S) OF RECORD PALMDALE REGIONAL AIRPORT

2005
PALMDALE REGIONAL AIRPORT
PROPERTY MANAGER
39516 NORTH 25TH ST EAST
PALMDALE CA 93550-2158

RECORDATION NO: ~~0300050~~
CONTACT PHONE NO: 661 266-7602

G193391 ✓

Owner's Designation of Well
50TH ST E & AVE 0-10

State Well Number
T6N/R11W-16JS

Parcel Number
3025-043-901

DEADLINE: Notices must be received no later than **August 31, 2006** in order to be recorded.

REQUIRED FEES: A filing fee of **\$115.00** is required for each Annual Notice of Groundwater Extraction and Diversion. Check or money order should indicate your recordation number(s) and be made payable to: State Water Resources Control Board. Do not send cash.

PLEASE READ THE GENERAL INFORMATION ON THE REVERSE SIDE BEFORE COMPLETING THIS NOTICE

If the above information is inaccurate, please line it out in red and provide current information. Notify this office if ownership or address changes occur during the coming year.

1. **TYPE OF DIVERSION** ☒ Groundwater extraction or ☐ Surface diversion

2. **OWNERSHIP. Person listed below is:**

- ☐ Owner of land on which well or point of diversion is located, and is extracting/diverting water.
☐ Lessee of land on which well or point of diversion is located, and is extracting/diverting water.
☒ Owner of land, but lessee is extracting/diverting water.
☐ Other: Please explain: _____

3. **AMOUNT OF GROUNDWATER EXTRACTED DURING CALENDAR YEAR** →

4. **AMOUNT OF SURFACE WATER DIVERTED DURING CALENDAR YEAR** →

5. **METHOD OF MEASUREMENT** ☐ Water Meter ☐ Power Meter ☒ Nonmetered or Estimated

6. **TYPE OF WATER USE** ☒ Agricultural ☐ Domestic or Municipal ☐ Other: _____

7. **ACTION REQUESTED (Check one):**

- ☐ Close this file. (Files may be reopened at any time – fee required)
☒ Record my water use. (Fee required)
☐ Do not record my water use but keep my name on mailing list. (No fee required)
☐ Transfer this file to: _____

Company Name: _____ (NEW OWNER'S FIRST NAME) (M. NAME) (LAST NAME)

Address: _____ (MAILING ADDRESS) (CITY) (STATE) (ZIP CODE)

Telephone: () _____ Effective Date: _____

8. **SUPPLEMENTAL INFORMATION.** Please list any changes in your project since last year (new pump, new land irrigation, new method of irrigation, etc.) or any other comments

VEGETABLE PRODUCTION

9. **CERTIFICATION AND SIGNATURE:** I certify that the forgoing statements are true and correct to the best of my knowledge.

Signature: Lewis W. Trout Date: JANUARY 29, 2007

Printed Name: LEWIS W. TROUT
(FIRST NAME) (M. NAME) (LAST NAME)

Company Name: CITY OF LOS ANGELES, DEPARTMENT OF AIRPORTS, PALMDALE REGIONAL AIRPORT

THIS SPACE FOR OFFICE USE ONLY

EXHIBIT E- TO CITY OF LOS ANGELES' RESPONSE TO DISCOVERY ORDER

FEB 6 2007

2668 AMT: 115-
3/15/07

GENERAL INFORMATION

The dependence on groundwater in the Counties of Riverside, San Bernardino, Los Angeles, and Ventura has resulted in diminishing water supplies. As water becomes more scarce, determination of your water rights by the courts may become necessary. Your Annual Notice of Groundwater Extraction and Diversion is required to establish a record of water use which can assist the court in determining your rights.

The California Water Code requires you to record your annual surface and groundwater use if your total groundwater extractions from all wells exceed 25 acre-feet. Extractions of less than 10 acre-feet from a single well need not be reported. Although there is no penalty for failure to file the annual notice, failure to file is considered nonuse of water. Therefore, persons who do not file notices may have difficulty in supporting a claim of water use during a lawsuit to establish ownership of groundwater rights.

Exceptions: (1) If you are currently reporting your pumpage to a watermaster, your water use is already on record, and you are exempt from the requirement of filing a notice, or (2) if annual water use is less than the required amounts, filing is optional because these minimal amounts would probably not be affected by a water right dispute. All optional notices that are accompanied by appropriate fees will be recorded.

Should you require additional information about the Water Code requirements or assistance in completing this form, please write to the address on the top of this form, or telephone (916) 341-5300.

TABLE 1: AGRICULTURAL WATER USE WORKSHEET (Optional)

To estimate your use of water, indicate below the crop type and number of acres. Then find the average irrigation requirement for each crop using Table II. Multiply acres (column 1) to applied water depth (column 2) to determine the amount pumped (column 3). Then total all amounts in column 3 to determine total irrigation use.

CROP	COLUMN 1 ACRES	COLUMN 2 AVERAGE APPLIED WATER DEPTH (acre-feet per acre)	COLUMN 3 AMOUNT PUMPED (acre-feet) (column 1 X column 2)
CONVERSION FACTORS One acre-foot (af) = 43,560 cubic feet = 325,900 gallons One miner's inch is approximately 9 gallons per minute. An acre-foot covers one acre of land, one foot deep			TOTAL IRRIGATION USE

TABLE II: AVERAGE DEPTH OF WATER APPLIED TO IRRIGATE EACH CROP (acre-feet per acre)¹

LOCALITY ²	ALFALFA	AVOCADOS	BEANS	DATES	LEMONS	LETTUCE	PERMANENT PASTURE	TOMATOES
1. Los Angeles County								
a. Coastal Basin		2.0 - 2.5			2.0 - 2.5	2.0 - 2.5		
b. Antelope Valley	5.5 - 6.0						5.5 - 6.0	
2. Eastern Riverside County								
a. Coachella & Blythe Area	9.0 - 10.0			7.9 - 9.0	5.5 - 6.0	3.6 - 4.2	9.0 - 10.0	4.3 - 6.4
3. Western Riverside County	4.0 - 4.5	2.5 - 3.0			2.5 - 3.0	2.0 - 2.5	4.5 - 5.0	
4. San Bernardino County								
a. Chino Area	4.0 - 4.5	2.5 - 3.0			2.5 - 3.0	2.0 - 2.5	4.5 - 5.0	2.3 - 2.5
b. San Bernardino Area	4.0 - 4.5	2.5 - 3.0			2.5 - 3.0	2.0 - 2.5	4.0 - 5.0	2.3 - 2.5
c. Barstow-Apple Valley	6.0 - 6.5						6.0 - 6.5	
d. Ontario	4.0 - 4.5	2.5 - 3.0			2.5 - 3.0		4.0 - 5.0	2.3 - 2.5
e. Highlands-Redlands	4.0 - 4.5	2.5 - 3.0			2.5 - 3.0		4.0 - 5.0	2.3 - 2.5
5. Ventura County	4.0 - 4.5	2.3 - 2.5	1.3 - 1.5		2.3 - 2.5	2.0 - 2.5	4.0 - 4.5	2.0 - 2.5

¹ Based on information provided by Agricultural Extension Service of the University of California.

Updated: Department of Water Resources, Southern District // Backup data for the California Water Plan, Bulletin 160-98. Date August 21, 2000

² Unit use values for crops grown in each region.

*PLEASE COMPLETE. SUBMIT THE ORIGINAL AND MAKE A COPY FOR YOUR RECORDS**

State of California, State Water Resources Control Board, Division of Water Rights

P.O. BOX 2000, SACRAMENTO, CA 95812-2000

Info: (916) 341-5300, FAX: (916) 341-5400, Web: http://www.waterrights.ca.gov

ANNUAL NOTICE OF GROUNDWATER EXTRACTION AND DIVERSION

If the owner information below is wrong or missing, please correct.

OWNER(S) OF RECORD PALMDALE REGIONAL AIRPORT

2005

PALMDALE REGIONAL AIRPORT
PROPERTY MANAGER
39516 NORTH 25TH ST EAST
PALMDALE CA 93550-2158

RECORDATION NO: ~~000000~~
CONTACT PHONE NO: 661 266-7602

Owner's Designation of Well
50TH ST E & AVE Q-10

State Well Number
T6N/R11W-16JS

Parcel Number
3025-043-901

DEADLINE: Notices must be received no later than August 31, 2006 in order to be recorded.

REQUIRED FEES: A filing fee of \$115.00 is required for each Annual Notice of Groundwater Extraction and Diversion. Check or money order should indicate your recordation number(s) and be made payable to: State Water Resources Control Board. Do not send cash.

PLEASE READ THE GENERAL INFORMATION ON THE REVERSE SIDE BEFORE COMPLETING THIS NOTICE

If the above information is inaccurate, please line it out in red and provide current information. Notify this office if ownership or address changes occur during the coming year.

1. **TYPE OF DIVERSION** ☒ Groundwater extraction or ☐ Surface diversion

2. **OWNERSHIP.** Person listed below is:

☐ Owner of land on which well or point of diversion is located, and is extracting/diverting water.

☐ Lessee of land on which well or point of diversion is located, and is extracting/diverting water.

☒ Owner of land, but lessee is extracting/diverting water.

☐ Other: Please explain: _____

3. **AMOUNT OF GROUNDWATER EXTRACTED DURING CALENDAR YEAR** →

4. **AMOUNT OF SURFACE WATER DIVERTED DURING CALENDAR YEAR** →

5. **METHOD OF MEASUREMENT** ☐ Water Meter ☐ Power Meter ☒ Nonmetered or Estimated

6. **TYPE OF WATER USE** ☒ Agricultural ☐ Domestic or Municipal ☐ Other: _____

7. **ACTION REQUESTED (Check one):**

☐ Close this file. (Files may be reopened at any time - fee required)

☒ Record my water use. (Fee required)

☐ Do not record my water use but keep my name on mailing list. (No fee required)

☐ Transfer this file to: _____

Company Name: _____ (NEW OWNER'S FIRST NAME) (M. NAME) (LAST NAME)

Address: _____ (MAILING ADDRESS) (CITY) (STATE) (ZIP CODE)

Telephone: () _____ Effective Date: _____

8. **SUPPLEMENTAL INFORMATION.** Please list any changes in your project since last year (new pump, new land irrigation, new method of irrigation, etc.) or any other comments

VEGETABLE PRODUCTION

9. **CERTIFICATION AND SIGNATURE:** I certify that the foregoing statements are true and correct to the best of my knowledge.

Signature: Lewis W. Trout Date: JANUARY 29, 2007

Printed Name: LEWIS W. TROUT
(FIRST NAME) (M. NAME) (LAST NAME)

Company Name: CITY OF LOS ANGELES, DEPARTMENT OF AIRPORTS, PALMDALE REGIONAL AIRPORT

THIS SPACE FOR OFFICE USE ONLY

R. 265 AMT: 115.

PLEASE COMPLETE. SUBMIT THE ORIGINAL AND MAKE A COPY FOR YOUR RECORDS

State of California, State Water Resources Control Board, Division of Water Rights

P.O. BOX 2000, SACRAMENTO, CA 95812-2000

Info: (916) 341-5300, FAX: (916) 341-5400, Web: <http://www.waterrights.ca.gov>

ANNUAL NOTICE OF GROUNDWATER EXTRACTION AND DIVERSION



G193391%G%2004
STATE WATER RESOURCES
CONTROL BOARD 2004

If the owner information below is wrong or missing, please correct.

OWNER(S) OF RECORD L A CITY DEPT OF AIRPORTS; PALMDALE REGIONAL AIRPORT, ATTENTION: PROPERTY MANAGER;

2005 JUL -1 PM 2:45

DIV. OF WATER RIGHTS
SACRAMENTO

PRIMARY CONTACT OR AGENT FOR MAIL & REPORTING:

PALMDALE REGIONAL AIRPORT
ATTENTION: PROPERTY MANAGER
39516 NORTH 25TH ST EAST
PALMDALE, CA 93550-2158

RECORDATION NO.: G193391
CONTACT PHONE NO.: (661)266-7602

Owner's Designation of Well

50TH ST E & AVE

0-10

State Well Number

06N/11W 406

-165

Parcel Number

3025-043-901

DEADLINE: Notices must be received no later than **June 30, 2005** in order to be recorded.

REQUIRED FEES: A filing fee of \$115.00 is required for each Annual Notice of Groundwater Extraction and Diversion. Check or money order should indicate your recordation number(s) and be made payable to: State Water Resources Control Board. Do not send cash.

PLEASE READ THE GENERAL INFORMATION ON THE REVERSE SIDE BEFORE COMPLETING THIS NOTICE

If the above information is inaccurate, please line it out in red and provide current information. Notify this office if ownership or address changes occur during the coming year.

1. TYPE OF DIVERSION ☒ Groundwater extraction or Surface diversion

2. OWNERSHIP. Person listed below is:

Owner of land on which well or point of diversion is located, and is extracting/diverting water.

Lessee of land on which well or point of diversion is located, and is extracting/diverting water.

☒ Owner of land, but lessee is extracting/diverting water.

Other: Please explain: _____

3. AMOUNT OF GROUNDWATER EXTRACTED DURING CALENDAR YEAR

4. AMOUNT OF SURFACE WATER DIVERTED DURING CALENDAR YEAR

5. METHOD OF MEASUREMENT ☐ Water Meter ☐ Power Meter ☒ Nonmetered or Estimated

6. TYPE OF WATER USE ☒ Agricultural ☐ Domestic or Municipal ☐ Other: _____

7. ACTION REQUESTED:

Close this file. (Files may be reopened at any time - fee required)

☒ Record my water use. (Fee required)

Do not record my water use but keep my name on mailing list. (No fee required)

Transfer this file to: _____

(NEW OWNER'S FIRST NAME)

(M. NAME)

(LAST NAME)

Company Name: _____

Address: _____

(MAILING ADDRESS)

(CITY)

(STATE)

(ZIP CODE)

Telephone: () _____ Effective Date: _____

8. SUPPLEMENTAL INFORMATION. Please list any changes in your project since last year (new pump, new land irrigation, new method of irrigation, etc.) or any other comments

VEGETABLE PRODUCTION

9. CERTIFICATION AND SIGNATURE: I certify that the foregoing statements are true and correct to the best of my knowledge.

Signature: _____

Date: _____

6/28/2005

Printed Name: _____

LEWIS

W.

(LAST NAME)

07 12 05 PLM
TROUT

Company Name: CITY OF LOS ANGELES, DEPT OF AIRPORTS, PALMDALE REGIONAL AIRPORT

THIS SPACE FOR OFFICE USE ONLY

EXHIBIT E - TO CITY OF LOS ANGELES' RESPONSE TO DISCOVERY ORDER

GW-ANN-EXTRT (1-05)

07 28 05 PLM

WRIMS

GENERAL INFORMATION

The dependence on groundwater in the Counties of Riverside, San Bernardino, Los Angeles, and Ventura has resulted in diminishing water supplies. As water becomes more scarce, determination of your water rights by the courts may become necessary. Your Annual Notice of Groundwater Extraction and Diversion is required to establish a record of water use which can assist the court in determining your rights.

The California Water Code requires you to record your annual surface and groundwater use if your total groundwater extractions from all wells exceed 25 acre-feet. Extractions of less than 10 acre-feet from a single well need not be reported. Although there is no penalty for failure to file the annual notice, failure to file is considered nonuse of water. Therefore, persons who do not file notices may have difficulty in supporting a claim of water use during a lawsuit to establish ownership of groundwater rights.

Exceptions: (1) If you are currently reporting your pumpage to a watermaster, your water use is already on record, and you are exempt from the requirement of filing a notice, or (2) if annual water use is less than the required amounts, filing is optional because these minimal amounts would probably not be affected by a water right dispute. All optional notices which are accompanied by appropriate fees will be recorded.

Should you require additional information about the Water Code requirements or assistance in completing this form, please write us or telephone (916) 341-5300.

TABLE 1: AGRICULTURAL WATER USE WORKSHEET (Optional)

To estimate your use of water, indicate below the crop type and number of acres. Then find the average irrigation requirement for each crop using Table II. Multiply acres (column 1) to applied water depth (column 2) to determine the amount pumped (column 3). Then total all amounts in column 3 to determine total irrigation use.

CROP	COLUMN 1	COLUMN 2	COLUMN 3
	ACRES	AVERAGE APPLIED WATER DEPTH (acre-feet per acre)	AMOUNT PUMPED (acre-feet) (column 1 X column 2)
VEGETABLES	100	6.0	600
CONVERSION FACTORS One acre-foot (af) = 43,560 cubic feet = 325,900 gallons One miner's inch is approximately 9 gallons per minute. An acre-foot covers one acre of land, 1 foot deep			TOTAL IRRIGATION USE 600

TABLE II: AVERAGE DEPTH OF WATER APPLIED TO IRRIGATE EACH CROP (acre-feet per acre)*

LOCALITY	ALFALFA	AVOCADOS	BEANS	DATES	LEMONS	LETTUCE	PERMANENT PASTURE	TOMATOES
1. Los Angeles County								
a. Coastal Basin ¹		2.0 - 2.5			2.0 - 2.5	2.0 - 2.5		
b. Antelope Valley	5.5 - 6.0						5.5 - 6.0	
2. Eastern Riverside County								
a. Coachella & Blythe Area ²	9.0 - 10.0			7.9 - 9.0	5.5 - 6.0	3.6 - 4.2	9.0 - 10.0	4.3 - 6.4
3. Western Riverside County	4.0 - 4.5	2.5 - 3.0			2.5 - 3.0	2.0 - 2.5	4.5 - 5.0	
4. San Bernardino County								
a. Chino Area	4.0 - 4.5	2.5 - 3.0			2.5 - 3.0	2.0 - 2.5	4.5 - 5.0	2.3 - 2.5
b. San Bernardino Area	4.0 - 4.5	2.5 - 3.0			2.5 - 3.0	2.0 - 2.5	4.0 - 5.0	2.3 - 2.5
c. Barstow-Apple Valley	6.0 - 6.5						6.0 - 6.5	
d. Ontario	4.0 - 4.5	2.5 - 3.0			2.5 - 3.0		4.0 - 5.0	2.3 - 2.5
e. Highlands-Redlands	4.0 - 4.5	2.5 - 3.0			2.5 - 3.0		4.0 - 5.0	2.3 - 2.5
5. Ventura County	4.0 - 4.5	2.3 - 2.5	1.3 - 1.5		2.3 - 2.5	2.0 - 2.5	4.0 - 4.5	2.0 - 2.5

*Based on information provided by Agricultural Extension Service of the University of California.

Updated: Department of Water Resources, Southern District // Backup data for the California Water Plan, Bulletin 160-98. Date August 21, 2000

¹ Unit use values for crops grown in each region.

² Unit use for dates was not changed from previous tab.
GW-ANN-EXTRT (1-05)

PLEASE COMPLETE. SUBMIT THE ORIGINAL AND MAKE A COPY FOR YOUR RECORDS

State of California, State Water Resources Control Board, Division of Water Rights

P.O. BOX 2000, SACRAMENTO, CA 95812-2000

Info: (916) 341-5300, FAX: (916) 341-5400, Web: <http://www.waterrights.ca.gov>

ANNUAL NOTICE OF GROUNDWATER EXTRACTION AND DIVERSION



G193391%G%2003

2003

If the owner information below is wrong or missing, please correct.

OWNER(S) OF RECORD L A CITY DEPT. OF AIRPORTS
PALMDALE REGIONAL AIRPORT; ATTENTION: PROPERTY MANAGER

RECORDATION NO.: G193391
CONTACT PHONE NO.: (661)266-7602

PRIMARY CONTACT OR AGENT FOR MAIL & REPORTING:

PALMDALE REGIONAL AIRPORT
ATTENTION: PROPERTY MANAGER
39516 NORTH 25TH ST EAST
PALMDALE, CA 93550-2158

Owner's Designation of Well

50TH ST E & AVE 0-8

State Well Number

06N/11W-16 S

Parcel Number

DEADLINE: Notices must be postmarked no later than **June 30, 2004** in order to be recorded.

REQUIRED FEES: A filing fee of \$115.00 is required for each Annual Notice of Groundwater Extraction and Diversion. Check or money order should indicate your recordation number(s) and be made payable to: State Water Resources Control Board. Do not send cash.

PLEASE READ THE GENERAL INFORMATION ON THE REVERSE SIDE BEFORE COMPLETING THIS NOTICE

If the above information is inaccurate, please line it out in red and provide current information. Notify this office if ownership or address changes occur during the coming year.

1. TYPE OF DIVERSION ☒ Groundwater extraction or ☐ Surface diversion

2. OWNERSHIP. Person listed below is:

☐ Owner of land on which well or point of diversion is located, and is extracting/diverting water.

☐ Lessee of land on which well or point of diversion is located, and is extracting/diverting water.

☒ Owner of land, but lessee is extracting/diverting water.

☐ Other: Please explain: _____

3. AMOUNT OF GROUNDWATER EXTRACTED DURING CALENDAR YEAR →

4. AMOUNT OF SURFACE WATER DIVERTED DURING CALENDAR YEAR →

5. METHOD OF MEASUREMENT ☐ Water Meter ☐ Power Meter ☒ Nonmetered or Estimated

6. TYPE OF WATER USE ☒ Agricultural ☐ Domestic or Municipal ☐ Other: _____

7. ACTION REQUESTED:

☐ Close this file. (Files may be reopened at any time -- fee required)

☒ Record my water use. (Fee required)

☐ Do not record my water use but keep my name on mailing list. (No fee required)

☐ Transfer this file to: _____

(NEW OWNER'S FIRST NAME)

(M. NAME)

(LAST NAME)

Company Name: _____

Address: _____

(MAILING ADDRESS)

(CITY)

(STATE)

(ZIP CODE)

Telephone: () _____

Effective Date: _____

8. SUPPLEMENTAL INFORMATION. Please list any changes in your project since last year (new pump, new land irrigation, new method of irrigation, etc.) or any other comments

VEGETABLE PRODUCTION

9. CERTIFICATION AND SIGNATURE: I certify that the forgoing statements are true and correct to the best of my knowledge.

Signature: _____

Date

6/30/2004

Printed Name

LEWIS

W.

TROUT

(FIRST NAME)

(M. NAME)

(LAST NAME)

Company Name: CITY OF LOS ANGELES, DEPT OF AIRPORTS, PALMDALE REGIONAL AIRPORT

THIS SPACE FOR OFFICE USE ONLY

R.

AMT:

GENERAL INFORMATION

The dependence on groundwater in the Counties of Riverside, San Bernardino, Los Angeles, and Ventura has resulted in diminishing water supplies. As water becomes more scarce, determination of your water rights by the courts may become necessary. Your Annual Notice of Groundwater Extraction and Diversion is required to establish a record of water use which can assist the court in determining your rights.

The California Water Code requires you to record your annual surface and groundwater use if your total groundwater extractions from all wells exceed 25 acre-feet. Extractions of less than 10 acre-feet from a single well need not be reported. Although there is no penalty for failure to file the annual notice, failure to file is considered nonuse of water. Therefore, persons who do not file notices may have difficulty in supporting a claim of water use during a lawsuit to establish ownership of groundwater rights.

Exceptions: (1) If you are currently reporting your pumpage to a watermaster, your water use is already on record, and you are exempt from the requirement of filing a notice, or (2) if Annual water use is less than the required amounts, filing is optional because these minimal amounts would probably not be affected by a water right dispute. All optional notices which are accompanied by appropriate fees will be recorded.

Should you require additional information about the Water Code requirements or assistance in completing this form, please write us or telephone (916) 341-5300.

TABLE 1: AGRICULTURAL WATER USE WORKSHEET (Optional)

To estimate your use of water, indicate below the crop type and number of acres. Then find the average irrigation requirement for each crop using Table II. Multiply acres (column 1) to applied water depth (column 2) to determine the amount pumped (column 3). Then total all amounts in column 3 to determine total irrigation use.

CROP	COLUMN 1 ACRES	COLUMN 2 AVERAGE APPLIED WATER DEPTH (acre-feet per acre)	COLUMN 3 AMOUNT PUMPED (acre-feet) (column 1 X column 2)
CONVERSION FACTORS One acre-foot (af) = 43,560 cubic feet = 325,900 gallons One miner's inch is approximately 9 gallons per minute. An acre-foot covers one acre of land, 1 foot deep			TOTAL IRRIGATION USE

TABLE II: AVERAGE DEPTH OF WATER APPLIED TO IRRIGATE EACH CROP (acre-feet per acre)*

LOCALITY	ALFALFA	AVOCADOS	BEANS	DATES	LEMONS	LETTUCE	PERMANENT PASTURE	TOMATOES
1. Los Angeles County								
a. Coastal Basin ¹		2.0 - 2.5			2.0 - 2.5	2.0 - 2.5		
b. Antelope Valley	5.5 - 6.0						5.5 - 6.0	
2. Eastern Riverside County								
a. Coachella & Blythe Area ²	9.0 - 10.0			7.9 - 9.0	5.5 - 6.0	3.6 - 4.2	9.0 - 10.0	4.3 - 6.4
3. Western Riverside County	4.0 - 4.5	2.5 - 3.0			2.5 - 3.0	2.0 - 2.5	4.5 - 5.0	
4. San Bernardino County								
a. Chino Area	4.0 - 4.5	2.5 - 3.0			2.5 - 3.0	2.0 - 2.5	4.5 - 5.0	2.3 - 2.5
b. San Bernardino Area	4.0 - 4.5	2.5 - 3.0			2.5 - 3.0	2.0 - 2.5	4.0 - 5.0	2.3 - 2.5
c. Barstow-Apple Valley	6.0 - 6.5						6.0 - 6.5	
d. Ontario	4.0 - 4.5	2.5 - 3.0			2.5 - 3.0		4.0 - 5.0	2.3 - 2.5
e. Highlands-Redlands	4.0 - 4.5	2.5 - 3.0			2.5 - 3.0		4.0 - 5.0	2.3 - 2.5
5. Ventura County	4.0 - 4.5	2.3 - 2.5	1.3 - 1.5		2.3 - 2.5	2.0 - 2.5	4.0 - 4.5	2.0 - 2.5

*Based on information provided by Agricultural Extension Service of the University of California.

Updated: Department of Water Resources, Southern District // Backup data for the California Water Plan, Bulletin 160-98. Date August 21, 2000

¹ Unit use values for crops grown in each region.

² Unit use for dates was not changed from previous table

PLEASE COMPLETE. SUBMIT THE ORIG AND MAKE A COPY FOR YOUR RECORDS

State of California, State Water Resources Control Board, Division of Water Rights

P.O. BOX 2000, SACRAMENTO, CA 95812-2000

Info: (916) 341-5300, FAX: (916) 341-5400, Web: <http://www.waterrights.ca.gov>

ANNUAL NOTICE OF GROUNDWATER EXTRACTION AND DIVERSION



G193391%G%2003

2003

2003 JUL -9 PM 1:40

If the owner information below is wrong or missing, please correct.

OWNER(S) OF RECORD PALMDALE REGIONAL AIRPORT; ATTENTION: PROPERTY MANAGER
L A CITY DEPT. OF AIRPORTS

PRIMARY CONTACT OR AGENT FOR MAIL & REPORTING:

PALMDALE REGIONAL AIRPORT
ATTENTION: PROPERTY MANAGER
39516 NORTH 25TH ST EAST
PALMDALE, CA 93550-2158

RECORDATION NO.: G193391
CONTACT PHONE NO.: (661)266-7602

Owner's Designation of Well

50TH ST E & AVE 0-8

State Well Number

06N/11W-16 S

Parcel Number

DEADLINE: Notices must be postmarked no later than **June 30, 2004** in order to be recorded.

REQUIRED FEES: A filing fee of \$115.00 is required for each Annual Notice of Groundwater Extraction and Diversion. Check or money order should indicate your recordation number(s) and be made payable to: State Water Resources Control Board. Do not send cash.

PLEASE READ THE GENERAL INFORMATION ON THE REVERSE SIDE BEFORE COMPLETING THIS NOTICE

If the above information is inaccurate, please line it out in red and provide current information. Notify this office if ownership or address changes occur during the coming year.

1. TYPE OF DIVERSION ☒ Groundwater extraction or ☐ Surface diversion

2. OWNERSHIP. Person listed below is:

☐ Owner of land on which well or point of diversion is located, and is extracting/diverting water.

☐ Lessee of land on which well or point of diversion is located, and is extracting/diverting water.

☒ Owner of land, but lessee is extracting/diverting water.

☐ Other: Please explain: _____

3. AMOUNT OF GROUNDWATER EXTRACTED DURING CALENDAR YEAR →

4. AMOUNT OF SURFACE WATER DIVERTED DURING CALENDAR YEAR →

5. METHOD OF MEASUREMENT ☐ Water Meter ☐ Power Meter ☒ Nonmetered or Estimated

6. TYPE OF WATER USE ☒ Agricultural ☐ Domestic or Municipal ☐ Other: _____

7. ACTION REQUESTED:

☐ Close this file. (Files may be reopened at any time - fee required)

☒ Record my water use. (Fee required)

☐ Do not record my water use but keep my name on mailing list. (No fee required)

☐ Transfer this file to: _____

Company Name: _____ (NEW OWNER'S FIRST NAME) (M. NAME) (LAST NAME)

Address: _____ (MAILING ADDRESS) (CITY) (STATE) (ZIP CODE)

Telephone: () _____ Effective Date: _____

8. SUPPLEMENTAL INFORMATION. Please list any changes in your project since last year (new pump, new land irrigation, new method of irrigation, etc.) or any other comments

VEGETABLE PRODUCTION

9. CERTIFICATION AND SIGNATURE: I certify that the foregoing statements are true and correct to the best of my knowledge.

Signature: Lewis W. Trout Date: 6/30/2004
Printed Name: LEWIS W. TROUT
(FIRST NAME) (M. NAME) (LAST NAME)

Company Name: CITY OF LOS ANGELES DEPT OF AIRPORTS, PALMDALE REGIONAL AIRPORT

THIS SPACE FOR OFFICE USE ONLY EXHIBIT E- TO CITY OF LOS ANGELES' RESPONSE TO DISCOVERY ORDER

GENERAL INFORMATION

The dependence on groundwater in the Counties of Riverside, San Bernardino, Los Angeles, and Ventura has resulted in diminishing water supplies. As water becomes more scarce, determination of your water rights by the courts may become necessary. Your Annual Notice of Groundwater Extraction and Diversion is required to establish a record of water use which can assist the court in determining your rights.

The California Water Code requires you to record your annual surface and groundwater use if your total groundwater extractions from all wells exceed 25 acre-feet. Extractions of less than 10 acre-feet from a single well need not be reported. Although there is no penalty for failure to file the annual notice, failure to file is considered nonuse of water. Therefore, persons who do not file notices may have difficulty in supporting a claim of water use during a lawsuit to establish ownership of groundwater rights.

Exceptions: (1) If you are currently reporting your pumpage to a watermaster, your water use is already on record, and you are exempt from the requirement of filing a notice, or (2) if Annual water use is less than the required amounts, filing is optional because these minimal amounts would probably not be affected by a water right dispute. All optional notices which are accompanied by appropriate fees will be recorded.

Should you require additional information about the Water Code requirements or assistance in completing this form, please write us or telephone (916) 341-5300.

TABLE 1: AGRICULTURAL WATER USE WORKSHEET (Optional)

To estimate your use of water, indicate below the crop type and number of acres. Then find the average irrigation requirement for each crop using Table II. Multiply acres (column 1) to applied water depth (column 2) to determine the amount pumped (column 3). Then total all amounts in column 3 to determine total irrigation use.

CROP	COLUMN 1	COLUMN 2	COLUMN 3
	ACRES	AVERAGE APPLIED WATER DEPTH (acre-feet per acre)	AMOUNT PUMPED (acre-feet) (column 1 X column 2)
CONVERSION FACTORS One acre-foot (af) = 43,560 cubic feet = 325,900 gallons One miner's inch is approximately 9 gallons per minute. An acre-foot covers one acre of land, 1 foot deep			TOTAL IRRIGATION USE

TABLE II: AVERAGE DEPTH OF WATER APPLIED TO IRRIGATE EACH CROP (acre-feet per acre)*

LOCALITY	ALFALFA	AVOCADOS	BEANS	DATES	LEMONS	LETTUCE	PERMANENT PASTURE	TOMATOES
1. Los Angeles County								
a. Coastal Basin ¹		2.0 - 2.5			2.0 - 2.5	2.0 - 2.5		
b. Antelope Valley	5.5 - 6.0						5.5 - 6.0	
2. Eastern Riverside County								
a. Coachella & Blythe Area ²	9.0 - 10.0			7.9 - 9.0	5.5 - 6.0	3.6 - 4.2	9.0 - 10.0	4.3 - 6.4
3. Western Riverside County	4.0 - 4.5	2.5 - 3.0			2.5 - 3.0	2.0 - 2.5	4.5 - 5.0	
4. San Bernardino County								
a. Chino Area	4.0 - 4.5	2.5 - 3.0			2.5 - 3.0	2.0 - 2.5	4.5 - 5.0	2.3 - 2.5
b. San Bernardino Area	4.0 - 4.5	2.5 - 3.0			2.5 - 3.0	2.0 - 2.5	4.0 - 5.0	2.3 - 2.5
c. Barstow-Apple Valley	6.0 - 6.5						6.0 - 6.5	
d. Ontario	4.0 - 4.5	2.5 - 3.0			2.5 - 3.0		4.0 - 5.0	2.3 - 2.5
e. Highlands-Redlands	4.0 - 4.5	2.5 - 3.0			2.5 - 3.0		4.0 - 5.0	2.3 - 2.5
5. Ventura County	4.0 - 4.5	2.3 - 2.5	1.3 - 1.5		2.3 - 2.5	2.0 - 2.5	4.0 - 4.5	2.0 - 2.5

*Based on information provided by Agricultural Extension Service of the University of California.

Updated: Department of Water Resources, Southern District // Backup data for the California Water Plan, Bulletin 160-98. Date August 21, 2000

¹ Unit use values for crops grown in each region.

² Unit use for dates was not changed from previous table.

PLEASE COMPLETE. SUBMIT THE ORIGINAL AND MAKE A COPY FOR YOUR RECORDS

State of California, State Water Resources Control Board, Division of Water Rights

P.O. BOX 2000, SACRAMENTO, CA 95812-2000

Info: (916) 341-5300, FAX: (916) 341-5400, Web: <http://www.waterrights.ca.gov>

ANNUAL NOTICE OF GROUNDWATER EXTRACTION AND DIVERSION

If the owner information below is wrong or missing, please correct.

OWNER(S) OF RECORD L A CITY DEPT OF AIRPORTS;



G193391%G%2002

STATE WATER RESOURCES
CONTROL BOARD

2003 SEP -2 AM 12:02

DIV. OF WATER RIGHTS
SACRAMENTO

PRIMARY CONTACT OR AGENT FOR MAIL & REPORTING:

~~L A CITY DEPT OF AIRPORTS~~
PALMDALE REGIONAL AIRPORT, ATTENTION PROPERTY
39516 NORTH 25TH ST EAST
PALMDALE, CA 93550-2158

RECORDATION NO.: G193391
CONTACT PHONE NO.: (661)266-7602

FOR ONLINE REPORTING AT
www.waterrights.ca.gov

USER NAME: G193391
PASSWORD: D12769

Owner's Designation of Well

50TH ST E & AVE 0-8

State Well Number

06N/11W-16 S

Parcel Number

DEADLINE: Notices must be postmarked no later than **August 31, 2003** in order to be recorded.

REQUIRED FEES: A filing fee of \$5.00 is required for each Annual Notice of Groundwater Extraction and Diversion. Check or money order should indicate your recordation number(s) and be made payable to: State Water Resources Control Board. Do not send cash.

PLEASE READ THE GENERAL INFORMATION ON THE REVERSE SIDE BEFORE COMPLETING THIS NOTICE

If the above information is inaccurate, please line it out in red and provide current information. Notify this office if ownership or address changes occur during the coming year.

1. TYPE OF DIVERSION ☒ Groundwater extraction or ☐ Surface diversion

2. OWNERSHIP. Person listed below is:

☐ Owner of land on which well or point of diversion is located, and is extracting/diverting water.

☐ Lessee of land on which well or point of diversion is located, and is extracting/diverting water.

☒ Owner of land, but lessee is extracting/diverting water.

☐ Other: Please explain: _____

3. AMOUNT OF GROUNDWATER EXTRACTED DURING CALENDAR YEAR →

4. AMOUNT OF SURFACE WATER DIVERTED DURING CALENDAR YEAR →

5. METHOD OF MEASUREMENT ☐ Water Meter ☐ Power Meter ☒ Nonmetered or Estimated

6. TYPE OF WATER USE ☒ Agricultural ☐ Domestic or Municipal ☐ Other: _____

7. ACTION REQUESTED:

☐ Close this file. (Files may be reopened at any time – fee required.)

☒ Record my water use. (Fee required)

☐ Do not record my water use but keep my name on mailing list. (No fee required)

☐ Transfer this file to: _____

(NEW OWNER'S FIRST NAME)

(M. NAME)

(LAST NAME)

Company Name: _____

Address: _____

(MAILING ADDRESS)

(CITY)

(STATE)

(ZIP CODE)

Telephone: () _____

Effective Date: _____

8. SUPPLEMENTAL INFORMATION. Please list any changes in your project since last year (new pump, new land irrigation, new method of irrigation, etc.) or any other comments

VEGETABLE PRODUCTION

9. CERTIFICATION AND SIGNATURE: I certify that the foregoing statements are true and correct, to the best of my knowledge.

Signature: _____

Today's Date

8/29/2003

Printed Name

LEWIS

(FIRST NAME)

W.

(M. NAME)

TROUT

(LAST NAME)

Company Name:

LOS ANGELES WORLD AIRPORT, PALMDALE REGIONAL AIRPORT

THIS SPACE FOR OFFICE USE ONLY

R. 2529 AMT: \$15

GENERAL INFORMATION

The dependence on groundwater in the Counties of Riverside, San Bernardino, Los Angeles and Ventura has resulted in diminishing water supplies. As water becomes more scarce, determination of your water rights by the courts may become necessary. Your Annual Notice of Groundwater Extraction and Diversion is required to establish a record of water use which can assist the court in determining your rights.

The California Water Code requires you to record your annual surface and groundwater use if your total groundwater extractions from all wells exceed 25 acre-feet. Extractions of less than 10 acre-feet from a single well need not be reported. Although there is no penalty for failure to file the annual notice, failure to file is considered nonuse of water. Therefore, persons who do not file notices may have difficulty in supporting a claim of water use during a lawsuit to establish ownership of groundwater rights.

Exceptions: (1) If you are currently reporting your pumpage to a watermaster, your water use is already on record, and you are exempt from the requirement of filing a notice, or (2) if Annual water use is less than the required amounts, filing is optional because these minimal amounts would probably not be affected by a water right dispute. All optional notices which are accompanied by appropriate fees will be recorded.

Should you require additional information about the Water Code requirements or assistance in completing this form, please write us or telephone (916) 341-5300

TABLE 1: AGRICULTURAL WATER USE WORKSHEET (Optional)

To estimate your use of water, indicate below the crop type and number of acres. Then find the average irrigation requirement for each crop using Table II. Multiply acres (column 1) times applied water depth (column 2) to determine the amount pumped (column 3). Then total all amounts in column 3 to determine total irrigation use.

CROP	COLUMN 1	COLUMN 2	COLUMN 3
	ACRES	AVERAGE APPLIED WATER DEPTH (acre-feet per acre)	AMOUNT PUMPED (acre-feet) (column 1 X column 2)
CONVERSION FACTORS One acre-foot (a. f.) = 43,560 cubic feet – 325,900 gallons One miner's inch is approximately 9 gallons per minute. An acre-foot covers one acre of land, 1 foot deep			TOTAL IRRIGATION USE

TABLE II: AVERAGE DEPTH OF WATER APPLIED TO IRRIGATE EACH CROP (acre-feet per acre)*

LOCALITY	ALFALFA	AVOCADOS	BEANS	DATES	LEMONS	LETTUCE	PERMANET PASTURE	TOMATOES
1. Los Angeles County								
a. Coastal Basin ¹		2.0 - 2.5			2.0 - 2.5	2.0 - 2.5		
b. Antelope Valley	5.5 - 6.0						5.5 - 6.0	
2. Eastern Riverside County								
a. Coachella & Blythe Area ²	9.0 - 10.0			7.9 - 9.0	5.5 - 6.0	3.6 - 4.2	9.0 - 10.0	4.3 - 6.4
3. Western Riverside County	4.0 - 4.5	2.5 - 3.0			2.5 - 3.0	2.0 - 2.5	4.5 - 5.0	
4. San Bernardino County								
a. Chino Area	4.0 - 4.5	2.5 - 3.0			2.5 - 3.0	2.0 - 2.5	4.5 - 5.0	2.3 - 2.5
b. San Bernardino Area	4.0 - 4.5	2.5 - 3.0			2.5 - 3.0	2.0 - 2.5	4.0 - 5.0	2.3 - 2.5
c. Barstow-Apple Valley	6.0 - 6.5						6.0 - 6.5	
d. Ontario	4.0 - 4.5	2.5 - 3.0			2.5 - 3.0		4.0 - 5.0	2.3 - 2.5
e. Highlands-Redlands	4.0 - 4.5	2.5 - 3.0			2.5 - 3.0		4.0 - 5.0	2.3 - 2.5
5. Ventura County	4.0 - 4.5	2.3 - 2.5	1.3 - 1.5		2.3 - 2.5	2.0 - 2.5	4.0 - 4.5	2.0 - 2.5

* Based on information provided by Agricultural Extension Service of the University of California.

Updated: Department of Water Resources, Southern District // Backup data for the California Water Plan, Bulletin 160-98, Date August 21, 2000

*"The energy challenge facing California is real. Every California needs to take immediate action to reduce energy consumption.
For a list of simple ways you can reduce demand and cut your energy costs, see our Web-site at <http://www.swrcb.ca.gov>"*

¹ Unit use values for crops grown in each region.

² Unit use for dates was not changed from previous table.
GW-ANN-EXTRT (6-03)

PLEASE COMPLETE. SUBMIT THE OF AL AND MAKE A COPY FOR YOUR RECORDS

State of California, State Water Resc Control Board, Division of Water Rights

P.O. BOX 2000, SACRAMENTO, CA 95812-2000

Info: (916) 341-5300, FAX: (916) 341-5400, Web: http://www.waterrights.ca.gov

ANNUAL NOTICE OF GROUNDWATER EXTRACTION AND DIVERSION

If the owner information below is wrong or missing, please correct.

OWNER(S) OF RECORD L A CITY DEPT OF AIRPORTS;



2001

PRIMARY CONTACT OR AGENT FOR MAIL & REPORTING:

L A CITY DEPT OF AIRPORTS

39516 NORTH 25TH ST EAST

PALMDALE, CA 93550-2158

STATEMENT NO.: G193391
CONTACT PHONE NO.: (661)266-7602

FOR ONLINE REPORTING AT
www.waterrights.ca.gov

USER NAME: G193391
PASSWORD: C12769

Owner's Designation of Well.

50TH ST E & AVE 0-8

State Well Number

06N/11W-16 S

Parcel Number

DEADLINE: Notices must be postmarked no later than **June 30, 2002** in order to be recorded.

REQUIRED FEES: A filing fee of \$5.00 is required for each Annual Notice of Groundwater Extraction and Diversion. Check or money order should indicate your recordation number(s) and be made payable to: State Water Resources Control Board. Do not send cash.

PLEASE READ THE GENERAL INFORMATION ON THE REVERSE SIDE BEFORE COMPLETING THIS NOTICE

If the above information is inaccurate, please line it out in red and provide current information. Notify this office if ownership or address changes occur during the coming year.

1. TYPE OF DIVERSION Groundwater extraction or Surface diversion

2. OWNERSHIP. Person listed below is:

Owner of land on which well or point of diversion is located, and is extracting/diverting water.

Leesee of land on which well or point of diversion is located, and is extracting/diverting water.

Owner of land, but leesee is extracting/diverting water.

Other: Please explain: _____

3. AMOUNT OF GROUNDWATER EXTRACTED DURING CALENDAR YEAR

4. AMOUNT OF SURFACE WATER DIVERTED DURING CALENDAR YEAR

5. METHOD OF MEASUREMENT Water Meter Power Meter Nonmetered or Estimated

6. TYPE OF WATER USE Agricultural Domestic or Municipal Other: _____

7. ACTION REQUESTED:

Close this file. (Files may be reopened at any time - fee required.)

Record my water use. (Fee required)

Do not record my water use but keep my name on mailing list. (No fee required)

Transfer this file to: _____

Company Name: _____ (NEW OWNER'S FIRST NAME) (M. NAME) (LAST NAME)

Address: _____ (MAILING ADDRESS) (CITY) (STATE) (ZIP CODE)

Telephone: () _____ Effective Date: _____

8. SUPPLEMENTAL INFORMATION. Please list any changes in your project since last year (new pump, new land irrigation, new method of irrigation, etc.) or any other comments.

VEGETABLE PRODUCTION (GIBA FARMS)

9. CERTIFICATION AND SIGNATURE: I certify that the forgoing statements are true and correct, to the best of my knowledge.

Signature: Lewis W. Trout

Today's Date 6/25/2002

Printed Name LEWIS (FIRST NAME)

W. (M. NAME)

TROUT (LAST NAME)

Company Name: LOS ANGELES WORLD AIRPORTS, PALMDALE REGIONAL AIRPORT

THIS SPACE FOR OFFICE USE ONLY

R. 2461

AMT: 5-

GENERAL INFORMATION

The dependence on groundwater in the Counties of Riverside, San Bernardino, Los Angeles and Ventura has resulted in diminishing water supplies. As water becomes more scarce, determination of your water rights by the courts may become necessary. Your Annual Notice of Groundwater Extraction and Diversion is required to establish a record of water use which can assist the court in determining your rights.

The California Water Code requires you to record your annual surface and groundwater use if your total groundwater extractions from all wells exceed 25 acre-feet. Extractions of less than 10 acre-feet from a single well need not be reported. Although there is no penalty for failure to file the annual notice, failure to file is considered nonuse of water. Therefore, persons who do not file notices may have difficulty in supporting a claim of water use during a lawsuit to establish ownership of groundwater rights.

Exceptions: (1) If you are currently reporting your pumpage to a watermaster, your water use is already on record, and you are exempt from the requirement of filing a notice, or (2) if Annual water use is less than the required amounts, filing is optional because these minimal amounts would probably not be affected by a water right dispute. All optional notices which are accompanied by appropriate fees will be recorded.

Should you require additional information about the Water Code requirements or assistance in completing this form, please write us or telephone (916) 341-5300

TABLE 1: AGRICULTURAL WATER USE WORKSHEET (Optional)

To estimate your use of water, indicate below the crop type and number of acres. Then find the average irrigation requirement for each crop using Table II. Multiply acres (column 1) times applied water depth (column 2) to determine the amount pumped (column 3). Then total all amounts in column 3 to determine total irrigation use.

CROP	COLUMN 1	COLUMN 2	COLUMN 3
	ACRES	AVERAGE APPLIED WATER DEPTH (acre-feet per acre)	AMOUNT PUMPED (acre-feet) (column 1 X column 2)
CONVERSION FACTORS One acre-foot (a. f.) = 43,560 cubic feet – 325,900 gallons One miner's inch is approximately 9 gallons per minute. An acre-foot covers one acre of land, 1 foot deep			TOTAL IRRIGATION USE

TABLE II: AVERAGE DEPTH OF WATER APPLIED TO IRRIGATE EACH CROP (acre-feet per acre)*

LOCALITY	ALFALFA	AVOCADOS	BEANS	DATES	LEMONS	LETTUCE	PERMANET PASTURE	TOMATOES
1. Los Angeles County								
a. Coastal Basin ¹		2.0 - 2.5			2.0 - 2.5	2.0 - 2.5		
b. Antelope Valley	5.5 - 6.0						5.5 - 6.0	
2. Eastern Riverside County								
a. Coachella & Blythe Area ²	9.0 - 10.0			7.9 - 9.0	5.5 - 6.0	3.6 - 4.2	9.0 - 10.0	4.3 - 6.4
3. Western Riverside County	4.0 - 4.5	2.5 - 3.0			2.5 - 3.0	2.0 - 2.5	4.5 - 5.0	
4. San Bernardino County								
a. Chino Area	4.0 - 4.5	2.5 - 3.0			2.5 - 3.0	2.0 - 2.5	4.5 - 5.0	2.3 - 2.5
b. San Bernardino Area	4.0 - 4.5	2.5 - 3.0			2.5 - 3.0	2.0 - 2.5	4.0 - 5.0	2.3 - 2.5
c. Barstow-Apple Valley	6.0 - 6.5						6.0 - 6.5	
d. Ontario	4.0 - 4.5	2.5 - 3.0			2.5 - 3.0		4.0 - 5.0	2.3 - 2.5
e. Highlands-Redlands	4.0 - 4.5	2.5 - 3.0			2.5 - 3.0		4.0 - 5.0	2.3 - 2.5
5. Ventura County	4.0 - 4.5	2.3 - 2.5	1.3 - 1.5		2.3 - 2.5	2.0 - 2.5	4.0 - 4.5	2.0 - 2.5

* Based on information provided by Agricultural Extension Service of the University of California.

Updated: Department of Water Resources, Southern District // Backup data for the California Water Plan, Bulletin 160-98. Date August 21, 2000

*"The energy challenge facing California is real. Every California needs to take immediate action to reduce energy consumption.
For a list of simple ways you can reduce demand and cut your energy costs, see our Web-site at <http://www.swrcb.ca.gov>"*

¹ Unit use values for crops grown in each region.

² Unit use for dates was not changed from previous table.

***PLEASE COMPLETE.

SUBMIT THE ORIGINAL AND MAKE A COPY FOR YOUR RECORDS***

State of California

State Water Resources Control Board, Division of Water Rights

P.O. BOX 2000, SACRAMENTO, CA 95812-2000

Info: (916) 341-5300, FAX: (916) 341-5400, Web: <http://www.waterrights.ca.gov>

ANNUAL NOTICE OF GROUNDWATER EXTRACTION AND DIVERSION FOR 2000

PLEASE READ THE GENERAL INFORMATION ON THE REVERSE SIDE BEFORE COMPLETING THIS NOTICE

REQUIRED FEES: A filing fee of \$5.00 is required for each Annual Notice of Groundwater Extraction and Diversion. Check or money order should indicate your recordation number(s) and be made payable to: State Water Resources Control Board. Do not send cash.

DEADLINE: Notices must be postmarked no later than June 30, 2001 in order to be recorded.

Owner of Record: L A CITY DEPT OF AIRPORTS ; PROPERTY MANAGER, PALMDALE REGIONAL AIRPORT

PALMDALE REGIONAL AIRPORT
ATTENTION: PROPERTY MANAGER
39516 NORTH 25TH ST EAST
PALMDALE, CA 93550-2158

Recordation No.: 6193371

Password:

Phone Number: (661) 266-7602

Owner's Designation of Well

50TH STREET EAST & AVENUE O-8

State Well Number

06N/11W-16

Parcel Number

If the above information is inaccurate, please line it out in red and provide current information. Notify this office if ownership or address changes occur during the coming year.

1. TYPE OF DIVERSION

☒ Groundwater extraction or ☐ Surface diversion

2. OWNERSHIP. Person listed below is:

- ☐ Owner of land on which well or point of diversion is located, and is extracting/diverting water.
- ☐ Lessee of land on which well or point of diversion is located, and is extracting/diverting water.
- ☒ Owner of land, but lessee is extracting/diverting water.
- ☐ Other. Please explain: _____

3. AMOUNT OF GROUNDWATER EXTRACTED DURING CALENDAR YEAR

4. AMOUNT OF SURFACE WATER DIVERTED DURING CALENDAR YEAR

5. METHOD OF MEASUREMENT ☐ Water Meter ☐ Power Meter ☒ Nonmetered or Estimated6. TYPE OF WATER USE ☒ Agricultural ☐ Domestic or Municipal ☐ Other: _____

7. ACTION REQUESTED:

- ☐ Close this file. (Files may be reopened at any time - fee required.)
- ☒ Record my water use. (Fee required)
- ☐ Do not record my water use but keep my name on mailing list. (No fee required)

☐ Transfer this file to:

(NEW OWNER'S FIRST NAME)

(M. NAME)

(LAST NAME)

Company Name: _____

Address: _____

(MAILING ADDRESS)

(CITY)

(STATE)

(ZIP CODE)

Telephone: () _____

Effective Date: _____

8. SUPPLEMENTAL INFORMATION. Please list any changes in your project since last year (new pump, new land irrigation, new method of irrigation, etc.) or any other comments.
VEGETABLE PRODUCTION - WELL OPERATING FOR AT LEAST FIVE (5) YEARS
BUT OMITTED FROM 1999 REPORT IN ERROR.

9. CERTIFICATION AND SIGNATURE: I certify that the foregoing statements are true and correct, to the best of my knowledge.

Signature: _____

Today's Date 6/29/2001

Printed Name _____

LEWIS

W.

TROTT

(FIRST NAME)

(M. NAME)

(LAST NAME)

CITY OF LOS ANGELES, DEPARTMENT OF AIRPORTS

Company Name: PALMDALE REGIONAL AIRPORT

R. 2454 AMT: 5

THIS SPACE FOR OFFICE USE ONLY

EXHIBIT E- TO CITY OF LOS ANGELES' RESPONSE TO DISCOVERY ORDER

[FINAL SUBMITTED VERSION]

ANNUAL NOTICE OF GROUNDWATER EXTRACTION AND DIVERSION FOR 2011

Primary Owner: County Sanitation District No. 20 of LA County

Recordation Number: G193512

Date Submitted: 2012-06-11

1. Reporting to a Local Agency	
Local Agency	Submitter does not report to a local agency.

2. Type(s) of Diversion	
a. Groundwater Extraction	> 25 acre-feet
b. Surface Diversion	None

3. Ownership Type of Owner(s) on Record	
Ownership Type	Lessee of land on which well or point of diversion is located, and is extracting/diverting water

4. Amount of Groundwater Extracted During Calendar Year	
Amount Extracted	192 Acre-Feet

5. Amount of Surface Water Diverted or Used	
Not applicable; Surface Diversion was not chosen as a type of diversion.	

5d. Maximum Rate of Surface Water Diversion	
Not applicable; Surface Diversion was not chosen as a type of diversion.	

6. Method of Measurement	
Method of Measurement	Water Meter

7. Type(s) of Use	
Irrigation	2010 Acres Mixed Crop Types

8. Action Requested	
Action Requested	Record my water use

9. Supplemental Information	
Supplemental Information	A total of 603 AFY of groundwater and 8828 AFY of recycled water are used at wells G193512-G193515.

Attachments		
File Name	Descripton	Size
No Attachments		

Contact Information of the Person Submitting the Form	
First Name	Ann
Last Name	Heil
Relation to Water Right	



EXHIBIT E- TO CITY OF LOS ANGELES' RESPONSE TO DISCOVERY ORDER

I read the above and
agree

Yes

[FINAL SUBMITTED VERSION]**ANNUAL NOTICE OF GROUNDWATER EXTRACTION AND DIVERSION FOR 2010**

Primary Owner: County Sanitation District No. 20 of LA County

Recordation Number: G193512

Date Submitted: 2011-06-28

Reporting to a Local Agency	
Local Agency	Submitter does not report to a local agency.

Type(s) of Diversion	
Groundwater Extraction	> 25 acre-feet
Surface Diversion	None

Ownership Type of Owner(s) on Record	
Ownership Type	Lessee of land on which well or point of diversion is located, and is extracting/diverting water

Amount of Groundwater Extracted During Calendar Year	
Amount Extracted	172 Acre-Feet

Amount of Surface Water Diverted or Used	
Not applicable; Surface Diversion was not chosen as a type of diversion.	

Maximum Rate of Surface Water Diversion	
Not applicable; Surface Diversion was not chosen as a type of diversion.	

Method of Measurement	
Method of Measurement	Water Meter

Purpose(s) of Use	
Irrigation	2010 Acres Mixed Crop Types

Action Requested	
Action Requested	Record my water use

Supplemental Information	
Supplemental Information	A total of 570 AFY of groundwater and 6917 AFY of recycled water are used at wells G193512-G193515.

Attachments	
File Name	Size
No Attachments	

Contact Information of the Person Submitting the Form	
First Name	Tom
Last Name	Weiland
I read the above and agree	Yes

EXHIBIT E- TO CITY OF LOS ANGELES' RESPONSE TO DISCOVERY ORDER

G193512



G193512

Complete a separate
notice for each well.

State of California
State Water Resources Control Board
DIVISION OF WATER RIGHTS
P.O. Box 2000, Sacramento, CA 95812-2000
Info: (916) 341-5300, FAX: (916) 341-5300, Web: <http://www.waterrights.ca.gov>

Recordation Number 6193512
State Well Number 06N/11W-09 5
(Division of Water Rights Use Only)

**FIRST NOTICE
GROUNDWATER DIVERSION**

(Pursuant to Part 5, Division 2 of the Water Code)

1. Name of person owning the well County Sanitation District No. 20 of Los Angeles County
(Unless otherwise indicated, annual notices will be sent to this name and address)

Address 39300 30th Street East Palmdale, CA 93550
Street address or P.O. Box number City State Zip Code

Telephone Number (562) 908 - 4288 X2801

2. Name of person extracting groundwater (if different than Item 1) _____

Address _____
Street address or P.O. Box number City State Zip Code

Telephone Number () _____ - _____

WELL LOCATION

3. Owner's designation of well R-02 4. County Los Angeles

5. County Assessor's Parcel Number 3025035294

6. Describe location of well to the nearest 40-acre quarter section. State well number (if known) _____

Northeast $\frac{1}{4}$, of Southwest $\frac{1}{4}$, Section 9, Township 06N
Range 11W, San Bernardino B. & M.

7. Indicate location of well in the section grid below, or provide a copy of the USGS quadrangle map with the well location marked. The place of use should also be indicated. The grid represents one whole section.

Section 9, Township 06N, Range 11W,

Quadrangle map name San Bernardino

	X		

20.511
PODID: 52971
34' 37' 25.8" N
118° 3' .24" W

STATE WATER RESOURCES
CONTROL BOARD
2008 JUL - 8 AM 11:35
DIV. OF WATER RIGHTS
SACRAMENTO

Rec'd
5/15/08
7/8/08
M/D

WATER USE

8. Describe the Place of Use (If sketch is required, please use grid under item 7) Used to irrigate crops in sections 10, 11, and 14-16 of Township 06N, Range 11W, San Bernardino Meridian.

9. Quantity and Use of water extracted and method used in determining quantity for the last calendar year.

Calendar Year	EXTRACTIONS		USE		
			When use is for irrigation		When use is other than irrigation
	Annual extractions in acre-feet or (specify unit)	Method of measurement or of estimate (specify)	Crops served	Acreage Supplied	Nature and extent of use, i.e. population, products manufactured, number and kind of stock watered
20 06	30 AF	Est. w/Flow Meters	Fodder	1,593	

10. Do you also divert surface water? No
Yes or No

11. If answer (to 10 above) is yes, how are you reporting surface water use?

- a. Under Statement of Water Diversion and Use procedures..... ☐
- b. Under Annual Recoordation Notice procedures..... ☐
- c. Under Appropriative Water Right procedures..... ☐
- d. Not reporting..... ☐

WELL DATA

12. Is the place of use also served by another well? Yes (see Attachment 1) Another water source? Yes
Yes or No Yes or No

13. If yes to either, describe Six extraction wells supplementing Palmdale Water Reclamation Plant Effluent

14. Type, make and horsepower of pump Submersible, Grundfos, 20Hp Date installed August 11, 2006

15. Pump tests CH2M Hill, August 4, 2006, 125, 75%
Conducted by Date Discharge rate gpm Pump efficiency

16. Power supply Southern California Edison, Currently, temp. power August 4, 2006
Source Meter No. Date installed

17. Depth of well 452 feet. 18. Casing diameter Internal Diameter is 8 inches.

19. Is well gravel-packed? Yes 20. Date drilled July 1, 2006
Yes or No

21. What are the upper and lower depths of casing perforations? Upper 315.4 feet Lower 446.6 feet
(Show feet from ground surface)

22. Is log of well available? Yes Where? County Sanitation District of Los Angeles County (CSDLAC)
Yes or No

23. Has a chemical analysis of well water been made? Yes If yes, where can it be obtained? CSDLAC
Yes or No

24. Are water level measurements available? Yes Where? CSDLAC

PLEASE NOTE THAT:

**A willful misstatement in this notice is a misdemeanor pursuant to Section 5008 of the Water Code.
A \$115.00 filing fee must accompany each notice.**

I certify that the foregoing required statements and the following optional additional statements, if any, are true and correct to the best of my knowledge and belief.

Name Raymond L. Tremblay

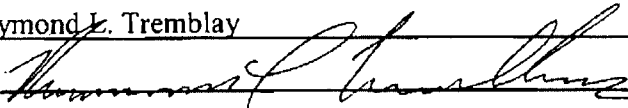
Signature 

Title Monitoring Section Head Date May 29, 2007

At (City of P.O.) Whittier, CA

Firm or Corporate Name County Sanitation District No. 20 of Los Angeles County

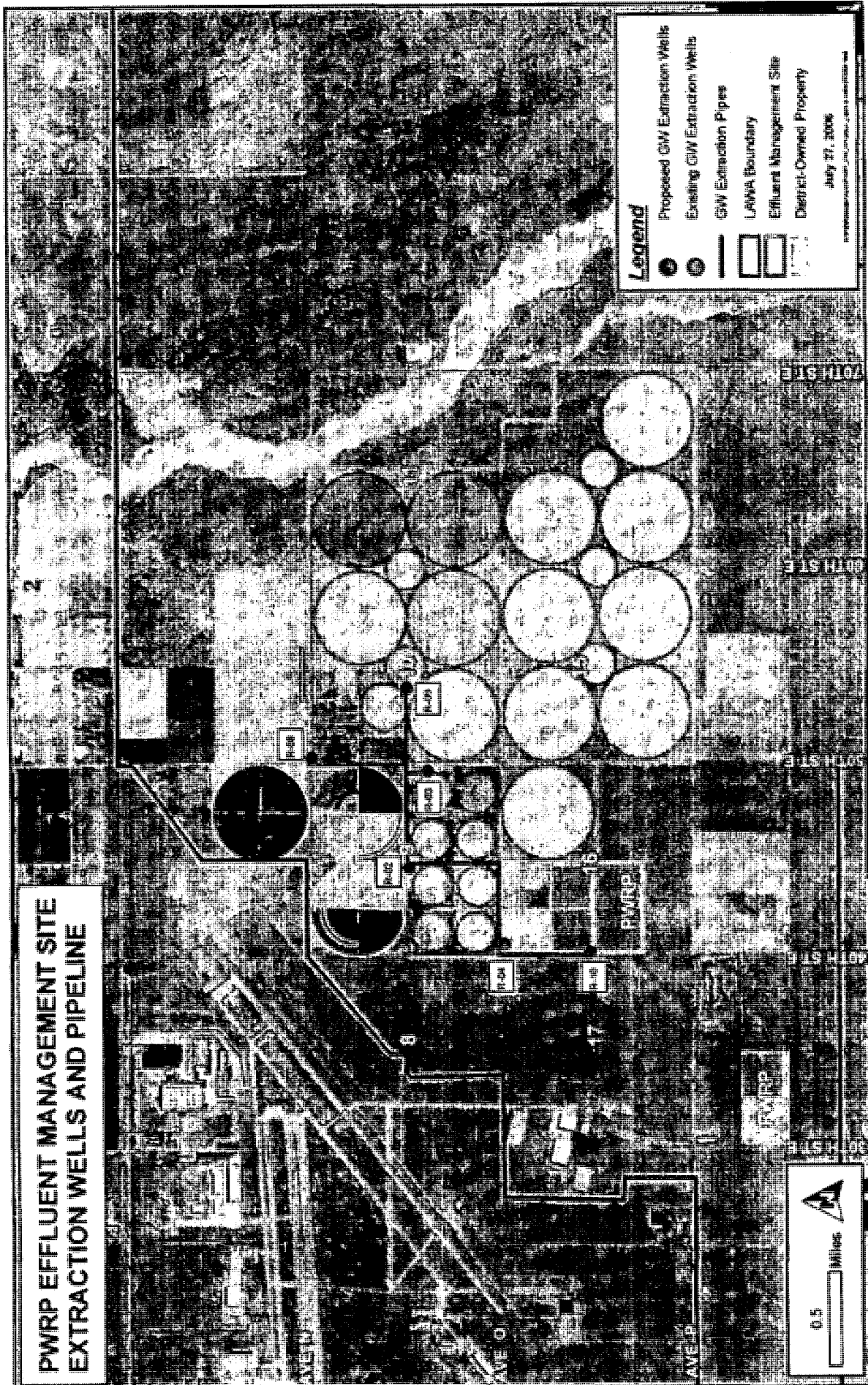

EXHIBIT E- TO CITY OF LOS ANGELES' RESPONSE TO DISCOVERY ORDER



State Water Resources Control Board



Linda S. Adams
*Secretary for
Environmental Protection*

Division of Water Rights
1001 I Street, 14th Floor ♦ Sacramento, California 95814 ♦ 916.341.5300
P.O. Box 2000 ♦ Sacramento, California 95812-2000
Fax: 916.341.5400 ♦ www.waterrights.ca.gov

Arnold Schwarzenegger
Governor

MAY 7 2008

In Reply Refer
To: 300:CN: Co
Sanitation Dist. #20

Raymond L. Tremblay
County Sanitation District
No. 20 of Los Angeles County
39300 30th Street East
Palmdale, CA 93550

FIRST NOTICE GROUNDWATER DIVERSION FORM AND CHECK

We've received your First Notice Groundwater Diversion Form (First Notice) and \$115 check July 18, 2007. Unfortunately your check was made out to the wrong division. Please resubmit a copy of your First Notice and your check made out to 'State Water Resources Control Board, Division of Water Rights'.

Once we receive your check and First Notice we will process your Groundwater Recordation information.

Should you have any questions regarding this matter please contact me at (916) 322-8465, or at Cnease@waterboards.ca.gov.

Sincerely,

Catherine A. Nease
Staff Services Analyst
Data Management Unit

Enclosure: \$115 check

PLEASE COMPLETE. SUBMIT THE ORIGINAL AND MAKE A COPY FOR YOUR RECORDS

State of California, State Water Resources Control Board, Division of Water Rights

P.O. BOX 2000, SACRAMENTO, CA 95812-2000

Info: (916) 341-5300, FAX: (916) 341-5400, Web: <http://www.waterrights.ca.gov>

ANNUAL NOTICE OF GROUNDWATER EXTRACTION AND DIVERSION
(GROUNDWATER RECORDATION PROGRAM)

G193512

2008

2009 JUN 24 AM 11:40

STATE WATER RESOURCES
CONTROL BOARD
DIV OF WATER RIGHTS
SACRAMENTO

If the owner information below is wrong or missing, please correct.

OWNER(S) OF RECORD COUNTY SANITATION DISTRICT NO. 20 OF LA COUNTY

PRIMARY CONTACT OR AGENT FOR MAIL & REPORTING:

COUNTY SANITATION DISTRICT NO. 20 OF LA COUNTY
39300 30TH STREET EAST
PALMDALE, CA 93550

RECORDATION NO: G193512
CONTACT PHONE NO: (562) 908-4288

Owner's Designation of Well
R02

State Well Number
06N/11W-09 S

Parcel Number
3025035294

DEADLINE: Notices must be received no later than **June 30, 2009** in order to be recorded.

REQUIRED FEES: A filing fee of \$115.00 is required for each Annual Notice of Groundwater Extraction and Diversion. Check or money order should indicate your recordation number(s) and be made payable to: State Water Resources Control Board. Do not send cash.

PLEASE READ THE GENERAL INFORMATION ON THE REVERSE SIDE BEFORE COMPLETING THIS NOTICE

If the above information is inaccurate, please line it out in red and provide current information. Notify this office if ownership or address changes occur during the coming year.

1. **TYPE OF DIVERSION** ☒ Groundwater extraction or ☐ Surface diversion

2. **OWNERSHIP. Person listed below is:**

- ☒ Owner of land on which well or point of diversion is located, and is extracting/diverting water.
☐ Lessee of land on which well or point of diversion is located, and is extracting/diverting water.
☐ Owner of land, but lessee is extracting/diverting water.
☐ Other: Please explain: _____

3. **AMOUNT OF GROUNDWATER EXTRACTED DURING CALENDAR YEAR** _____ →

4. **AMOUNT OF SURFACE WATER DIVERTED DURING CALENDAR YEAR** _____ →

5. **METHOD OF MEASUREMENT** ☒ Water Meter ☐ Power Meter ☐ Non-metered or Estimated

6. **TYPE OF WATER USE** ☒ Agricultural ☐ Domestic or Municipal ☐ Other: _____

7. **ACTION REQUESTED (Check one):**

- ☐ Reopen file. (Fee required)
☐ Close this file. (No fee required)
☒ Record my water use. (Fee required)
☐ Do not record my water use but keep my name on mailing list. (No fee required)

130.0	<input checked="" type="checkbox"/> acre-feet
	<input type="checkbox"/> cubic-feet
(Must be a specific number) <input type="checkbox"/> gallons	

Annual quantity	0	<input type="checkbox"/> acre-feet
Season of diversion		<input type="checkbox"/> cubic-feet
Begin		<input type="checkbox"/> gallons
End		
Maximum rate of diversion		

Transfer this file to: _____
(NEW OWNER'S FIRST NAME) (M. NAME) (LAST NAME)

Company Name: _____

Address: _____

(MAILING ADDRESS) (CITY) (STATE) (ZIP CODE)

Telephone: () _____ Effective Date: _____

8. **SUPPLEMENTAL INFORMATION.** Please list any changes in your project since last year (new pump, new land irrigation, new method of irrigation, etc.) or any other comments.

9. **CERTIFICATION AND SIGNATURE:** I certify that the foregoing statements are true and correct to the best of my knowledge.

Signature: Thomas G. Weiland Date: 6/10/09

Printed Name: Thomas E. Weiland
(FIRST NAME) (M. NAME) (LAST NAME)

COMPANY NAME: _____ THIS SPACE FOR OFFICE USE ONLY R. 2754 AMT: \$115.00

GENERAL INFORMATION

The dependence on groundwater in the Counties of Riverside, San Bernardino, Los Angeles, and Ventura has resulted in diminishing water supplies. As water becomes more scarce, determination of your water rights by the courts may become necessary. Your Annual Notice of Groundwater Extraction and Diversion is required to establish a record of water use which can assist the court in determining your rights.

The California Water Code requires you to record your annual surface and groundwater use if your total groundwater extractions from all wells exceed 25 acre-feet. Extractions of less than 10 acre-feet from a single well need not be reported. Although there is no penalty for failure to file the annual notice, failure to file is considered nonuse of water. Therefore, persons who do not file notices may have difficulty in supporting a claim of water use during a lawsuit to establish ownership of groundwater rights.

Exceptions: (1) If you are currently reporting your pumpage to a watermaster, your water use is already on record, and you are exempt from the requirement of filing a notice, or (2) if annual water use is less than the required amounts, filing is optional because these minimal amounts would probably not be affected by a water right dispute. All optional notices that are accompanied by appropriate fees will be recorded.

Should you require additional information about the Water Code requirements or assistance in completing this form, please write to the address on the top of this form, or telephone (916) 341-5300.

TABLE 1: AGRICULTURAL WATER USE WORKSHEET (Optional)

To estimate your use of water, indicate below the crop type and number of acres. Then find the average irrigation requirement for each crop using Table II. Multiply acres (column 1) to applied water depth (column 2) to determine the amount pumped (column 3). Then total all amounts in column 3 to determine total irrigation use.

CROP	COLUMN 1	COLUMN 2	COLUMN 3
	ACRES	AVERAGE APPLIED WATER DEPTH (acre-feet per acre)	AMOUNT PUMPED (acre-feet) (column 1 X column 2)
CONVERSION FACTORS One acre-foot (af) = 43,560 cubic feet = 325,900 gallons One miner's inch is approximately 9 gallons per minute. An acre-foot covers one acre of land, one foot deep			TOTAL IRRIGATION USE

TABLE II: AVERAGE DEPTH OF WATER APPLIED TO IRRIGATE EACH CROP (acre-feet per acre)¹

LOCALITY ²	ALFALFA	AVOCADOS	BEANS	DATES	LEMONS	LETTUCE	PERMANENT PASTURE	TOMATOES
1. Los Angeles County								
a. Coastal Basin		2.0 - 2.5			2.0 - 2.5	2.0 - 2.5		
b. Antelope Valley	7.6						7.4	
2. Eastern Riverside County								
a. Coachella & Blythe Area	9.0 - 10.0			7.9 - 9.0	5.5 - 6.0	3.6 - 4.2	9.0 - 10.0	4.3 - 6.4
3. Western Riverside County	4.0 - 4.5	2.5 - 3.0			2.5 - 3.0	2.0 - 2.5	4.5 - 5.0	
4. San Bernardino County								
a. Chino Area	4.0 - 4.5	2.5 - 3.0			2.5 - 3.0	2.0 - 2.5	4.5 - 5.0	2.3 - 2.5
b. San Bernardino Area	4.0 - 4.5	2.5 - 3.0			2.5 - 3.0	2.0 - 2.5	4.0 - 5.0	2.3 - 2.5
c. Barstow-Apple Valley	6.0 - 6.5						6.0 - 6.5	
d. Ontario	4.0 - 4.5	2.5 - 3.0			2.5 - 3.0		4.0 - 5.0	2.3 - 2.5
e. Highlands-Redlands	4.0 - 4.5	2.5 - 3.0			2.5 - 3.0		4.0 - 5.0	2.3 - 2.5
5. Ventura County	4.0 - 4.5	2.3 - 2.5	1.3 - 1.5		2.3 - 2.5	2.0 - 2.5	4.0 - 4.5	2.0 - 2.5

¹ Based on information provided by Agricultural Extension Service of the University of California.

Updated: Department of Water Resources, Southern District // Backup data for the California Water Plan, Bulletin 160-98. Date August 21, 2000

² Unit use values for crops grown in each region.



State Water Resources Control Board



Linda S. Adams

Secretary for
Environmental Protection

Division of Water Rights

1001 I Street, 14th Floor ♦ Sacramento, California 95814 ♦ 916.341.5300

P.O. Box 2000 ♦ Sacramento, California 95812-2000

Fax: 916.341.5400 ♦ www.waterrights.ca.gov

Arnold Schwarzenegger

Governor

August 13, 2008

COUNTY SANITATION DISTRICT NO. 20 OF LA
COUNTY
39300 30TH STREET EAST
PALMDALE, CA 93550

In Reply Refer to:
300:CN: G193512

FIRST NOTICE GROUNDWATER DIVERSION, GROUNDWATER RECORDATION PROGRAM IN LOS ANGELES COUNTY

The State Water Resources Control Board, Division of Water Rights (Division), received your First Notice Groundwater Diversion form(s) on July 8, 2008. Groundwater Recordation number(s) have been assigned to the State Well Number(s) listed below.

<u>Recordation Number</u>	<u>State Well Number</u>	<u>Owner's Well Designation</u>
G193512	06N/11W-09 S	R02
G193513	06N/11W-09 S	R03
G193514	06N/11W-10 S	R08
G193515	06N/11W-10 S	R09

This number should be referenced in all future communications with the Division concerning your use of water. Please notify the Division of any change in ownership or mailing address

An Annual Notice of Extraction and Diversion of Water (Annual Notice) will be sent to you each year (typically in the spring) for each well to report the amount of water extracted during the previous calendar year. In accordance with the California Water Code, each Annual Notice must be returned to the Division on or before June 30 with the annual filing fee, currently \$115.00, to record your water use. Notices that are received after June 30 will not be recorded. Although there is no penalty for failure to file the Annual Notice, failure to file is considered a nonuse of water for the reporting year.

Should you have questions regarding this matter you can contact me at (916) 322-8465, or Cnease@waterboards.ca.gov.

Sincerely,

Catherine A. Nease
Staff Analyst
Data Management Unit

U:\Herdv\DMU\GROUNDWATER\deficiency ltrs\First notice co. sanitation dist. 20.doc

SURNAME
DWR 540

Handwritten signature and date 8/13/08

EXHIBIT E- TO CITY OF LOS ANGELES' RESPONSE TO DISCOVERY ORDER
California Environmental Protection Agency



State Water Resources Control Board



Linda S. Adams

Secretary for
Environmental Protection

Division of Water Rights

1001 I Street, 14th Floor ♦ Sacramento, California 95814 ♦ 916.341.5300

P.O. Box 2000 ♦ Sacramento, California 95812-2000

Fax: 916.341.5400 ♦ www.waterrights.ca.gov

Arnold Schwarzenegger

Governor

MAY 7 2008

In Reply Refer

To: 300:CN: Co

Sanitation Dist. #20

6193512 - 6193515

Raymond L. Tremblay
County Sanitation District
No. 20 of Los Angeles County
39300 30th Street East
Palmdale, CA 93550

FIRST NOTICE GROUNDWATER DIVERSION FORM AND CHECK

We've received your First Notice Groundwater Diversion Form (First Notice) and \$115 check July 18, 2007. Unfortunately your check was made out to the wrong division. Please resubmit a copy of your First Notice and your check made out to 'State Water Resources Control Board, Division of Water Rights'.

Once we receive your check and First Notice we will process your Groundwater Recordation information.

Should you have any questions regarding this matter please contact me at (916) 322-8465, or at Cnease@waterboards.ca.gov.

Sincerely,

Catherine A. Nease
Staff Services Analyst
Data Management Unit

Enclosure: \$115 check

U:\Herdv\DMU\GROUNDWATER\deficiency ltrs\Co. San.district 20 of LA Co..doc

Complete a separate
notice for each well.

State of California
State Water Resources Control Board
DIVISION OF WATER RIGHTS
P.O. Box 2000, Sacramento, CA 95812-2000
Info: (916) 341-5300, FAX: (916) 341-5300, Web: <http://www.waterrights.ca.gov>

CN

Recordation Number
State Well Number
(Division of Water Rights Use Only)

FIRST NOTICE
GROUNDWATER DIVERSION

(Pursuant to Part 5, Division 2 of the Water Code)

1. Name of person owning the well County Sanitation District No. 20 of Los Angeles County
(Unless otherwise indicated, annual notices will be sent to this name and address)

Address 39300 30th Street East Palmdale, CA 93550
Street address or P.O. Box number City State Zip Code

Telephone Number (562) 908 - 4288 X2801

2. Name of person extracting groundwater (if different than Item 1) _____

Address _____
Street address or P.O. Box number City State Zip Code

Telephone Number () _____ - _____

WELL LOCATION

3. Owner's designation of well R-02 4. County Los Angeles

5. County Assessor's Parcel Number 3025035294

6. Describe location of well to the nearest 40-acre quarter section. State well number (if known) _____

Northeast $\frac{1}{4}$, of Southwest $\frac{1}{4}$, Section 9, Township 06N

Range 11W, San Bernardino B. & M.

7. Indicate location of well in the section grid below, or provide a copy of the USGS quadrangle map with the well location marked. The place of use should also be indicated. The grid represents one whole section.

Section 9, Township 06N, Range 11W,

Quadrangle map name San Bernardino

	X		

OK

WATER USE

8. Describe the Place of Use (If sketch is required, please use grid under item 7) Used to irrigate crops in sections 10, 11, and 14-16 of Township 06N, Range 11W, San Bernardino Meridian.

9. Quantity and Use of water extracted and method used in determining quantity for the last calendar year.

Calendar Year	EXTRACTIONS		USE		
			When use is for irrigation		When use is other than irrigation
	Annual extractions in acre-feet or _____ (specify unit)	Method of measurement or of estimate (specify)	Crops served	Acreage Supplied	Nature and extent of use, i.e. population, products manufactured, number and kind of stock watered
20 06	30 AF	Est. w/Flow Meters	Fodder	1,593	

10. Do you also divert surface water? No
Yes or No

11. If answer (to 10 above) is yes, how are you reporting surface water use?

- a. Under Statement of Water Diversion and Use procedures..... ☐
- b. Under Annual Recordation Notice procedures ☐
- c. Under Appropriative Water Right procedures ☐
- d. Not reporting ☐

WELL DATA

12. Is the place of use also served by another well? Yes (see Attachment 1) Another water source? Yes
Yes or No Yes or No

13. If yes to either, describe Six extraction wells supplementing Palmdale Water Reclamation Plant Effluent

14. Type, make and horsepower of pump Submersible, Grundfos, 20Hp Date installed August 11, 2006

15. Pump tests CH2M Hill, August 4, 2006, 125, 75%
Conducted by Date Discharge rate gpm Pump efficiency

16. Power supply Southern California Edison, Currently, temp. power, August 4, 2006
Source Meter No. Date installed

17. Depth of well 452 feet. 18. Casing diameter Internal Diameter is 8 inches.

19. Is well gravel-packed? Yes 20. Date drilled July 1, 2006
Yes or No

21. What are the upper and lower depths of casing perforations? Upper 315.4 feet Lower 446.6 feet
(Show feet from ground surface)

22. Is log of well available? Yes Where? County Sanitation District of Los Angeles County (CSDLAC)
Yes or No

23. Has a chemical analysis of well water been made? Yes If yes, where can it be obtained? CSDLAC
Yes or No

24. Are water level measurements available? Yes Where? CSDLAC

PLEASE NOTE THAT:

A willful misstatement in this notice is a misdemeanor pursuant to Section 5008 of the Water Code.

A \$115.00 filing fee must accompany each notice.

I certify that the foregoing required statements and the following optional additional statements, if any, are true and correct to the best of my knowledge and belief.

Name Raymond J. Tremblay

Signature 

Title Monitoring Section Head Date May 29, 2007

At (City of P.O.) Whittier, CA

Firm or
Corporate Name County Sanitation District No. 20 of Los Angeles County







**PWRP EFFLUENT MANAGEMENT SITE
EXTRACTION WELLS AND PIPELINE**

Legend

- Proposed GW Extraction Wells
- Existing GW Extraction Wells
- GW Extraction Pipes
- LAWA Boundary
- Effluent Management Site
- District-Owned Property

0.5 Miles

July 27, 2006

 Proposed GW Extraction Wells
 Existing GW Extraction Wells
 GW Extraction Pipes
 LAWA Boundary
 Effluent Management Site
 District-Owned Property

For more information, call 1-800-451-7234 or visit www.451.com



[FINAL SUBMITTED VERSION]**ANNUAL NOTICE OF GROUNDWATER EXTRACTION AND DIVERSION FOR 2011**

Primary Owner: County Sanitation District No. 20 of LA County

Recordation Number: G193513

Date Submitted: 2012-06-11

1. Reporting to a Local Agency	
Local Agency	Submitter does not report to a local agency.

2. Type(s) of Diversion	
a. Groundwater Extraction	> 25 acre-feet
b. Surface Diversion	None

3. Ownership Type of Owner(s) on Record	
Ownership Type	Lessee of land on which well or point of diversion is located, and is extracting/diverting water

4. Amount of Groundwater Extracted During Calendar Year	
Amount Extracted	169 Acre-Feet

5. Amount of Surface Water Diverted or Used	
Not applicable; Surface Diversion was not chosen as a type of diversion.	

5d. Maximum Rate of Surface Water Diversion	
Not applicable; Surface Diversion was not chosen as a type of diversion.	

6. Method of Measurement	
Method of Measurement	Water Meter

7. Type(s) of Use	
Irrigation	2010 Acres Mixed Crop Types

8. Action Requested	
Action Requested	Record my water use

9. Supplemental Information	
Supplemental Information	A total of 603 AFY of groundwater and 8828 AFY of recycled water are used at wells G193512-G193515.

Attachments		
File Name	Description	Size
No Attachments		

Contact Information of the Person Submitting the Form	
First Name	Ann
Last Name	Heil
Relation to Water Right	

EXHIBIT E- TO CITY OF LOS ANGELES' RESPONSE TO DISCOVERY ORDER

I read the above and
agree

Yes

[FINAL SUBMITTED VERSION]**ANNUAL NOTICE OF GROUNDWATER EXTRACTION AND DIVERSION FOR 2010**

Primary Owner: County Sanitation District No. 20 of LA County

Recordation Number: G193513

Date Submitted: 2011-06-28

Reporting to a Local Agency	
Local Agency	Submitter does not report to a local agency.

Type(s) of Diversion	
Groundwater Extraction	> 25 acre-feet
Surface Diversion	None

Ownership Type of Owner(s) on Record	
Ownership Type	Lessee of land on which well or point of diversion is located, and is extracting/diverting water

Amount of Groundwater Extracted During Calendar Year	
Amount Extracted	167 Acre-Feet

Amount of Surface Water Diverted or Used	
Not applicable; Surface Diversion was not chosen as a type of diversion.	

Maximum Rate of Surface Water Diversion	
Not applicable; Surface Diversion was not chosen as a type of diversion.	

Method of Measurement	
Method of Measurement	Water Meter

Purpose(s) of Use	
Irrigation	2010 Acres Mixed Crop Types

Action Requested	
Action Requested	Record my water use

Supplemental Information	
Supplemental Information	A total of 570 AFY of groundwater and 6917 AFY of recycled water are used at wells G193512-G193515.

Attachments	
File Name	Size
No Attachments	

Contact Information of the Person Submitting the Form	
First Name	Tom
Last Name	Weiland
I read the above and agree	Yes



G193513



G193513

Complete a separate
notice for each well.

State of California
State Water Resources Control Board
DIVISION OF WATER RIGHTS
P.O. Box 2000, Sacramento, CA 95812-2000
Info: (916) 341-5300, FAX: (916) 341-5300, Web: <http://www.waterrights.ca.gov>

Recordation Number G 193513
State Well Number 06N/11W-09 5 (Division of Water Rights Use Only)

**FIRST NOTICE
GROUNDWATER DIVERSION**

(Pursuant to Part 5, Division 2 of the Water Code)

1. Name of person owning the well County Sanitation District No. 20 of Los Angeles County
(Unless otherwise indicated, annual notices will be sent to this name and address)

Address 39300 30th Street East Palmdale, CA 93550
Street address or P.O. Box number City State Zip Code

Telephone Number (562) 908 - 4288 X2801

2. Name of person extracting groundwater (if different than Item 1) _____

Address _____
Street address or P.O. Box number City State Zip Code

Telephone Number () _____ - _____

WELL LOCATION

3. Owner's designation of well R-03 4. County Los Angeles

5. County Assessor's Parcel Number 3025047282

6. Describe location of well to the nearest 40-acre quarter section. State well number (if known) _____

Northeast $\frac{1}{4}$, of Southwest $\frac{1}{4}$, Section 9, Township 06N
Range 11W, San Bernardino B. & M.

7. Indicate location of well in the section grid below, or provide a copy of the USGS quadrangle map with the well location marked. The place of use should also be indicated. The grid represents one whole section.

Section 9, Township 06N, Range 11W

Quadrangle map name San Bernardino

			X

UP 5/17/11

POD ID: 52973

N: 34° 37' 22.9"

W: 118° 2' 28.7"

STATE WATER RESOURCES
CONTROL BOARD
2008 JUL - 8 AM 11:43
DIVISION OF WATER RIGHTS
SACRAMENTO

Rec'd
7/8/08
\$115.00
MS

WATER USE

8. Describe the Place of Use (If sketch is required, please use grid under item 7) Used to irrigate crops in sections 10, 11, and 14-16 of Township 06N, Range 11W, San Bernardino Meridian.

9. Quantity and Use of water extracted and method used in determining quantity for the last calendar year.

Calendar Year	EXTRACTIONS		USE		
			When use is for irrigation		When use is other than irrigation
	Annual extractions in acre-feet or _____ (specify unit)	Method of measurement or of estimate (specify)	Crops served	Acreage Supplied	Nature and extent of use, i.e. population, products manufactured, number and kind of stock watered
2007	107 AF	Est. w/Flow Meters	Fodder	2,010	

10. Do you also divert surface water? No
Yes or No

11. If answer (to 10 above) is yes, how are you reporting surface water use?

- a. Under Statement of Water Diversion and Use procedures..... ☐
- b. Under Annual Recordation Notice procedures ☐
- c. Under Appropriative Water Right procedures ☐
- d. Not reporting..... ☐

WELL DATA

12. Is the place of use also served by another well? Yes (see Attachment 1) Another water source? Yes
Yes or No Yes or No

13. If yes to either, describe Six extraction wells supplementing Palmdale Water Reclamation Plant Effluent

14. Type, make and horsepower of pump Submersible, Grundfos, 20Hp Date installed September 19, 2006

15. Pump tests CH2M Hill, August 4, 2006, 140, 75%
Conducted by Date Discharge rate gpm Pump efficiency

16. Power supply Southern California Edison, 3416-05182, August 4, 2006
Source Meter No. Date installed

17. Depth of well 425 feet. 18. Casing diameter Internal Diameter is 8 inches.

19. Is well gravel-packed? Yes 20. Date drilled July 17, 2006
Yes or No

21. What are the upper and lower depths of casing perforations? Upper 322.9-361.6 feet Lower 383.1-420.0 feet
(Show feet from ground surface)

22. Is log of well available? Yes Where? County Sanitation District of Los Angeles County (CSDLAC)
Yes or No

23. Has a chemical analysis of well water been made? Yes If yes, where can it be obtained? CSDLAC
Yes or No

24. Are water level measurements available? Yes Where? CSDLAC

PLEASE NOTE THAT:

**A willful misstatement in this notice is a misdemeanor pursuant to Section 5008 of the Water Code.
A \$115.00 filing fee must accompany each notice.**

I certify that the foregoing required statements and the following optional additional statements, if any, are true and correct to the best of my knowledge and belief.

Name Raymond L. Tremblay

Signature 

Title Monitoring Section Head Date June 23, 2008

At (City of P.O.) Whittier, CA

Firm or
Corporate Name County Sanitation District No. 20 of Los Angeles County

PWRP EFFLUENT MANAGEMENT SITE EXTRACTION PIPES & WELLS

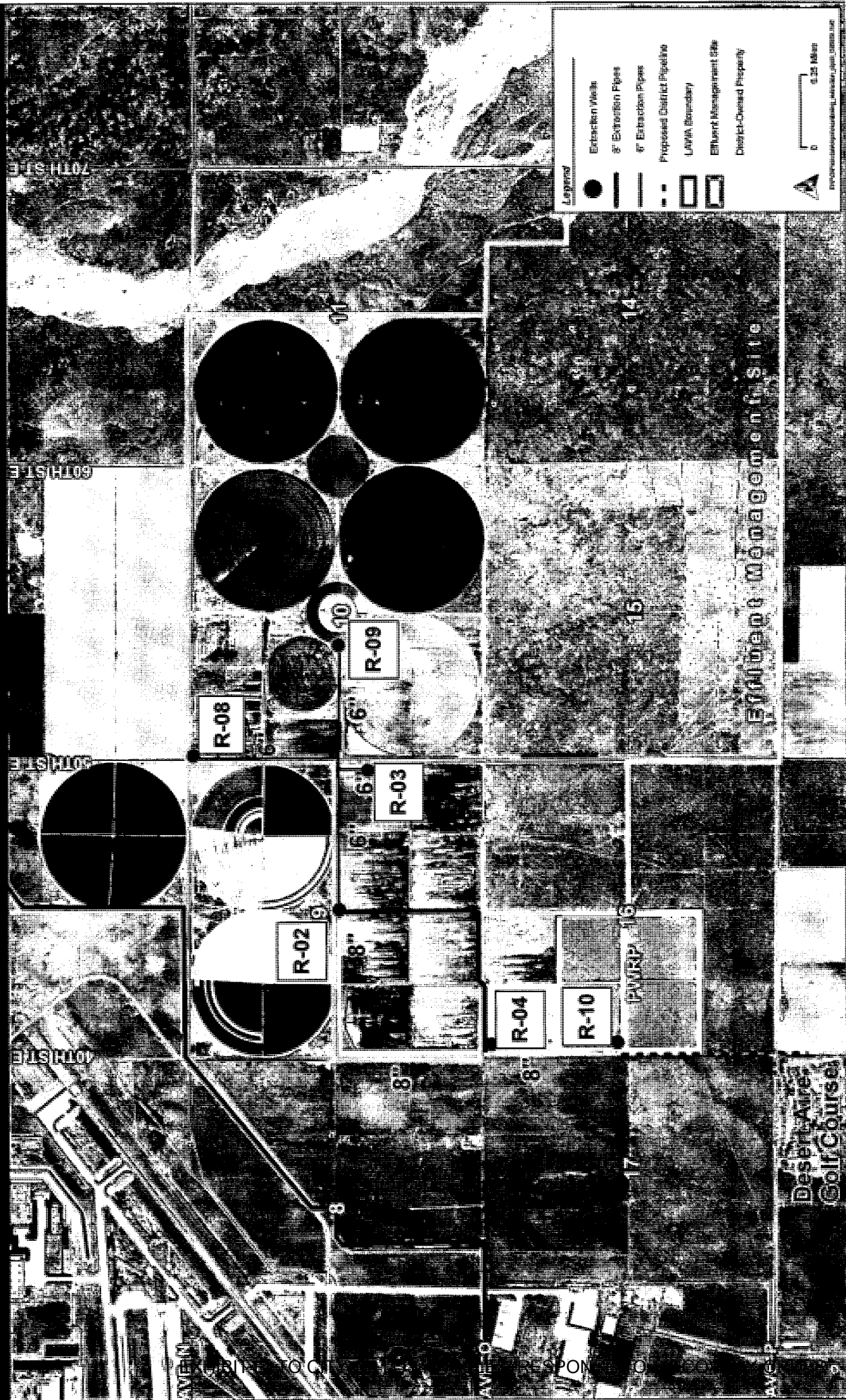



State Water Resources Control Board



Linda S. Adams
Secretary for
Environmental Protection

Division of Water Rights
1001 I Street, 14th Floor ♦ Sacramento, California 95814 ♦ 916.341.5300
P.O. Box 2000 ♦ Sacramento, California 95812-2000
Fax: 916.341.5400 ♦ www.waterrights.ca.gov

Arnold Schwarzenegger
Governor

August 13, 2008

COUNTY SANITATION DISTRICT NO. 20 OF LA
COUNTY
39300 30TH STREET EAST
PALMDALE, CA 93550

In Reply Refer to:
300:CN: G193512

FIRST NOTICE GROUNDWATER DIVERSION, GROUNDWATER RECORDATION PROGRAM IN LOS ANGELES COUNTY

The State Water Resources Control Board, Division of Water Rights (Division), received your First Notice Groundwater Diversion form(s) on July 8, 2008. Groundwater Recordation number(s) have been assigned to the State Well Number(s) listed below.

<u>Recordation Number</u>	<u>State Well Number</u>	<u>Owner's Well Designation</u>
G193512	06N/11W-09 S	R02
G193513	06N/11W-09 S	R03
G193514	06N/11W-10 S	R08
G193515	06N/11W-10 S	R09

This number should be referenced in all future communications with the Division concerning your use of water. Please notify the Division of any change in ownership or mailing address

An Annual Notice of Extraction and Diversion of Water (Annual Notice) will be sent to you each year (typically in the spring) for each well to report the amount of water extracted during the previous calendar year. In accordance with the California Water Code, each Annual Notice must be returned to the Division on or before June 30 with the annual filing fee, currently \$115.00, to record your water use. Notices that are received after June 30 will not be recorded. Although there is no penalty for failure to file the Annual Notice, failure to file is considered a nonuse of water for the reporting year.

Should you have questions regarding this matter you can contact me at (916) 322-8465, or Cnease@waterboards.ca.gov.

Sincerely,

Catherine A. Nease
Staff Analyst
Data Management Unit

U:\Herdrv\DMU\GROUNDWATER\deficiency ltrs\First notice co. sanitation dist. 20.doc

SURNAME
DWR 540

EXHIBIT TO CITY OF LOS ANGELES RESPONSE TO DISCOVERY ORDER
California Environmental Protection Agency

PLEASE COMPLETE. SUBMIT THE ORIGINAL AND MAKE A COPY FOR YOUR RECORDS

State of California, State Water Resources Control Board, Division of Water Rights
P.O. BOX 2000, SACRAMENTO, CA 95812-2000

Info: (916) 341-5300, FAX: (916) 341-5400, Web: <http://www.waterrights.ca.gov>

ANNUAL NOTICE OF GROUNDWATER EXTRACTION AND DIVERSION
(GROUNDWATER RECORDATION PROGRAM)

2009 JUN 24 AM 11:40

G193513

2008

If the owner information below is wrong or missing, please correct.

OWNER(S) OF RECORD COUNTY SANITATION DISTRICT NO. 20 OF LA COUNTY

PRIMARY CONTACT OR AGENT FOR MAIL & REPORTING:

COUNTY SANITATION DISTRICT NO. 20 OF LA COUNTY
39300 30TH STREET EAST
PALMDALE, CA 93550

RECORDATION NO: G193513
CONTACT PHONE NO: (562) 908-4288

Owner's Designation of Well
R03

State Well Number
06N/11W-09 S

Parcel Number
3025047282

DEADLINE: Notices must be received no later than **June 30, 2009** in order to be recorded.

REQUIRED FEES: A filing fee of \$115.00 is required for each Annual Notice of Groundwater Extraction and Diversion. Check or money order should indicate your recordation number(s) and be made payable to: State Water Resources Control Board. Do not send cash.

PLEASE READ THE GENERAL INFORMATION ON THE REVERSE SIDE BEFORE COMPLETING THIS NOTICE

If the above information is inaccurate, please line it out in red and provide current information. Notify this office if ownership or address changes occur during the coming year.

1. **TYPE OF DIVERSION** ☒ Groundwater extraction or ☐ Surface diversion

2. **OWNERSHIP. Person listed below is:**

- ☒ Owner of land on which well or point of diversion is located, and is extracting/diverting water.
☐ Lessee of land on which well or point of diversion is located, and is extracting/diverting water.
☐ Owner of land, but lessee is extracting/diverting water.
☐ Other: Please explain: _____

3. **AMOUNT OF GROUNDWATER EXTRACTED DURING CALENDAR YEAR** _____

4. **AMOUNT OF SURFACE WATER DIVERTED DURING CALENDAR YEAR** _____

5. **METHOD OF MEASUREMENT** ☒ Water Meter ☐ Power Meter ☐ Non-metered or Estimated

6. **TYPE OF WATER USE** ☒ Agricultural ☐ Domestic or Municipal ☐ Other: _____

7. **ACTION REQUESTED (Check one):**

- ☐ Reopen file. (Fee required)
☐ Close this file. (No fee required)
☒ Record my water use. (Fee required)
☐ Do not record my water use but keep my name on mailing list. (No fee required)

131.8	<input checked="" type="checkbox"/> acre-feet
	<input type="checkbox"/> cubic-feet
(Must be a specific number) <input type="checkbox"/> gallons	

Annual quantity	0	<input type="checkbox"/> acre-feet
Season of diversion		<input type="checkbox"/> cubic-feet
Begin		<input type="checkbox"/> gallons
End		
Maximum rate of diversion		

Transfer this file to: _____
(NEW OWNER'S FIRST NAME) (M. NAME) (LAST NAME)

Company Name: _____

Address: _____
(MAILING ADDRESS) (CITY) (STATE) (ZIP CODE)

Telephone: () _____ Effective Date: _____

8. **SUPPLEMENTAL INFORMATION.** Please list any changes in your project since last year (new pump, new land irrigation, new method of irrigation, etc.) or any other comments.

9. **CERTIFICATION AND SIGNATURE:** I certify that the forgoing statements are true and correct to the best of my knowledge.

Signature: _____ Date: 6/10/09

Printed Name: Thomas E. Weiland
(FIRST NAME) (M. NAME) (LAST NAME)

COMPANY NAME: _____ THIS SPACE FOR OFFICE USE ONLY R. 2754 AMT: \$115.00

GENERAL INFORMATION

The dependence on groundwater in the Counties of Riverside, San Bernardino, Los Angeles, and Ventura has resulted in diminishing water supplies. As water becomes more scarce, determination of your water rights by the courts may become necessary. Your Annual Notice of Groundwater Extraction and Diversion is required to establish a record of water use which can assist the court in determining your rights.

The California Water Code requires you to record your annual surface and groundwater use if your total groundwater extractions from all wells exceed 25 acre-feet. Extractions of less than 10 acre-feet from a single well need not be reported. Although there is no penalty for failure to file the annual notice, failure to file is considered nonuse of water. Therefore, persons who do not file notices may have difficulty in supporting a claim of water use during a lawsuit to establish ownership of groundwater rights.

Exceptions: (1) If you are currently reporting your pumpage to a watermaster, your water use is already on record, and you are exempt from the requirement of filing a notice, or (2) if annual water use is less than the required amounts, filing is optional because these minimal amounts would probably not be affected by a water right dispute. All optional notices that are accompanied by appropriate fees will be recorded.

Should you require additional information about the Water Code requirements or assistance in completing this form, please write to the address on the top of this form, or telephone (916) 341-5300.

TABLE 1: AGRICULTURAL WATER USE WORKSHEET (Optional)

To estimate your use of water, indicate below the crop type and number of acres. Then find the average irrigation requirement for each crop using Table II. Multiply acres (column 1) to applied water depth (column 2) to determine the amount pumped (column 3). Then total all amounts in column 3 to determine total irrigation use.

CROP	COLUMN 1 ACRES	COLUMN 2 AVERAGE APPLIED WATER DEPTH (acre-feet per acre)	COLUMN 3 AMOUNT PUMPED (acre-feet) (column 1 X column 2)
CONVERSION FACTORS One acre-foot (af) = 43,560 cubic feet = 325,900 gallons One miner's inch is approximately 9 gallons per minute. An acre-foot covers one acre of land, one foot deep			TOTAL IRRIGATION USE

TABLE II: AVERAGE DEPTH OF WATER APPLIED TO IRRIGATE EACH CROP (acre-feet per acre)¹

LOCALITY ²	ALFALFA	AVOCADOS	BEANS	DATES	LEMONS	LETTUCE	PERMANENT PASTURE	TOMATOES
1. Los Angeles County								
a. Coastal Basin		2.0 - 2.5			2.0 - 2.5	2.0 - 2.5		
b. Antelope Valley	7.6						7.4	
2. Eastern Riverside County								
a. Coachella & Blythe Area	9.0 - 10.0			7.9 - 9.0	5.5 - 6.0	3.6 - 4.2	9.0 - 10.0	4.3 - 6.4
3. Western Riverside County	4.0 - 4.5	2.5 - 3.0			2.5 - 3.0	2.0 - 2.5	4.5 - 5.0	
4. San Bernardino County								
a. Chino Area	4.0 - 4.5	2.5 - 3.0			2.5 - 3.0	2.0 - 2.5	4.5 - 5.0	2.3 - 2.5
b. San Bernardino Area	4.0 - 4.5	2.5 - 3.0			2.5 - 3.0	2.0 - 2.5	4.0 - 5.0	2.3 - 2.5
c. Barstow-Apple Valley	6.0 - 6.5						6.0 - 6.5	
d. Ontario	4.0 - 4.5	2.5 - 3.0			2.5 - 3.0		4.0 - 5.0	2.3 - 2.5
e. Highlands-Redlands	4.0 - 4.5	2.5 - 3.0			2.5 - 3.0		4.0 - 5.0	2.3 - 2.5
5. Ventura County	4.0 - 4.5	2.3 - 2.5	1.3 - 1.5		2.3 - 2.5	2.0 - 2.5	4.0 - 4.5	2.0 - 2.5

¹ Based on information provided by Agricultural Extension Service of the University of California.

Updated: Department of Water Resources, Southern District // Backup data for the California Water Plan, Bulletin 160-98. Date August 21, 2000

² Unit use values for crops grown in each region.

[FINAL SUBMITTED VERSION]

ANNUAL NOTICE OF GROUNDWATER EXTRACTION AND DIVERSION FOR 2011

Primary Owner: County Sanitation District No. 20 of LA County

Recordation Number: G193514

Date Submitted: 2012-06-11

1. Reporting to a Local Agency	
Local Agency	Submitter does not report to a local agency.

2. Type(s) of Diversion	
a. Groundwater Extraction	> 25 acre-feet
b. Surface Diversion	None

3. Ownership Type of Owner(s) on Record	
Ownership Type	Lessee of land on which well or point of diversion is located, and is extracting/diverting water

4. Amount of Groundwater Extracted During Calendar Year	
Amount Extracted	195 Acre-Feet

5. Amount of Surface Water Diverted or Used	
Not applicable; Surface Diversion was not chosen as a type of diversion.	

5d. Maximum Rate of Surface Water Diversion	
Not applicable; Surface Diversion was not chosen as a type of diversion.	

6. Method of Measurement	
Method of Measurement	Water Meter

7. Type(s) of Use	
Irrigation	2010 Acres Mixed Crop Types

8. Action Requested	
Action Requested	Record my water use

9. Supplemental Information	
Supplemental Information	A total of 603 AFY of groundwater and 8828 AFY of recycled water are used at wells G193512-G193515.

Attachments		
File Name	Descripton	Size
No Attachments		

Contact Information of the Person Submitting the Form	
First Name	Ann
Last Name	Heil
Relation to Water Right	



I read the above and agree

Yes

[FINAL SUBMITTED VERSION]**ANNUAL NOTICE OF GROUNDWATER EXTRACTION AND DIVERSION FOR 2010**

Primary Owner: County Sanitation District No. 20 of LA County

Recordation Number: G193514

Date Submitted: 2011-06-28

Reporting to a Local Agency	
Local Agency	Submitter does not report to a local agency.

Type(s) of Diversion	
Groundwater Extraction	> 25 acre-feet
Surface Diversion	None

Ownership Type of Owner(s) on Record	
Ownership Type	Lessee of land on which well or point of diversion is located, and is extracting/diverting water

Amount of Groundwater Extracted During Calendar Year	
Amount Extracted	172 Acre-Feet

Amount of Surface Water Diverted or Used	
Not applicable; Surface Diversion was not chosen as a type of diversion.	

Maximum Rate of Surface Water Diversion	
Not applicable; Surface Diversion was not chosen as a type of diversion.	

Method of Measurement	
Method of Measurement	Water Meter

Purpose(s) of Use	
Irrigation	2010 Acres Mixed Crop Types

Action Requested	
Action Requested	Record my water use

Supplemental Information	
Supplemental Information	A total of 570 AFY of groundwater and 6917 AFY of recycled water are used at wells G193512-G193515.

Attachments	
File Name	Size
No Attachments	

Contact Information of the Person Submitting the Form	
First Name	Tom
Last Name	Weiland
I read the above and agree	Yes



EXHIBIT E- TO CITY OF LOS ANGELES' RESPONSE TO DISCOVERY ORDER

G193514



G193514

PLEASE COMPLETE. SUBMIT THE ORIGINAL AND MAKE A COPY FOR YOUR RECORDS

State of California, State Water Resources Control Board, Division of Water Rights
P.O. BOX 2000, SACRAMENTO, CA 95812-2000

Info: (916) 341-5300, FAX: (916) 341-5400, Web: http://www.waterrights.ca.gov

ANNUAL NOTICE OF GROUNDWATER EXTRACTION AND DIVERSION
(GROUNDWATER RECORDATION PROGRAM)

STATE WATER RESOURCES
CONTROL BOARD

G193514

2009 JUN 24 AM 11:40

2008

If the owner information below is wrong or missing, please correct.

OWNER(S) OF RECORD COUNTY SANITATION DISTRICT NO. 20 OF LA COUNTY

DIV OF WATER RIGHTS
SACRAMENTO

PRIMARY CONTACT OR AGENT FOR MAIL & REPORTING:

COUNTY SANITATION DISTRICT NO. 20 OF LA COUNTY
39300 30TH STREET EAST
PALMDALE, CA 93550

RECORDATION NO: G193514
CONTACT PHONE NO: (562) 908-4288

Owner's Designation of Well
R08

State Well Number
06N/11W-10 S

Parcel Number
3025054275

DEADLINE: Notices must be received no later than **June 30, 2009** in order to be recorded.

REQUIRED FEES: A filing fee of \$115.00 is required for each Annual Notice of Groundwater Extraction and Diversion. Check or money order should indicate your recordation number(s) and be made payable to: State Water Resources Control Board. Do not send cash.

PLEASE READ THE GENERAL INFORMATION ON THE REVERSE SIDE BEFORE COMPLETING THIS NOTICE

If the above information is inaccurate, please line it out in red and provide current information. Notify this office if ownership or address changes occur during the coming year.

1. **TYPE OF DIVERSION** ☒ Groundwater extraction or ☐ Surface diversion

2. **OWNERSHIP. Person listed below is:**

- ☒ Owner of land on which well or point of diversion is located, and is extracting/diverting water.
☐ Lessee of land on which well or point of diversion is located, and is extracting/diverting water.
☐ Owner of land, but lessee is extracting/diverting water.
☐ Other: Please explain: _____

3. **AMOUNT OF GROUNDWATER EXTRACTED DURING CALENDAR YEAR** _____ →

4. **AMOUNT OF SURFACE WATER DIVERTED DURING CALENDAR YEAR** _____ →

5. **METHOD OF MEASUREMENT** ☒ Water Meter ☐ Power Meter ☐ Non-metered or Estimated

6. **TYPE OF WATER USE** ☒ Agricultural ☐ Domestic or Municipal ☐ Other: _____

7. **ACTION REQUESTED (Check one):**

- ☐ Reopen file. (Fee required)
☐ Close this file. (No fee required)
☒ Record my water use. (Fee required)
☐ Do not record my water use but keep my name on mailing list. (No fee required)

146.5	<input checked="" type="checkbox"/> acre-feet
	<input type="checkbox"/> cubic-feet
(Must be a specific number) <input type="checkbox"/> gallons	

Annual quantity	0	<input type="checkbox"/> acre-feet
Season of diversion		<input type="checkbox"/> cubic-feet
Begin		<input type="checkbox"/> gallons
End		
Maximum rate of diversion		

Transfer this file to: _____

(NEW OWNER'S FIRST NAME) (M. NAME) (LAST NAME)

Company Name: _____

Address: _____

(MAILING ADDRESS) (CITY) (STATE) (ZIP CODE)

Telephone: () _____ Effective Date: _____

8. **SUPPLEMENTAL INFORMATION.** Please list any changes in your project since last year (new pump, new land irrigation, new method of irrigation, etc.) or any other comments.

9. **CERTIFICATION AND SIGNATURE:** I certify that the forgoing statements are true and correct to the best of my knowledge.

Signature: Thomas G. Weiland Date: 6/10/09

Printed Name Thomas E Weiland
(FIRST NAME) (M. NAME) (LAST NAME)

COMPANY NAME: _____ THIS SPACE FOR OFFICE USE ONLY R. 2754 AMT: \$115.00

JUN 30 2009

GENERAL INFORMATION

The dependence on groundwater in the Counties of Riverside, San Bernardino, Los Angeles, and Ventura has resulted in diminishing water supplies. As water becomes more scarce, determination of your water rights by the courts may become necessary. Your Annual Notice of Groundwater Extraction and Diversion is required to establish a record of water use which can assist the court in determining your rights.

The California Water Code requires you to record your annual surface and groundwater use if your total groundwater extractions from all wells exceed 25 acre-feet. Extractions of less than 10 acre-feet from a single well need not be reported. Although there is no penalty for failure to file the annual notice, failure to file is considered nonuse of water. Therefore, persons who do not file notices may have difficulty in supporting a claim of water use during a lawsuit to establish ownership of groundwater rights.

Exceptions: (1) If you are currently reporting your pumpage to a watermaster, your water use is already on record, and you are exempt from the requirement of filing a notice, or (2) if annual water use is less than the required amounts, filing is optional because these minimal amounts would probably not be affected by a water right dispute. All optional notices that are accompanied by appropriate fees will be recorded.

Should you require additional information about the Water Code requirements or assistance in completing this form, please write to the address on the top of this form, or telephone (916) 341-5300.

TABLE 1: AGRICULTURAL WATER USE WORKSHEET (Optional)

To estimate your use of water, indicate below the crop type and number of acres. Then find the average irrigation requirement for each crop using Table II. Multiply acres (column 1) to applied water depth (column 2) to determine the amount pumped (column 3). Then total all amounts in column 3 to determine total irrigation use.

CROP	COLUMN 1	COLUMN 2	COLUMN 3
	ACRES	AVERAGE APPLIED WATER DEPTH (acre-feet per acre)	AMOUNT PUMPED (acre-feet) (column 1 X column 2)
CONVERSION FACTORS One acre-foot (af) = 43,560 cubic feet = 325,900 gallons One miner's inch is approximately 9 gallons per minute. An acre-foot covers one acre of land, one foot deep			TOTAL IRRIGATION USE

TABLE II: AVERAGE DEPTH OF WATER APPLIED TO IRRIGATE EACH CROP (acre-feet per acre)¹

LOCALITY ²	ALFALFA	AVOCADOS	BEANS	DATES	LEMONS	LETTUCE	PERMANENT PASTURE	TOMATOES
1. Los Angeles County								
a. Coastal Basin		2.0 - 2.5			2.0 - 2.5	2.0 - 2.5		
b. Antelope Valley	7.6						7.4	
2. Eastern Riverside County								
a. Coachella & Blythe Area	9.0 - 10.0			7.9 - 9.0	5.5 - 6.0	3.6 - 4.2	9.0 - 10.0	4.3 - 6.4
3. Western Riverside County	4.0 - 4.5	2.5 - 3.0			2.5 - 3.0	2.0 - 2.5	4.5 - 5.0	
4. San Bernardino County								
a. Chino Area	4.0 - 4.5	2.5 - 3.0			2.5 - 3.0	2.0 - 2.5	4.5 - 5.0	2.3 - 2.5
b. San Bernardino Area	4.0 - 4.5	2.5 - 3.0			2.5 - 3.0	2.0 - 2.5	4.0 - 5.0	2.3 - 2.5
c. Barstow-Apple Valley	6.0 - 6.5						6.0 - 6.5	
d. Ontario	4.0 - 4.5	2.5 - 3.0			2.5 - 3.0		4.0 - 5.0	2.3 - 2.5
e. Highlands-Redlands	4.0 - 4.5	2.5 - 3.0			2.5 - 3.0		4.0 - 5.0	2.3 - 2.5
5. Ventura County	4.0 - 4.5	2.3 - 2.5	1.3 - 1.5		2.3 - 2.5	2.0 - 2.5	4.0 - 4.5	2.0 - 2.5

¹ Based on information provided by Agricultural Extension Service of the University of California.

Updated: Department of Water Resources, Southern District // Backup data for the California Water Plan, Bulletin 160-98. Date August 21, 2000

² Unit use values for crops grown in each region.



State Water Resources Control Board



Linda S. Adams
Secretary for
Environmental Protection

Division of Water Rights
1001 I Street, 14th Floor ♦ Sacramento, California 95814 ♦ 916.341.5300
P.O. Box 2000 ♦ Sacramento, California 95812-2000
Fax: 916.341.5400 ♦ www.waterrights.ca.gov

Arnold Schwarzenegger
Governor

August 13, 2008

COUNTY SANITATION DISTRICT NO. 20 OF LA
COUNTY
39300 30TH STREET EAST
PALMDALE, CA 93550

In Reply Refer to:
300:CN: G193512

FIRST NOTICE GROUNDWATER DIVERSION, GROUNDWATER RECORDATION PROGRAM IN LOS ANGELES COUNTY

The State Water Resources Control Board, Division of Water Rights (Division), received your First Notice Groundwater Diversion form(s) on July 8, 2008. Groundwater Recordation number(s) have been assigned to the State Well Number(s) listed below.

<u>Recordation Number</u>	<u>State Well Number</u>	<u>Owner's Well Designation</u>
G193512	06N/11W-09 S	R02
G193513	06N/11W-09 S	R03
G193514	06N/11W-10 S	R08
G193515	06N/11W-10 S	R09

This number should be referenced in all future communications with the Division concerning your use of water. Please notify the Division of any change in ownership or mailing address

An Annual Notice of Extraction and Diversion of Water (Annual Notice) will be sent to you each year (typically in the spring) for each well to report the amount of water extracted during the previous calendar year. In accordance with the California Water Code, each Annual Notice must be returned to the Division on or before June 30 with the annual filing fee, currently \$115.00, to record your water use. Notices that are received after June 30 will not be recorded. Although there is no penalty for failure to file the Annual Notice, failure to file is considered a nonuse of water for the reporting year.

Should you have questions regarding this matter you can contact me at (916) 322-8465, or Cnease@waterboards.ca.gov.

Sincerely,

Catherine A. Nease
Staff Analyst
Data Management Unit

U:\Herdrv\DMU\GROUNDWATER\deficiency ltrs\First notice co. sanitation dist. 20.doc

SURNAME
DWR 540

Handwritten: B/R 8/13/08

EXHIBIT TO CITY OF LOS ANGELES RESPONSE TO DISCOVERY ORDER
California Environmental Protection Agency

Complete a separate
notice for each well.

State of California
State Water Resources Control Board
DIVISION OF WATER RIGHTS
P.O. Box 2000, Sacramento, CA 95812-2000
Info: (916) 341-5300, FAX: (916) 341-5300, Web: <http://www.waterrights.ca.gov>

Recordation Number 9193514
State Well Number 06N/11W-10 5 (Division of Water Rights Use Only)

**FIRST NOTICE
GROUNDWATER DIVERSION**

(Pursuant to Part 5, Division 2 of the Water Code)

1. Name of person owning the well County Sanitation District No. 20 of Los Angeles County
(Unless otherwise indicated, annual notices will be sent to this name and address)

Address 39300 30th Street East Palmdale, CA 93550
Street address or P.O. Box number City State Zip Code

Telephone Number (562) 908 - 4288 X2801

2. Name of person extracting groundwater (if different than Item 1) _____

Address _____
Street address or P.O. Box number City State Zip Code

Telephone Number () _____ - _____

WELL LOCATION

3. Owner's designation of well R-08 4. County Los Angeles

5. County Assessor's Parcel Number 3025054275

6. Describe location of well to the nearest 40-acre quarter section. State well number (if known) _____

NW
~~Northeast~~ 1/4, of NW
~~Southwest~~ 1/4, Section 10, Township 06N

Range 11W, San Bernardino B. & M.

7. Indicate location of well in the section grid below, or provide a copy of the USGS quadrangle map with the well location marked. The place of use should also be indicated. The grid represents one whole section.

Section 10, Township 06N, Range 11W

Quadrangle map name San Bernardino

X			

POD ID: 52974

N: 34° 37' 51.5"

W: 118° 2' 25.8"

2008 JUL - 8 AM 11:46
DIV OF WATER RIGHTS
SACRAMENTO
STATE WATER RESOURCES
CONTROL BOARD

Rec'd
8/15
7/8/08
MS

WATER USE

8. Describe the Place of Use (If sketch is required, please use grid under item 7) Used to irrigate crops in sections 10, 11, and 14-16 of Township 06N, Range 11W, San Bernardino Meridian.

9. Quantity and Use of water extracted and method used in determining quantity for the last calendar year.

Calendar Year	EXTRACTIONS		USE		
			When use is for irrigation		When use is other than irrigation
	Annual extractions in acre-feet or _____ (specify unit)	Method of measurement or of estimate (specify)	Crops served	Acreage Supplied	Nature and extent of use, i.e. population, products manufactured, number and kind of stock watered
2007	116 AF	Est. w/Flow Meters	Fodder	2,010	

10. Do you also divert surface water? No
Yes or No

11. If answer (to 10 above) is yes, how are you reporting surface water use?

- a. Under Statement of Water Diversion and Use procedures..... ☐
- b. Under Annual Recordation Notice procedures ☐
- c. Under Appropriative Water Right procedures ☐
- d. Not reporting ☐

WELL DATA

12. Is the place of use also served by another well? Yes (see Attachment 1) Another water source? Yes
Yes or No Yes or No

13. If yes to either, describe Six extraction wells supplementing Palmdale Water Reclamation Plant Effluent

14. Type, make and horsepower of pump Submersible, Grundfos, 20Hp Date installed September 19, 2006

15. Pump tests CH2M Hill, August 4, 2006, 150, 75%
Conducted by Date Discharge rate gpm Pump efficiency

16. Power supply Southern California Edison, 3416-032982, August 4, 2006
Source Meter No. Date installed

17. Depth of well 405 feet. 18. Casing diameter Internal Diameter is 8 inches.

19. Is well gravel-packed? Yes 20. Date drilled July 23, 2006
Yes or No

21. What are the upper and lower depths of casing perforations? Upper 321.0 feet Lower 399.7 feet
(Show feet from ground surface)

22. Is log of well available? Yes Where? County Sanitation District of Los Angeles County (CSDLAC)
Yes or No

23. Has a chemical analysis of well water been made? Yes If yes, where can it be obtained? CSDLAC
Yes or No

24. Are water level measurements available? Yes Where? CSDLAC

PLEASE NOTE THAT:

**A willful misstatement in this notice is a misdemeanor pursuant to Section 5008 of the Water Code.
A \$115.00 filing fee must accompany each notice.**

I certify that the foregoing required statements and the following optional additional statements, if any, are true and correct to the best of my knowledge and belief.

Name Raymond L. Tremblay

Signature 

Title Monitoring Section Head Date June 23, 2008

At (City of P.O.) Whittier, CA

Firm or
Corporate Name County Sanitation District No. 20 of Los Angeles County

From: "Ton, Donald" <dtton@lacsds.org>
To: CNEASE@waterboards.ca.gov
Date: 7/17/2008 9:44:40 AM
Subject: Update

Hi Cathy,

I just found out that there were errors on two of the applications we submitted to you in Palmdale. The location description (i.e. northwest 1/4 or the southwest 1/4 section) was incorrect on two of them. Could you update with the first pages of each attached files? Or do I need to send you hard copies to replace?

<<gw_firstnotice R-08.pdf>> <<gw_firstnotice R-09.pdf>>

Thank you,

Donald Ton, P.E.
Monitoring Project Engineer
County Sanitation Districts of Los Angeles County
1955 Workman Mill Road
Whittier, CA 90601
Phone: (562) 699-7411 or (562) 908-4288 Ext. 2810
Fax: (562) 908-4293
email: dtton@lacsds.org

Complete a separate
notice for each well.

State of California
State Water Resources Control Board
DIVISION OF WATER RIGHTS
P.O. Box 2000, Sacramento, CA 95812-2000
Info: (916) 341-5300, FAX: (916) 341-5300, Web: <http://www.waterrights.ca.gov>

Recordation Number
State Well Number
(Division of Water Rights Use Only)

**FIRST NOTICE
GROUNDWATER DIVERSION**

(Pursuant to Part 5, Division 2 of the Water Code)

1. Name of person owning the well _____ County Sanitation District No. 20 of Los Angeles County
(Unless otherwise indicated, annual notices will be sent to this name and address)

Address 39300 30th Street East Palmdale CA 93550
Street address or P.O. Box number City State Zip Code

Telephone Number (562) 908 - 4288 X2801

2. Name of person extracting groundwater (if different than Item 1) _____

Address _____
Street address or P.O. Box number City State Zip Code

Telephone Number () _____ - _____

WELL LOCATION

3. Owner's designation of well R-08 4. County Los Angeles

5. County Assessor's Parcel Number 3025054275

6. Describe location of well to the nearest 40-acre quarter section. State well number (if known) _____

Northwest $\frac{1}{4}$ of Northwest $\frac{1}{4}$, Section 10, Township 06N

Range 11W, San Bernardino B. & M.

7. Indicate location of well in the section grid below, or provide a copy of the USGS quadrangle map with the well location marked. The place of use should also be indicated. The grid represents one whole section.

Section 10, Township 06N, Range 11W

Quadrangle map name San Bernardino

X			

GW-FIRST-EXTRT (03-04)

WATER USE

8. Describe the Place of Use (if sketch is required, please use grid under item 7) Used to irrigate crops in sections 10, 11, and 14-16 of Township 06N, Range 11W, San Bernardino Meridian.

9. Quantity and Use of water extracted and method used in determining quantity for the last calendar year.

Calendar Year	EXTRACTIONS		USE	
	Annual extractions in acre-feet or (specify unit)	Method of measurement or of estimate (specify)	When used for irrigation Crops served Acreage Supplied	When use is other than irrigation Nature and extent of use, i.e. population, products manufactured, number and kind of stock watered
2007	116 AF	Est. w/Flow Meters	Fodder 2,010	

10. Do you also divert surface water? No
Yes or No

11. If answer (to 10 above) is yes, how are you reporting surface water use?

- a. Under Statement of Water Diversion and Use procedures
- b. Under Annual Recordation Notice procedures
- c. Under Appropriative Water Right procedures
- d. Not reporting

WELL DATA

12. Is the place of use also served by another well? Yes (see Attachment 1) Another water source? Yes
Yes or No Yes or No

13. If yes to either, describe Six extraction wells supplementing Palmdale Water Reclamation Plant Effluent

14. Type, make and horsepower of pump Submersible, Grundfos, 20Hp Date installed September 19, 2006

15. Pump tests CH2M Hill August 4, 2006 150 75%
Conducted by Date Discharge rate gpm Pump efficiency

16. Power supply Southern California Edison 3416-032982 August 4, 2006
Source Meter No. Date installed

17. Depth of well 40.5 feet. 18. Casing diameter Internal Diameter is 8 inches

19. Is well gravel-packed? Yes 20. Date drilled July 23, 2006
Yes or No

21. What are the upper and lower depths of casing perforations? Upper 321.0 feet Lower 399.7 feet
(Show feet from ground surface)

22. Is log of well available? Yes Where? County Sanitation District of Los Angeles County (CSDLAC)
Yes or No

23. Has a chemical analysis of well water been made? Yes If yes, where can it be obtained? CSDLAC
Yes or No

24. Are water level measurements available? Yes Where? CSDLAC

PLEASE NOTE THAT:

A willful misstatement in this notice is a misdemeanor pursuant to Section 5008 of the Water Code.

A \$115.00 filing fee must accompany each notice.

I certify that the foregoing required statements and the following optional additional statements, if any, are true and correct to the best of my knowledge and belief.

Name Raymond L. Tremblay

Signature _____

Title Monitoring Section Head Date June 23, 2008

At (City of P.O.) Whittier, CA

Firm or
Corporate Name County Sanitation District No. 20 of Los Angeles County

GW-FIRST-EXTRT (03-04)

PWRP EFFLUENT MANAGEMENT SITE EXTRACTION PIPES & WELLS

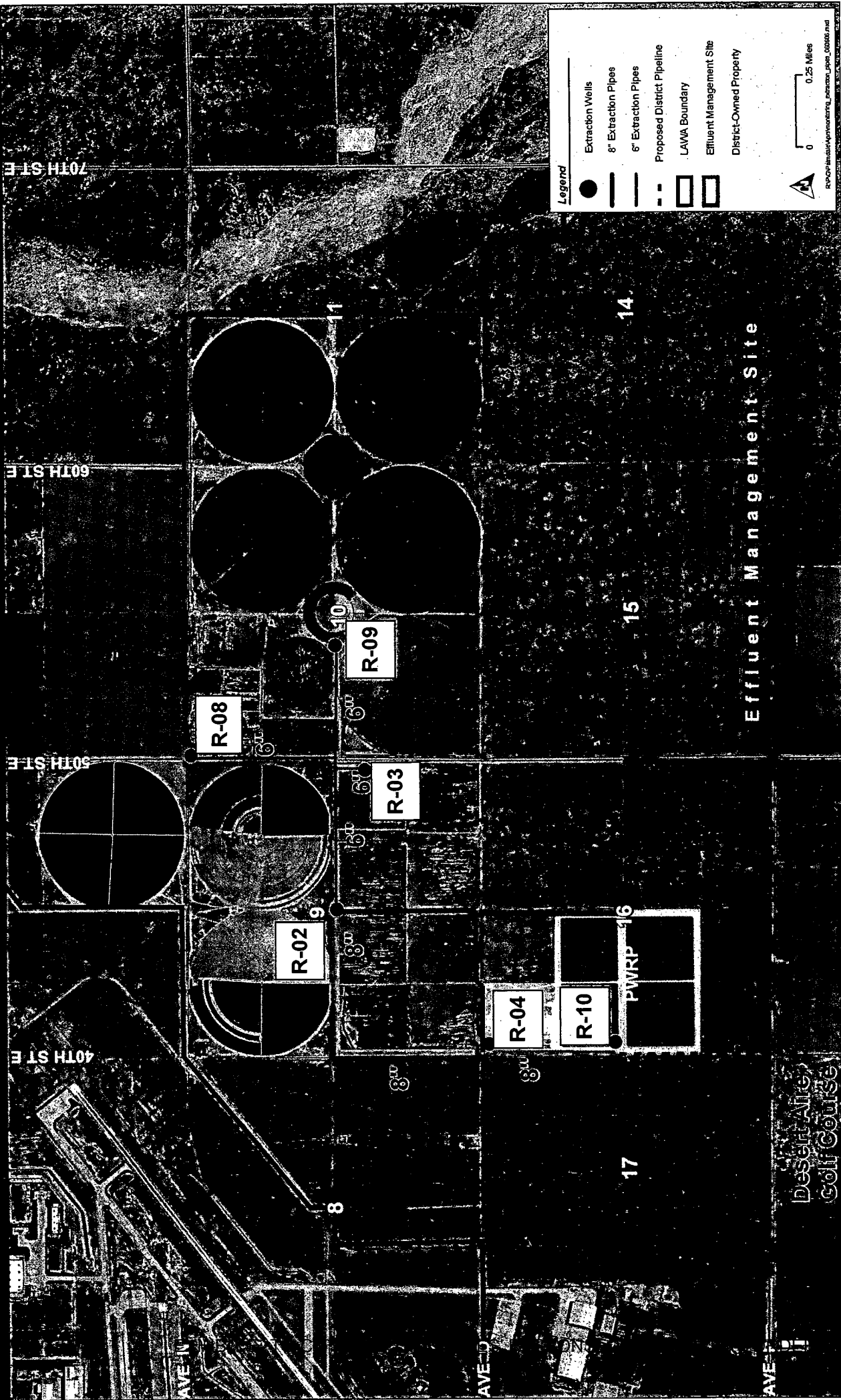

[FINAL SUBMITTED VERSION]**ANNUAL NOTICE OF GROUNDWATER EXTRACTION AND DIVERSION FOR 2011**

Primary Owner: County Sanitation District No. 20 of LA County

Recordation Number: G193515

Date Submitted: 2012-06-11

1. Reporting to a Local Agency	
Local Agency	Submitter does not report to a local agency.

2. Type(s) of Diversion	
a. Groundwater Extraction	> 25 acre-feet
b. Surface Diversion	None

3. Ownership Type of Owner(s) on Record	
Ownership Type	Lessee of land on which well or point of diversion is located, and is extracting/diverting water

4. Amount of Groundwater Extracted During Calendar Year	
Amount Extracted	47 Acre-Feet

5. Amount of Surface Water Diverted or Used	
Not applicable; Surface Diversion was not chosen as a type of diversion.	

5d. Maximum Rate of Surface Water Diversion	
Not applicable; Surface Diversion was not chosen as a type of diversion.	

6. Method of Measurement	
Method of Measurement	Water Meter

7. Type(s) of Use	
Irrigation	2010 Acres Mixed Crop Types

8. Action Requested	
Action Requested	Record my water use

9. Supplemental Information	
Supplemental Information	A total of 603 AFY of groundwater and 8828 AFY of recycled water are used at wells G193512-G193515.

Attachments		
File Name	Description	Size
No Attachments		

Contact Information of the Person Submitting the Form	
First Name	Ann
Last Name	Heil
Relation to Water Right	

EXHIBIT E- TO CITY OF LOS ANGELES' RESPONSE TO DISCOVERY ORDER

I read the above and agree

Yes

[FINAL SUBMITTED VERSION]**ANNUAL NOTICE OF GROUNDWATER EXTRACTION AND DIVERSION FOR 2010**

Primary Owner: County Sanitation District No. 20 of LA County

Recordation Number: G193515

Date Submitted: 2011-06-28

Reporting to a Local Agency	
Local Agency	Submitter does not report to a local agency.

Type(s) of Diversion	
Groundwater Extraction	> 25 acre-feet
Surface Diversion	None

Ownership Type of Owner(s) on Record	
Ownership Type	Lessee of land on which well or point of diversion is located, and is extracting/diverting water

Amount of Groundwater Extracted During Calendar Year	
Amount Extracted	59 Acre-Feet

Amount of Surface Water Diverted or Used	
Not applicable; Surface Diversion was not chosen as a type of diversion.	

Maximum Rate of Surface Water Diversion	
Not applicable; Surface Diversion was not chosen as a type of diversion.	

Method of Measurement	
Method of Measurement	Water Meter

Purpose(s) of Use	
Irrigation	2010 Acres Mixed Crop Types

Action Requested	
Action Requested	Record my water use

Supplemental Information	
Supplemental Information	A total of 570 AFY of groundwater and 6917 AFY of recycled water are used at wells G193512-G193515.

Attachments	
File Name	Size
No Attachments	

Contact Information of the Person Submitting the Form	
First Name	Tom
Last Name	Weiland
I read the above and agree	Yes



EXHIBIT E- TO CITY OF LOS ANGELES' RESPONSE TO DISCOVERY ORDER

G193515



G193515

Complete a separate
notice for each well.

State of California
State Water Resources Control Board
DIVISION OF WATER RIGHTS
P.O. Box 2000, Sacramento, CA 95812-2000
Info: (916) 341-5300, FAX: (916) 341-5300, Web: <http://www.waterrights.ca.gov>

Recordation Number G193515
State Well Number 06N11W-10 S
(Division of Water Rights Use Only)

**FIRST NOTICE
GROUNDWATER DIVERSION**

(Pursuant to Part 5, Division 2 of the Water Code)

1. Name of person owning the well County Sanitation District No. 20 of Los Angeles County
(Unless otherwise indicated, annual notices will be sent to this name and address)

Address 39300 30th Street East Palmdale, CA 93550
Street address or P.O. Box number City State Zip Code

Telephone Number (562) 908 - 4288 X2801

2. Name of person extracting groundwater (if different than Item 1) _____

Address _____
Street address or P.O. Box number City State Zip Code

Telephone Number () _____ - _____

WELL LOCATION

3. Owner's designation of well R-09 4. County Los Angeles

5. County Assessor's Parcel Number 3025054275

6. Describe location of well to the nearest 40-acre quarter section. State well number (if known) _____

SE NW
Northeast $\frac{1}{4}$, of Southwest $\frac{1}{4}$, Section 10, Township 06N
Range 11W, San Bernardino B. & M.

7. Indicate location of well in the section grid below, or provide a copy of the USGS quadrangle map with the well location marked. The place of use should also be indicated. The grid represents one whole section.

Section 10, Township 06N, Range 11W

Quadrangle map name San Bernardino

		X	

PD ID: 529174

N $34^{\circ} 37' 26''$
W $118^{\circ} 2' 3.9''$

STATE WATER RESOURCES
CONTROL BOARD
2008 JUL - 8 AM 11:54
DIV. OF WATER RIGHTS
SACRAMENTO

Rec'd
5/15/08
1/6/08
CM

WATER USE

8. Describe the Place of Use (If sketch is required, please use grid under item 7) Used to irrigate crops in sections 10, 11, and 14-16 of Township 06N, Range 11W, San Bernardino Meridian.

9. Quantity and Use of water extracted and method used in determining quantity for the last calendar year.

Calendar Year	EXTRACTIONS		USE		
			When use is for irrigation		When use is other than irrigation
	Annual extractions in acre-feet or _____ (specify unit)	Method of measurement or of estimate or of estimate (specify)	Crops served	Acreage Supplied	Nature and extent of use, i.e. population, products manufactured, number and kind of stock watered
2007	41 AF	Est. w/Flow Meters	Fodder	2,010	

10. Do you also divert surface water? No
Yes or No

11. If answer (to 10 above) is yes, how are you reporting surface water use?

- a. Under Statement of Water Diversion and Use procedures..... ☐
- b. Under Annual Recordation Notice procedures ☐
- c. Under Appropriative Water Right procedures ☐
- d. Not reporting..... ☐

WELL DATA

12. Is the place of use also served by another well? Yes (see Attachment 1) Another water source? Yes
Yes or No Yes or No

13. If yes to either, describe Six extraction wells supplementing Palmdale Water Reclamation Plant Effluent

14. Type, make and horsepower of pump Submersible, Grundfos, 7.5Hp Date installed September 19, 2006

15. Pump tests CH2M Hill, August 4, 2006, 40, 75%
Conducted by Date Discharge rate gpm Pump efficiency

16. Power supply Southern California Edison, 349-013354, August 4, 2006
Source Meter No. Date installed

17. Depth of well 370 feet. 18. Casing diameter Internal Diameter is 5 inches.

19. Is well gravel-packed? Yes 20. Date drilled August 17, 2006
Yes or No

21. What are the upper and lower depths of casing perforations? Upper 316.3 feet Lower 365.3 feet
(Show feet from ground surface)

22. Is log of well available? Yes Where? County Sanitation District of Los Angeles County (CSDLAC)
Yes or No

23. Has a chemical analysis of well water been made? Yes If yes, where can it be obtained? CSDLAC
Yes or No

24. Are water level measurements available? Yes Where? CSDLAC

PLEASE NOTE THAT:

A willful misstatement in this notice is a misdemeanor pursuant to Section 5008 of the Water Code.
A \$115.00 filing fee must accompany each notice.

I certify that the foregoing required statements and the following optional additional statements, if any, are true and correct to the best of my knowledge and belief.

Name Raymond J. Tremblay

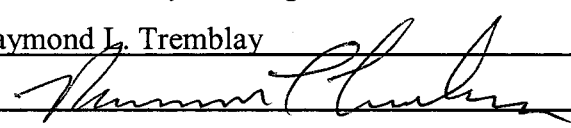
Signature 

Title Monitoring Section Head Date June 23, 2008

At (City of P.O.) Whittier, CA

Firm or
Corporate Name County Sanitation District No. 20 of Los Angeles County

Complete a separate
notice for each well.

State of California
State Water Resources Control Board
DIVISION OF WATER RIGHTS
P.O. Box 2000, Sacramento, CA 95812-2000
Info: (916) 341-5300, FAX: (916) 341-5300, Web: <http://www.waterrights.ca.gov>

Recordation Number
State Well Number
(Division of Water Rights Use Only)

**FIRST NOTICE
GROUNDWATER DIVERSION**

(Pursuant to Part 5, Division 2 of the Water Code)

1. Name of person owning the well County Sanitation District No. 20 of Los Angeles County
(Unless otherwise indicated, annual notices will be sent to this name and address)

Address 39300 30th Street East Palmdale CA 93550
Street address or P.O. Box number City State Zip Code

Telephone Number (562) 908 - 4288 X2801

2. Name of person extracting groundwater (if different than Item 1) _____

Address _____
Street address or P.O. Box number City State Zip Code

Telephone Number () _____

WELL LOCATION

3. Owner's designation of well R-09 4. County Los Angeles

5. County Assessor's Parcel Number 3025054275

6. Describe location of well to the nearest 40-acre quarter section. State well number (if known) _____

South east $\frac{1}{4}$ of North west $\frac{1}{4}$, Section 10, Township 06N

Range 11W, San Bernardino B. & M.

7. Indicate location of well in the section grid below, or provide a copy of the USGS quadrangle map with the well location marked. The place of use should also be indicated. The grid represents one whole section.

Section 10, Township 06N, Range 11W

Quadrangle map name San Bernardino

	X		

GW-FIRST-EXTRT (03-04)

WATER USE

8. Describe the Place of Use (If sketch is required, please use grid under item 7) Used to irrigate crops in sections 10, 11, and 14-16 of Township 06N, Range 11W, San Bernardino Meridian.

9. Quantity and Use of water extracted and method used in determining quantity for the last calendar year.

Calendar Year	EXTRACTIONS		USE	
	Annual extractions in acre-feet or (specify unit)	Method of measurement or of estimate (specify)	When use is for irrigation Crops served Acreage Supplied	When use is other than irrigation Nature and extent of use, i.e. population, products manufactured, number and kind of stock watered
2007	41 AF	Est. w/Flow Meters	Fodder	2,010

10. Do you also divert surface water? No
Yes or No

11. If answer (to 10 above) is yes, how are you reporting surface water use?

- a. Under Statement of Water Diversion and Use procedures.....
- b. Under Annual Recordation Notice procedures.....
- c. Under Appropriative Water Right procedures.....
- d. Not reporting.....

WELL DATA

12. Is the place of use also served by another well? Yes (see Attachment 1) Another water source? Yes
Yes or No Yes or No

13. If yes to either, describe Six extraction wells supplementing Palmdale Water Reclamation Plant Effluent

14. Type, make and horsepower of pump Submersible, Grundfos, 7.5Hp Date installed September 19, 2006

15. Pump tests CH2M Hill August 4, 2006 40 75%
Conducted by Date Discharge rate gpm Pump efficiency

16. Power supply Southern California Edison 349-013354 August 4, 2006
Source Meter No. Date installed

17. Depth of well 370 feet. 18. Casing diameter Internal Diameter is 5 inches

19. Is well gravel-packed? Yes 20. Date drilled August 17, 2006
Yes or No

21. What are the upper and lower depths of casing perforations? Upper 316.3 feet Lower 365.3 feet
(Show feet from ground surface)

22. Is log of well available? Yes Where? County Sanitation District of Los Angeles County (CSDLAC)
Yes or No

23. Has a chemical analysis of well water been made? Yes If yes, where can it be obtained? CSDLAC
Yes or No

24. Are water level measurements available? Yes Where? CSDLAC

PLEASE NOTE THAT:

A willful misstatement in this notice is a misdemeanor pursuant to Section 5008 of the Water Code.

A \$115.00 filing fee must accompany each notice.

I certify that the foregoing required statements and the following optional additional statements, if any, are true and correct to the best of my knowledge and belief.

Name Raymond L. Tremblay

Signature _____

Title Monitoring Section Head Date June 23, 2008

At (City of P.O.) Whittier, CA

Firm or
Corporate Name County Sanitation District No. 20 of Los Angeles County

GW-FIRST-EXTRT (03-04)

PWRP EFFLUENT MANAGEMENT SITE EXTRACTION PIPES & WELLS

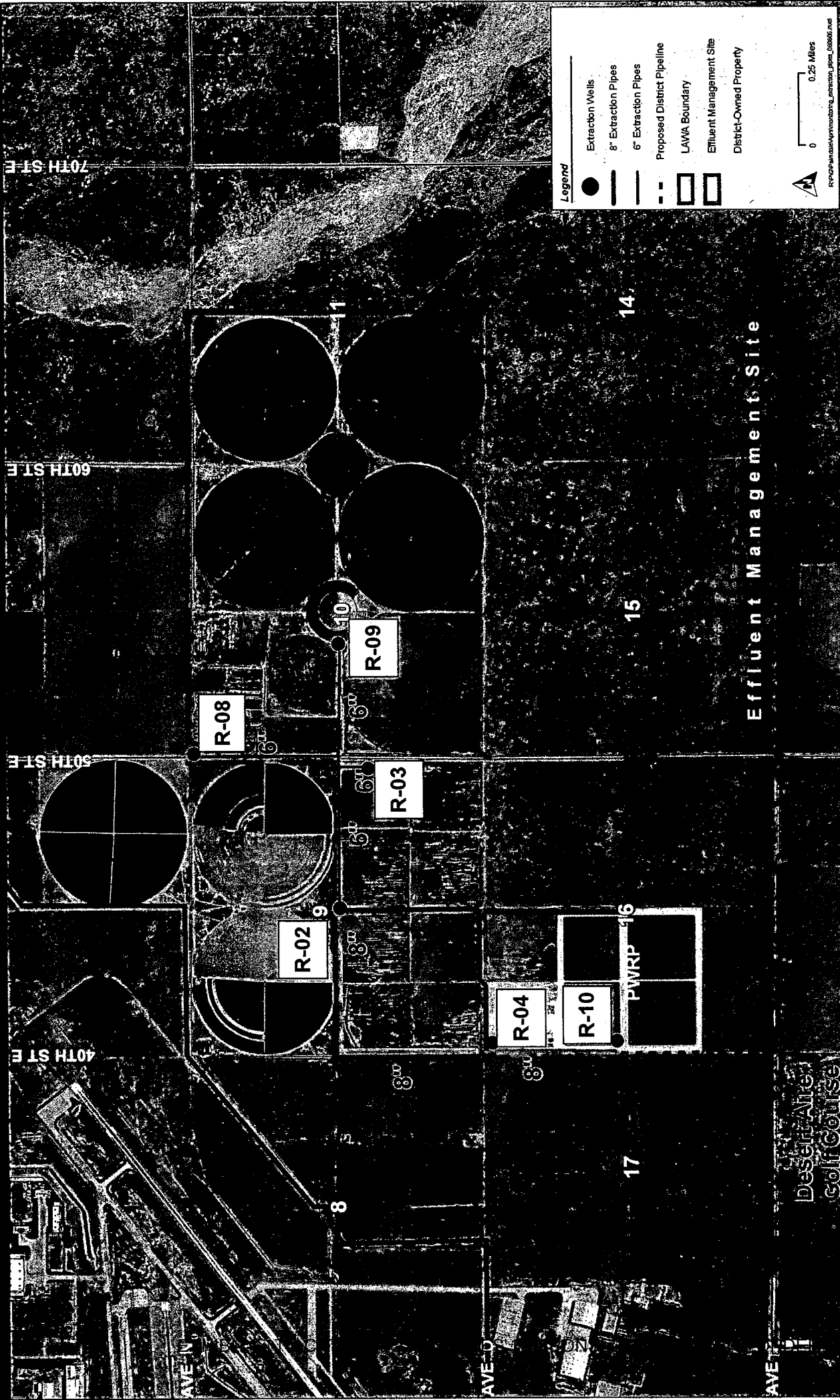

PLEASE COMPLETE. SUBMIT THE ORIGINAL AND MAKE A COPY FOR YOUR RECORDS

State of California, State Water Resources Control Board, Division of Water Rights
P.O. BOX 2000, SACRAMENTO, CA 95812-2000

Info: (916) 341-5300, FAX: (916) 341-5400, Web: <http://www.waterrights.ca.gov>

STATE WATER RESOURCES
CONTROL BOARD

G193515

2008

2009 JUN 24 AM 11:40

ANNUAL NOTICE OF GROUNDWATER EXTRACTION AND DIVERSION
(GROUNDWATER RECORDATION PROGRAM)

If the owner information below is wrong or missing, please correct.

OWNER(S) OF RECORD COUNTY SANITATION DISTRICT NO. 20 OF LA COUNTY

PRIMARY CONTACT OR AGENT FOR MAIL & REPORTING:

COUNTY SANITATION DISTRICT NO. 20 OF LA COUNTY
39300 30TH STREET EAST
PALMDALE, CA 93550

DIV OF WATER RIGHTS
SACRAMENTO

RECORDATION NO: G193515
CONTACT PHONE NO: (562) 908-4288

Owner's Designation of Well
R09

State Well Number
06N/11W-10 S

Parcel Number
3025054275

DEADLINE: Notices must be received no later than **June 30, 2009** in order to be recorded.

REQUIRED FEES: A filing fee of \$115.00 is required for each Annual Notice of Groundwater Extraction and Diversion. Check or money order should indicate your recordation number(s) and be made payable to: State Water Resources Control Board. Do not send cash.

PLEASE READ THE GENERAL INFORMATION ON THE REVERSE SIDE BEFORE COMPLETING THIS NOTICE

If the above information is inaccurate, please line it out in red and provide current information. Notify this office if ownership or address changes occur during the coming year.

1. **TYPE OF DIVERSION** ☒ Groundwater extraction or ☐ Surface diversion

2. **OWNERSHIP. Person listed below is:**

- ☒ Owner of land on which well or point of diversion is located, and is extracting/diverting water.
☐ Lessee of land on which well or point of diversion is located, and is extracting/diverting water.
☐ Owner of land, but lessee is extracting/diverting water.
☐ Other: Please explain: _____

50.5	<input checked="" type="checkbox"/> acre-feet
	<input type="checkbox"/> cubic-feet
(Must be a specific number) <input type="checkbox"/> gallons	

3. **AMOUNT OF GROUNDWATER EXTRACTED DURING CALENDAR YEAR** _____ →

4. **AMOUNT OF SURFACE WATER DIVERTED DURING CALENDAR YEAR** _____ →

5. **METHOD OF MEASUREMENT** ☒ Water Meter ☐ Power Meter ☐ Non-metered or Estimated

6. **TYPE OF WATER USE** ☒ Agricultural ☐ Domestic or Municipal ☐ Other: _____

7. **ACTION REQUESTED (Check one):**

- ☐ Reopen file. (Fee required)
☐ Close this file. (No fee required)
☒ Record my water use. (Fee required)
☐ Do not record my water use but keep my name on mailing list. (No fee required)

Annual quantity	0	<input type="checkbox"/> acre-feet
Season of diversion		<input type="checkbox"/> cubic-feet
Begin		<input type="checkbox"/> gallons
End		
Maximum rate of diversion		

Transfer this file to: _____

Company Name: _____ (NEW OWNER'S FIRST NAME) (M. NAME) (LAST NAME)

Address: _____ (MAILING ADDRESS) (CITY) (STATE) (ZIP CODE)

Telephone: () _____ Effective Date: _____

8. **SUPPLEMENTAL INFORMATION.** Please list any changes in your project since last year (new pump, new land irrigation, new method of irrigation, etc.) or any other comments.

9. **CERTIFICATION AND SIGNATURE:** I certify that the forgoing statements are true and correct to the best of my knowledge.

Signature: Thomas G. Weiland Date: 6/20/09

Printed Name: Thomas E. Weiland
(FIRST NAME) (M. NAME) (LAST NAME)

COMPANY NAME: _____ THIS SPACE FOR OFFICE USE ONLY R. 2754 AMT: \$115.00

GENERAL INFORMATION

The dependence on groundwater in the Counties of Riverside, San Bernardino, Los Angeles, and Ventura has resulted in diminishing water supplies. As water becomes more scarce, determination of your water rights by the courts may become necessary. Your Annual Notice of Groundwater Extraction and Diversion is required to establish a record of water use which can assist the court in determining your rights.

The California Water Code requires you to record your annual surface and groundwater use if your total groundwater extractions from all wells exceed 25 acre-feet. Extractions of less than 10 acre-feet from a single well need not be reported. Although there is no penalty for failure to file the annual notice, failure to file is considered nonuse of water. Therefore, persons who do not file notices may have difficulty in supporting a claim of water use during a lawsuit to establish ownership of groundwater rights.

Exceptions: (1) If you are currently reporting your pumpage to a watermaster, your water use is already on record, and you are exempt from the requirement of filing a notice, or (2) if annual water use is less than the required amounts, filing is optional because these minimal amounts would probably not be affected by a water right dispute. All optional notices that are accompanied by appropriate fees will be recorded.

Should you require additional information about the Water Code requirements or assistance in completing this form, please write to the address on the top of this form, or telephone (916) 341-5300.

TABLE 1: AGRICULTURAL WATER USE WORKSHEET (Optional)

To estimate your use of water, indicate below the crop type and number of acres. Then find the average irrigation requirement for each crop using Table II. Multiply acres (column 1) to applied water depth (column 2) to determine the amount pumped (column 3). Then total all amounts in column 3 to determine total irrigation use.

CROP	COLUMN 1	COLUMN 2	COLUMN 3
	ACRES	AVERAGE APPLIED WATER DEPTH (acre-feet per acre)	AMOUNT PUMPED (acre-feet) (column 1 X column 2)
CONVERSION FACTORS One acre-foot (af) = 43,560 cubic feet = 325,900 gallons One miner's inch is approximately 9 gallons per minute. An acre-foot covers one acre of land, one foot deep			TOTAL IRRIGATION USE

TABLE II: AVERAGE DEPTH OF WATER APPLIED TO IRRIGATE EACH CROP (acre-feet per acre)¹

LOCALITY ²	ALFALFA	AVOCADOS	BEANS	DATES	LEMONS	LETTUCE	PERMANENT PASTURE	TOMATOES
1. Los Angeles County								
a. Coastal Basin		2.0 - 2.5			2.0 - 2.5	2.0 - 2.5		
b. Antelope Valley	7.6						7.4	
2. Eastern Riverside County								
a. Coachella & Blythe Area	9.0 - 10.0			7.9 - 9.0	5.5 - 6.0	3.6 - 4.2	9.0 - 10.0	4.3 - 6.4
3. Western Riverside County	4.0 - 4.5	2.5 - 3.0			2.5 - 3.0	2.0 - 2.5	4.5 - 5.0	
4. San Bernardino County								
a. Chino Area	4.0 - 4.5	2.5 - 3.0			2.5 - 3.0	2.0 - 2.5	4.5 - 5.0	2.3 - 2.5
b. San Bernardino Area	4.0 - 4.5	2.5 - 3.0			2.5 - 3.0	2.0 - 2.5	4.0 - 5.0	2.3 - 2.5
c. Barstow-Apple Valley	6.0 - 6.5						6.0 - 6.5	
d. Ontario	4.0 - 4.5	2.5 - 3.0			2.5 - 3.0		4.0 - 5.0	2.3 - 2.5
e. Highlands-Redlands	4.0 - 4.5	2.5 - 3.0			2.5 - 3.0		4.0 - 5.0	2.3 - 2.5
5. Ventura County	4.0 - 4.5	2.3 - 2.5	1.3 - 1.5		2.3 - 2.5	2.0 - 2.5	4.0 - 4.5	2.0 - 2.5

¹ Based on information provided by Agricultural Extension Service of the University of California.

Updated: Department of Water Resources, Southern District // Backup data for the California Water Plan, Bulletin 160-98. Date August 21, 2000

² Unit use values for crops grown in each region.



State Water Resources Control Board



Linda S. Adams

Secretary for

Environmental Protection

Division of Water Rights

1001 I Street, 14th Floor ♦ Sacramento, California 95814 ♦ 916.341.5300

P.O. Box 2000 ♦ Sacramento, California 95812-2000

Fax: 916.341.5400 ♦ www.waterrights.ca.gov

Arnold Schwarzenegger

Governor

August 13, 2008

COUNTY SANITATION DISTRICT NO. 20 OF LA
COUNTY
39300 30TH STREET EAST
PALMDALE, CA 93550

In Reply Refer to:
300:CN: G193512

FIRST NOTICE GROUNDWATER DIVERSION, GROUNDWATER RECORDATION PROGRAM IN LOS ANGELES COUNTY

The State Water Resources Control Board, Division of Water Rights (Division), received your First Notice Groundwater Diversion form(s) on July 8, 2008. Groundwater Recordation number(s) have been assigned to the State Well Number(s) listed below.

<u>Recordation Number</u>	<u>State Well Number</u>	<u>Owner's Well Designation</u>
G193512	06N/11W-09 S	R02
G193513	06N/11W-09 S	R03
G193514	06N/11W-10 S	R08
G193515	06N/11W-10 S	R09

This number should be referenced in all future communications with the Division concerning your use of water. Please notify the Division of any change in ownership or mailing address

An Annual Notice of Extraction and Diversion of Water (Annual Notice) will be sent to you each year (typically in the spring) for each well to report the amount of water extracted during the previous calendar year. In accordance with the California Water Code, each Annual Notice must be returned to the Division on or before June 30 with the annual filing fee, currently \$115.00, to record your water use. Notices that are received after June 30 will not be recorded. Although there is no penalty for failure to file the Annual Notice, failure to file is considered a nonuse of water for the reporting year.

Should you have questions regarding this matter you can contact me at (916) 322-8465, or Cnease@waterboards.ca.gov.

Sincerely,

Catherine A. Nease
Staff Analyst
Data Management Unit

U:\Herdv\DMU\GROUNDWATER\deficiency ltrs\First notice co. sanitation dist. 20.doc

SURNAME
DWR 540

EXHIBIT TO CITY OF LOS ANGELES RESPONSE TO DISCOVERY ORDER

California Environmental Protection Agency

[FINAL SUBMITTED VERSION]**ANNUAL NOTICE OF GROUNDWATER EXTRACTION AND DIVERSION FOR 2011**

Primary Owner: LOS ANGELES WORLD AIRPORTS (PALMDALE) ENVIRONMENTAL SERVICES
DIVISION

Recordation Number: G193568

Date Submitted: 2012-03-23

1. Reporting to a Local Agency	
Local Agency	Submitter does not report to a local agency.

2. Type(s) of Diversion	
a. Groundwater Extraction	> 25 acre-feet
b. Surface Diversion	None

3. Ownership Type of Owner(s) on Record	
Ownership Type	Owner of land, but lessee is extracting/diverting water

4. Amount of Groundwater Extracted During Calendar Year	
Amount Extracted	1400 Acre-Feet

5. Amount of Surface Water Diverted or Used	
Not applicable; Surface Diversion was not chosen as a type of diversion.	

5d. Maximum Rate of Surface Water Diversion	
Not applicable; Surface Diversion was not chosen as a type of diversion.	

6. Method of Measurement	
Method of Measurement	Power Meter

7. Type(s) of Use	
Irrigation	306 Acres Sod (lawn grass)

8. Action Requested	
Action Requested	Record my water use

9. Supplemental Information	
Supplemental Information	

Attachments		
File Name	Description	Size
No Attachments		

Contact Information of the Person Submitting the Form	
First Name	Howard
Last Name	Alger
Relation to Water Right	Authorized Official
I read the above and	

EXHIBIT E- TO CITY OF LOS ANGELES' RESPONSE TO DISCOVERY ORDER

agree

Yes

[FINAL SUBMITTED VERSION]**ANNUAL NOTICE OF GROUNDWATER EXTRACTION AND DIVERSION FOR 2010**

Primary Owner: LOS ANGELES WORLD AIRPORTS (PALMDALE) ENVIRONMENTAL SERVICES
DIVISION

Recordation Number: G193568

Date Submitted: 2011-04-05

Reporting to a Local Agency	
Local Agency	Submitter does not report to a local agency.

Type(s) of Diversion	
Groundwater Extraction	> 25 acre-feet
Surface Diversion	None

Ownership Type of Owner(s) on Record	
Ownership Type	Owner of land, but lessee is extracting/diverting water

Amount of Groundwater Extracted During Calendar Year	
Amount Extracted	1394 Acre-Feet

Amount of Surface Water Diverted or Used	
Not applicable; Surface Diversion was not chosen as a type of diversion.	

Maximum Rate of Surface Water Diversion	
Not applicable; Surface Diversion was not chosen as a type of diversion.	

Method of Measurement	
Method of Measurement	Non-metered or Estimated

Purpose(s) of Use	
Irrigation	306 Acres Sod (lawn grass)

Action Requested	
Action Requested	Record my water use

Supplemental Information	
Supplemental Information	

Attachments	
File Name	Size
No Attachments	

Contact Information of the Person Submitting the Form	
First Name	Howard
Last Name	Alger
I read the above and agree	Yes 

[FINAL SUBMITTED VERSION]**ANNUAL NOTICE OF GROUNDWATER EXTRACTION AND DIVERSION FOR 2009**

Primary Owner: LOS ANGELES WORLD AIRPORTS (PALMDALE) ENVIRONMENTAL SERVICES
DIVISION

Recordation Number: G193568

Date Submitted: 2012-03-23

1. Reporting to a Local Agency	
Local Agency	Submitter does not report to a local agency.

2. Type(s) of Diversion	
a. Groundwater Extraction	> 25 acre-feet
b. Surface Diversion	None

3. Ownership Type of Owner(s) on Record	
Ownership Type	Owner of land, but lessee is extracting/diverting water

4. Amount of Groundwater Extracted During Calendar Year	
Amount Extracted	959 Acre-Feet

5. Amount of Surface Water Diverted or Used	
Not applicable; Surface Diversion was not chosen as a type of diversion.	

5d. Maximum Rate of Surface Water Diversion	
Not applicable; Surface Diversion was not chosen as a type of diversion.	

6. Method of Measurement	
Method of Measurement	Power Meter

7. Type(s) of Use	
Irrigation	306 Acres Sod (lawn grass)

8. Action Requested	
Action Requested	Record my water use

9. Supplemental Information	
Supplemental Information	

Attachments		
File Name	Description	Size
No Attachments		

Contact Information of the Person Submitting the Form	
First Name	Howard
Last Name	Alger
Relation to Water Right	Authorized Official
I read the above and	EXHIBIT E- TO CITY OF LOS ANGELES' RESPONSE TO DISCOVERY ORDER

agree	Yes
-------	-----

[FINAL SUBMITTED VERSION]

ANNUAL NOTICE OF GROUNDWATER EXTRACTION AND DIVERSION FOR 2010

Primary Owner: L A WORLD AIRPORT

Recordation Number: G363659

Date Submitted: 2011-04-05

Reporting to a Local Agency	
Local Agency	Submitter does not report to a local agency.

Type(s) of Diversion	
Groundwater Extraction	None
Surface Diversion	None

Ownership Type of Owner(s) on Record	
Ownership Type	Other - Owner of Land, Domestic well not used for years.

Amount of Groundwater Extracted During Calendar Year	
Not applicable; Groundwater Extraction was not chosen as a type of diversion.	

Amount of Surface Water Diverted or Used	
Not applicable; Surface Diversion was not chosen as a type of diversion.	

Maximum Rate of Surface Water Diversion	
Not applicable; Surface Diversion was not chosen as a type of diversion.	

Method of Measurement	
Method of Measurement	

Purpose(s) of Use	
No purposes selected.	

Action Requested	
Action Requested	Do not record my water use, but keep my name on the mailing list

Supplemental Information	
Supplemental Information	

Attachments	
File Name	Size
No Attachments	

Contact Information of the Person Submitting the Form	
First Name	Howard
Last Name	Alger
I read the above and agree	Yes

