

Attachment D

USGS Topographic Map of Little Buttes 7.5-minute Quadrangle

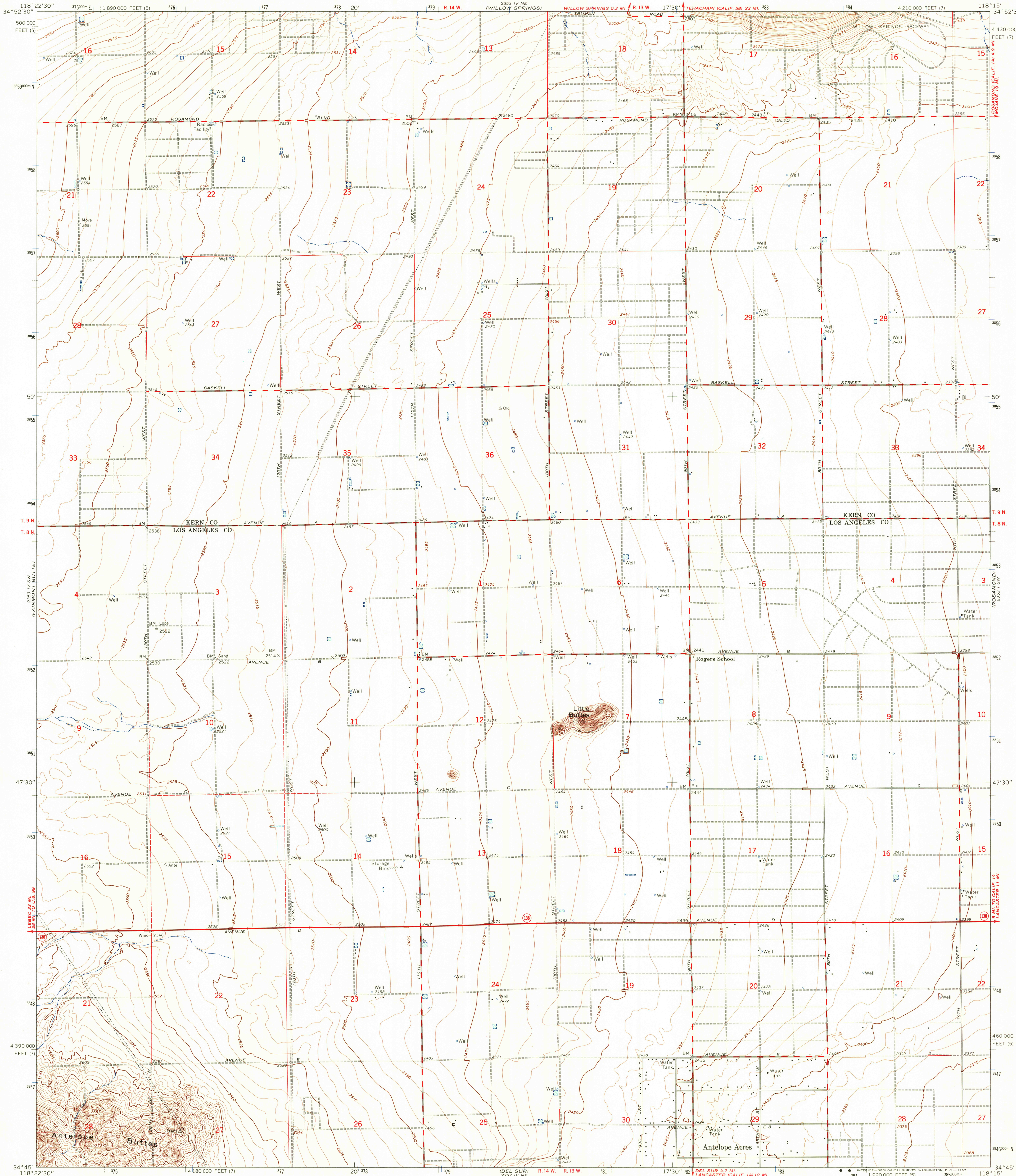

Mapped, edited, and published by the Geological Survey
Control by USGS and USC&GS
Topography by photogrammetric methods from aerial
photographs taken 1963. Field checked 1965
Polyconic projection. 1927 North American datum
10,000-foot grids based on California coordinate system,
zones 7 and 5
1,000-meter Universal Transverse Mercator grid ticks,
zone 11, shown in blue
Supersedes portions of Little Buttes and Esperanza School
6-minute maps dated 1950
Fine red dashed lines indicate selected fence lines

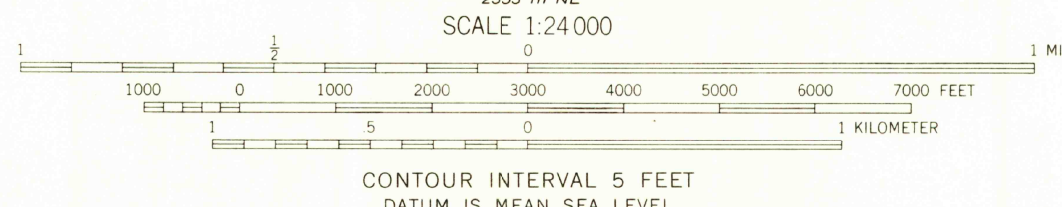
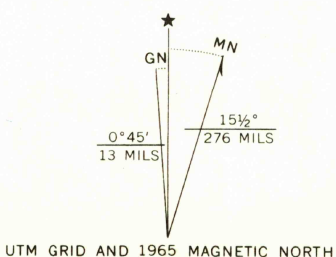

THIS MAP COMPLIES WITH NATIONAL MAP ACCURACY STANDARDS
FOR SALE BY U. S. GEOLOGICAL SURVEY, DENVER, COLORADO 80225, OR WASHINGTON, D. C. 20242
A FOLDER DESCRIBING TOPOGRAPHIC MAPS AND SYMBOLS IS AVAILABLE ON REQUEST

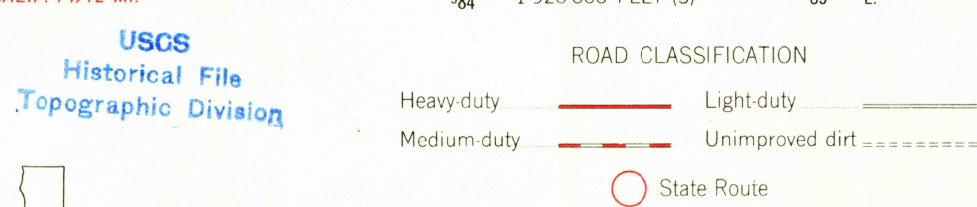

USGS
TOPOGRAPHIC DIVISION

LITTLE BUTTES, CALIF.
SE/4 WILLOW SPRINGS 15' QUADRANGLE
N3445-W11815/7.5
1965

AMS 2353 IV SE-SERIES V895

MAR 28 1967